

ORDINANCE NO. 2014 - 64

**AMENDING THE ZONING CODE AND ZONING MAP OF THE CITY OF MASON OHIO TO PROVIDE FOR THE REZONING OF APPROXIMATELY 0.6 ACRES FROM R-1 SINGLE FAMILY TO R-4 SINGLE FAMILY (608 CHURCH STREET)**

WHEREAS, the Planning Commission has reviewed a request to amend the Zoning Code and Zoning Map of the City of Mason to provide for the rezoning of approximately 0.6 acres from R-1 to R-4; and

WHEREAS, the Planning Commission has recommended approval of the rezoning; and

WHEREAS, a Public Hearing was held pursuant to the requirements of the Zoning Code.

NOW, THEREFORE, BE IT ORDAINED by the Council of the City of Mason, Ohio, six members elected thereto concurring:

Section 1. That the Zoning Code and Zoning Map of the City of Mason, Ohio, are hereby amended to provide for the rezoning of approximately 0.6 acres to R-4. Said property is located at 608 Church Street, west of the intersection of Church Street and Mason Road.

Section 2. That the tract of land proposed for rezoning is more particularly described in the attached Exhibit "A" which is incorporated herein by reference.

Section 3. That this Ordinance shall take effect and be in force from and after the earliest period allowed by law.

Passed this 22<sup>nd</sup> day of September, 2014.

  
\_\_\_\_\_  
Mayor

Attest:

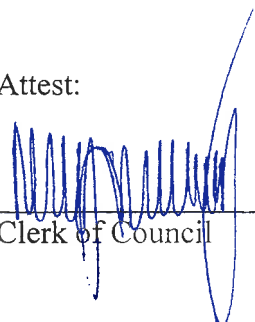
  
\_\_\_\_\_  
Clerk of Council

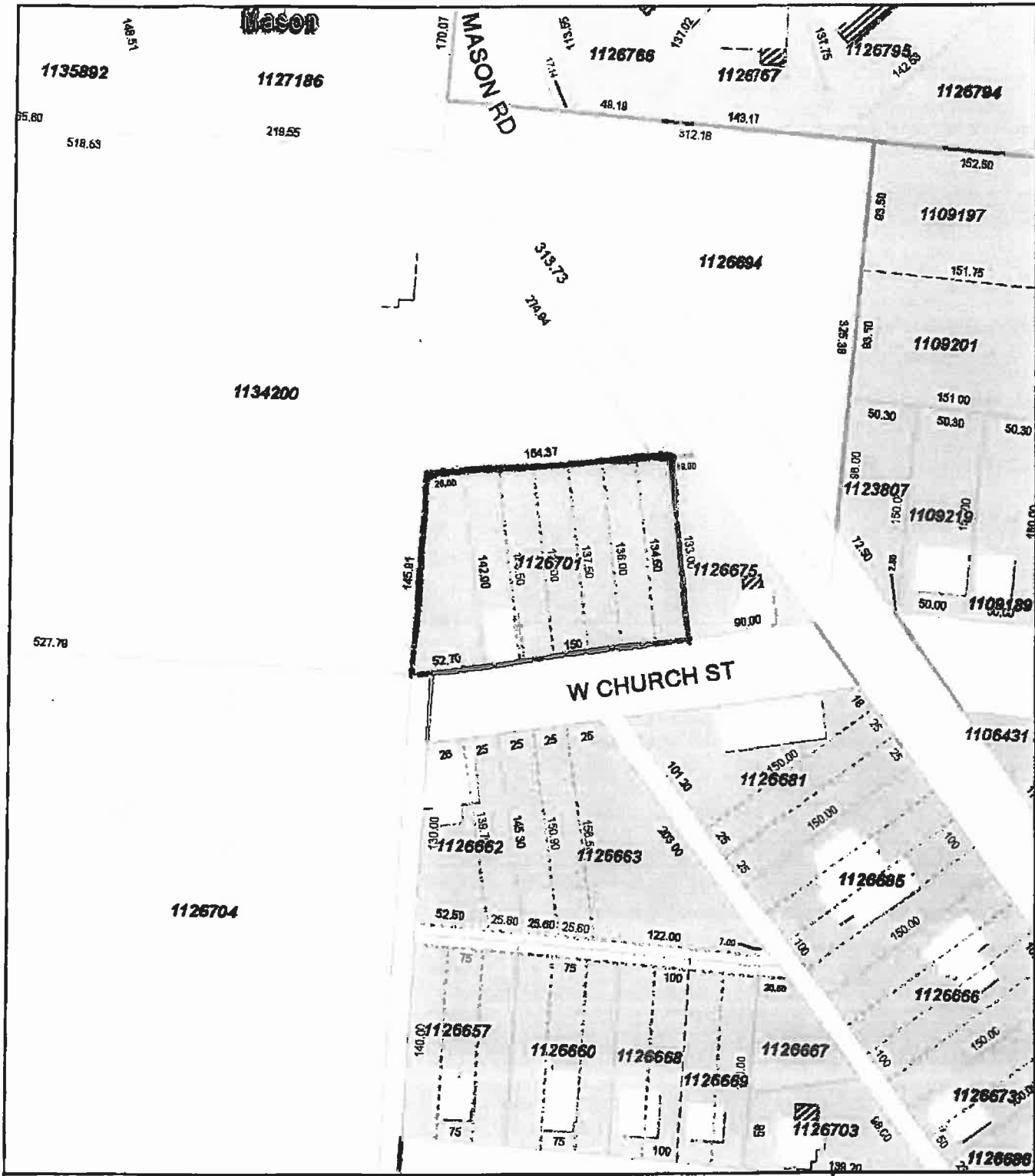

*Warren County Legend*

	Interstate		County Boundary		Overpass Line		School Line		Township & Range
	US Route		Auditors Tract Line		Parcel Line		Section Line		Tract Line
	State Route		Civil Township Line		ROW Unknown Width		Subdivision Limit		VMS Line
	Local Road		Corporate Line		Road ROW		Subdivision Lot Line		Vacated Road Line

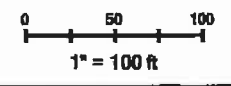

This is a product of the Warren County GIS Department. The data depicted here has been developed with extensive cooperation from other county departments, as well as other federal, state, and local government agencies. Warren County expressly disclaims responsibility for damages or liability that may arise from the use of this map. Any reuse of this information is prohibited, except in accordance with a licensing agreement. Copyright 2009 Warren County GIS. Generated: 7/9/2014 12:01:27 PM