



TRAFFIC CRASH REPORT

LOCAL REPORT NUMBER *

29140000018701

CRASH SEVERITY

3 1 - FATAL
2 - INJURY
3 - PDO

HIT/SKIP

1 - SOLVED
2 - UNSOLVED

LOCAL INFORMATION

 PHOTOS TAKEN
 OH-2
 OH-1P
 OH-3
 OTHER PDC UNDER STATE RE-PORTABLE DO CLEAR AMOUNT PRIVATE PROPERTYREPORTING AGENCY NCIC *
08304REPORTING AGENCY NAME *
MASON POLICE DEPTNUMBER OF UNITS
01UNIT IN ERROR
01 98 - ANIMAL
99 - UNKNOWNCOUNTY *
83CITY *
MASONCRASH DATE *
06192014TIME OF CRASH
2355DAY OF WEEK
TUEDEGREES / MINUTES / SECONDS
LATITUDE
39° 21' 19.34"DECIMAL DEGREES
LATITUDE
39.355373ROADWAY DIVISION
 DIVIDED
 UNDIVIDEDDIVIDED LANE DIRECTION OF TRAVEL
 N - NORTHBOUND
 E - EASTBOUND
 S - SOUTHBOUND
 W - WESTBOUNDNUMBER OF TRU LANS
02ROAD TYPES OR MILEPOST *
AL - ALLEY CR - CIRCLE HE - HEIGHTS MP - MILEPOST PL - PLACE ST - STREET WA - WAY
AV - AVENUE CT - COURT HW - HIGHWAY PK - PARKWAY RD - ROAD TE - TERRACE
BL - BOULEVARD DR - DRIVE LA - LAKE PI - PICE SQ - SQUARE TL - TRAIL

LOCATION ROUTE TYPE 1

LOCATION ROUTE NUMBER

LOC PREFIX N, S, E, W

LOCATION ROAD NAME
FAIRWAYLOCATION ROAD TYPE 2
DRROUTE TYPES *
IR - INTERSTATE ROUTE (INC. TURNPIKE) CR - NUMBERED COUNTY ROUTE
US - US ROUTE TR - NUMBERED TOWNSHIP ROUTE
SR - STATE ROUTEDISTANCE FROM REFERENCE
0 MILES
0 FEET
0 YARDS

DIR FROM REF N, S, E, W

REFERENCE ROUTE TYPE 1

REFERENCE ROUTE NUMBER

REF PREFIX N, S, E, W

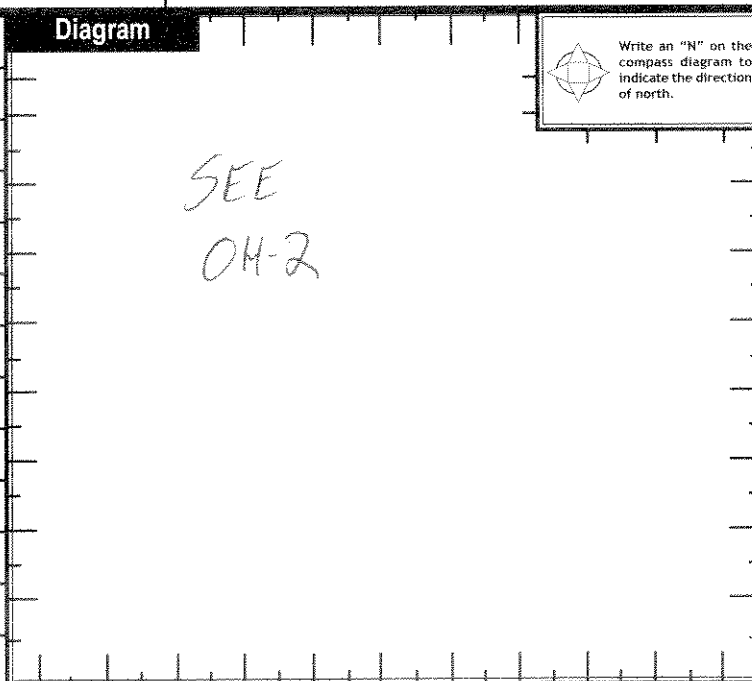
REFERENCE NAME (ROAD, MILEPOST, HOUSE #)
SPORTS COMPLEXREFERENCE POINT USED
1 - INTERSECTION
2 - MILE POST
3 - HOUSE NUMBERCRASH LOCATION
0301 - NOT AN INTERSECTION
02 - FOUR-WAY INTERSECTION
03 - T-INTERSECTION
04 - Y-INTERSECTION
05 - TRAFFIC CIRCLE/ROUNDSABOUT
06 - FIVE-POINT, OR MORE
07 - ON RAMP
08 - OFF RAMP
09 - CROSSOVER
10 - DRIVEWAY/ALLEY ACCESS
11 - RAILWAY GRADE CROSSING
12 - SHARED-USE PATHS OR TRAILS
99 - UNKNOWN INTERSECTION RELATEDLOCATION OF FIRST HARMFUL EVENT
1 - ON ROADWAY
2 - ON SHOULDER
3 - IN MEDIAN
4 - ON ROADSIDE
5 - ON GORE
6 - OUTSIDE TRAFFICWAY
9 - UNKNOWNROAD CONTOUR
1 - STRAIGHT LEVEL
2 - STRAIGHT GRADE
3 - CURVE LEVEL
4 - CURVE GRADE
9 - UNKNOWNROAD CONDITIONS
PRIMARY
02SECONDARY
01 - DRY
02 - WET
03 - SNOW
04 - ICE
05 - SAND, MUD, DIRT, OIL, GRAVEL
06 - WATER (STANDING, MOVING)
07 - SLUSH
08 - DEBRIS*
09 - RUT, HOLES, BUMPS, UNEVEN PAVEMENT*
10 - OTHER
99 - UNKNOWNMANNER OF CRASH COLLISION/IMPACT
1 - NOT COLLISION BETWEEN TWO MOTOR VEHICLES IN TRANSPORT
2 - REAR-END
3 - HEAD-ON
4 - REAR-TO-REAR
5 - BACKING
6 - ANGLE
7 - SIDESWIPE, SAME DIRECTION
8 - SIDESWIPE, OPPOSITE DIRECTION
9 - UNKNOWNWEATHER
1 - CLEAR
2 - CLOUDY
3 - FOG, SMOG, SMOKE
4 - RAIN
5 - SLEET, HAIL
6 - SNOW
7 - SEVERE CROSSWINDS
8 - BLOWING SAND, SOIL, DIRT, SNOW
9 - OTHER/UNKNOWNROAD SURFACE
1 - CONCRETE
2 - BLACKTOP, BITUMINOUS, ASPHALT
3 - BRICK/BLOCK
4 - SLAG, GRAVEL, STONE
5 - DIRT
6 - OTHERLIGHT CONDITIONS
PRIMARY
4
SECONDARY
1 - DAYLIGHT
2 - DAWN
3 - DUSK
4 - DARK - LIGHTED ROADWAY
5 - DARK - ROADWAY NOT LIGHTED
6 - DARK - UNKNOWN ROADWAY LIGHTING
7 - GLARE*
8 - OTHER
9 - UNKNOWN SCHOOL BUS RELATED
 SCHOOL ZONE RELATED
 YES, SCHOOL BUS DIRECTLY INVOLVED
 YES, SCHOOL BUS INDIRECTLY INVOLVED WORK ZONE RELATED
 WORKERS PRESENT
 LAW ENFORCEMENT PRESENT (OFFICER/VEHICLE)
 LAW ENFORCEMENT PRESENT (VEHICLE ONLY)TYPE OF WORK ZONE
1 - LANE CLOSURE
2 - LANE SHIFTS/CROSSOVER
3 - WORK ON SHOULDER OR MEDIAN
4 - INTERMITTENT OR MOVING WORK
5 - OTHERLOCATION OF CRASH IN WORK ZONE
1 - BEFORE THE FIRST WORK ZONE WARNING SIGN
2 - ADVANCE WARNING AREA
3 - TRANSITION AREA
4 - ACTIVITY AREA
5 - TERMINATION AREANARRATIVE
UNIT #1 WAS TRAVELING SOUTH BOUND ON FAIRWAY DR. AT SPORTS COMPLEX WAY. UNIT #1 WENT OFF THE RIGHT SIDE OF THE ROADWAY STRIKING A LIGHT POLE CAUSING MINOR DAMAGE TO THE VEHICLE.REPORT TAKEN BY
 POLICE AGENCY
 MOTORIST
 SUPPLEMENT (CORRECTION OR ADDITION TO AN EXISTING REPORT SENT TO ODPS)DATE CRASH REPORTED
061112014
TIME CRASH REPORTED
1347
DISPATCH TIME
1348
ARRIVAL TIME
1353
TIME CLEARED
1436
OTHER INVESTIGATION TIME
160
TOTAL MINUTES
1103OFFICER'S NAME *
A. SHAFFER
OFFICER'S BADGE NUMBER
22
CHECKED BY
SS
PAGE OF

UNIT NUMBER 011	OWNER NAME: LAST, FIRST, MIDDLE (<input type="checkbox"/> SAME AS DRIVER) GOLDFEDER TERE	OWNER PHONE NUMBER - INC. AREA CODE (<input checked="" type="checkbox"/> SAME AS DRIVER)	DAMAGE SCALE 2	DAMAGED AREA
OWNER ADDRESS: CITY, STATE, ZIP (<input checked="" type="checkbox"/> SAME AS DRIVER)			1 - NONE	
LP STATE OH	LICENSE PLATE NUMBER DFY6201	VEHICLE IDENTIFICATION NUMBER JM1BK3230412116006	2 - MINOR	
VEHICLE YEAR 2004	VEHICLE MAKE MAZDA	VEHICLE MODEL 3	3 - FUNCTIONAL	
PROOF OF INSURANCE SHOWN <input checked="" type="checkbox"/>	INSURANCE COMPANY STATE FARM	POLICY NUMBER 1135-0711-16	4 - DISABLING	
CARRIER NAME, ADDRESS, CITY, STATE, ZIP			9 - UNKNOWN	
CARRIER PHONE - INCLUDE AREA CODE				

US DOT	VEHICLE WEIGHT GVWR/GCWR 1 - LESS THAN OR EQUAL TO 10k LBS. 2 - 10,001 TO 26,000 LBS. 3 - MORE THAN 26,000 LBS.	CARGO BODY TYPE 01 - NO CARGO BODY TYPE/NOT APPLICABLE 02 - BUS/VAN (9-15 SEATS, INC DRIVER) 03 - BUS (16+ SEATS, INC DRIVER) 04 - VEHICLE TOWING ANOTHER VEHICLE 05 - LOGGING 06 - INTERMODAL CONTAINER CHASSIS 07 - CARGO VAN/ENCLOSED BOX 08 - GRAIN, CHIPS, GRAVEL	09 - POLE 10 - CARGO TANK 11 - FLAT BED 12 - DUMP 13 - CONCRETE MIXER 14 - AUTO TRANSPORTER 15 - GARBAGE/REFUSE 99 - OTHER/UNKNOWN	TRAFFICWAY DESCRIPTION 1 - TWO-WAY, NOT DIVIDED 2 - TWO-WAY, NOT DIVIDED, CONTINUOUS LEFT TURN LANE 3 - TWO-WAY, DIVIDED, UNPROTECTED (POINTED OR GRASS 2+ FT) MEDIA 4 - TWO-WAY, DIVIDED, POSITIVE MEDIUM BARRIER 5 - ONE-WAY TRAFFICWAY
HM PLACARD ID No.	<input type="checkbox"/> HAZARDOUS MATERIAL RELEASED			<input type="checkbox"/> HIT / SKIP UNIT

NON-MOTORIST LOCATION PRIOR TO IMPACT 01 - INTERSECTION - MARKED CROSSWALK 02 - INTERSECTION - NO CROSSWALK 03 - INTERSECTION - OTHER 04 - MIDDLEBLOCK - MARKED CROSSWALK 05 - TRAVEL LANE - OTHER LOCATION 06 - BICYCLE LANE 07 - SHOULDER/ROADSIDE 08 - SIDEWALK 09 - MEDIAN/CROSSING ISLAND 10 - DRIVEWAY ACCESS 11 - SHARED-USE PATH OR TRAIL 12 - NON-TRAFFICWAY AREA 99 - OTHER/UNKNOWN	TYPE OF USE 1 - PERSONAL 2 - COMMERCIAL 3 - GOVERNMENT <input type="checkbox"/> IN EMERGENCY RESPONSE	UNIT TYPE 02 99 - UNKNOWN OR HIT / SKIP	PASSENGER VEHICLES (LESS THAN 9 PASSENGERS) 01 - SUB-COMPACT 02 - COMPACT 03 - MID SIZE 04 - FULL SIZE 05 - MINIVAN 06 - SPORT UTILITY VEHICLE 07 - PICKUP 08 - VAN 09 - MOTORCYCLE 10 - MOTORIZED BICYCLE 11 - SNOWMOBILE/ATV 12 - OTHER PASSENGER VEHICLE	MED/HEAVY TRUCKS OR COMBO UNITS > 10k LBS 13 - SINGLE UNIT TRUCK OR VAN 2 AXLE, 6 TIRES 14 - SINGLE UNIT TRUCK; 3+ AXLES 15 - SINGLE UNIT TRUCK / TRAILER 16 - TRUCK/TRACTOR (BOTH)	BUS/VAN/LIMO (9 OR MORE INCLUDING DRIVER) 21 - BUS/VAN (9-15 SEATS, INC DRIVER) 22 - BUS (16+ SEATS, INC DRIVER) Non-Motorist 23 - ANIMAL WITH RIDER 24 - ANIMAL WITH BUGGY, WAGON, SURETY 25 - BICYCLE/PEDALCYCLIST 26 - PEDESTRIAN/SKATER 27 - OTHER NON-MOTORIST
			<input type="checkbox"/> HAS HM PLACARD		

SPECIAL FUNCTION 01 - NONE 02 - TAXI 03 - RENTAL TRUCK (OVER 10k LBS) 04 - BUS - SCHOOL (PUBLIC OR PRIVATE) 05 - BUS - TRANSIT 06 - BUS - CHARTER 07 - BUS - SHUTTLE 08 - BUS - OTHER	09 - AMBULANCE 10 - FIRE 11 - HIGHWAY/MAINTENANCE 12 - MILITARY 13 - POLICE 14 - PUBLIC UTILITY 15 - OTHER GOVERNMENT 16 - CONSTRUCTION EQUIP.	17 - FARM VEHICLE 18 - FARM EQUIPMENT 19 - MOTORHOME 20 - GOLF CART 21 - TRAIN 22 - OTHER (EXPLAIN IN NARRATIVE)	MOST DAMAGED AREA 03 IMPACT AREA 03	ACTION 3
---	---	---	--	-------------

PRE-CRASH ACTIONS 01 - STRAIGHT AHEAD 02 - BACKING 03 - CHANGING LANES 04 - OVERTAKING/PASSING 05 - MAKING RIGHT TURN 06 - MAKING LEFT TURN 99 - UNKNOWN	MOTORIST 07 - MAKING U-TURN 08 - ENTERING TRAFFIC LANE 09 - LEAVING TRAFFIC LANE 10 - PARKER 11 - STOPPING OR STOPPED IN TRAFFIC 12 - DRIVERLESS	13 - NEGOTIATING A CURVE 14 - OTHER MOTORIST ACTION	NON-MOTORIST 15 - ENTERING OR CROSSING SPECIFIED LOCATION 16 - WALKING, RUNNING, JOGGING, PLAYING, CYCLING 17 - WORKING 18 - PUSHING VEHICLE 19 - APPROACHING OR LEAVING VEHICLE 20 - STANDING 21 - OTHER NON-MOTORIST ACTION
---	--	--	--

CONTRIBUTING CIRCUMSTANCES PRIMARY 01 - NONE 02 - FAILURE TO YIELD 03 - RAN RED LIGHT 04 - RAN STOP SIGN 05 - EXCEEDED SPEED LIMIT 06 - UNSAFE SPEED 07 - IMPROPER TURN 08 - LEFT OF CENTER 09 - FOLLOWED TOO CLOSELY/ACDA 10 - IMPROPER LANE CHANGE /PASSING/OFF ROAD	MOTORIST 11 - IMPROPER BACKING 12 - IMPROPER STAFF FROM PARKED POSITION 13 - STOPPED OR PARKED ILLEGALLY 14 - OPERATING VEHICLE IN NEGLIGENT MANNER 15 - SWERVING TO AVOID (DUE TO EXTERNAL CONDITIONS) 16 - WRONG SIDE/WRONG WAY 17 - FAILURE TO CONTROL 18 - VISION OBSTRUCTION 19 - OPERATING DEFECTIVE EQUIPMENT 20 - LOAD SHIFTING/FALLING/SPILLING 21 - OTHER IMPROPER ACTION	NON-MOTORIST 22 - NONE 23 - IMPROPER CROSSING 24 - DARTING 25 - LYING AND/OR ILLEGALLY IN ROADWAY 26 - FAILURE TO YIELD RIGHT OF WAY 27 - NOT VISIBLE (DARK CLOTHING) 28 - INATTENTIVE 29 - FAILURE TO OBEY TRAFFIC SIGNS /SIGNALS/OBJECTS 30 - WRONG SIDE OF THE ROAD 31 - OTHER NON-MOTORIST ACTION	VEHICLE DEFECTS 01 - TURN SIGNALS 02 - HEAD LAMPS 03 - TAIL LAMPS 04 - BRAKES 05 - STEERING 06 - TIRE BLOWOUT 07 - WORN OR SLICK TIRES 08 - TRAILER EQUIPMENT DEFECTIVE 09 - MOTOR TROUBLE 10 - DISABLED FROM PRIOR ACCIDENT 11 - OTHER DEFECTS
---	--	---	--

SEQUENCE OF EVENTS 1 09 2 39 3 00 4 00 5 00 6 00 FIRST HARMFUL EVENT 1 MOST HARMFUL EVENT 2 99 - UNKNOWN	NON-COLLISION EVENTS 01 - OVERTURN/ROLLOVER 02 - FIRE/EXPLOSION 03 - IMMERSION 04 - JACKKNIFE 05 - CARGO/EQUIPMENT LOSS OR SHIFT	06 - EQUIPMENT FAILURE (BLOWN TIRE, BRAKE FAILURE, ETC) 07 - SEPARATION BY UNIT 08 - RAN OFF ROAD RIGHT 09 - RAN OFF ROAD LEFT	10 - CROSS MEDIAN 11 - CROSS CENTER LINE OPPOSITE DIRECTION OF TRAVEL 12 - DOWNHILL RUNAWAY 13 - OTHER NON-COLLISION
COLLISION WITH PERSON, VEHICLE OR OBJECT NOT FIXED 14 - PEDESTRIAN 15 - PEDALCYCLE 16 - RAILWAY VEHICLE (TRAIN, ENGINE) 17 - ANIMAL - FARM 18 - ANIMAL - DEER 19 - ANIMAL - OTHER 20 - MOTOR VEHICLE IN TRANSPORT		COLLISION WITH FIXED OBJECT 25 - IMPACT ATTENUATOR/CRASH CUSHION 26 - BRIDGE OVERHEAD STRUCTURE 27 - BRIDGE PIER OR ABUTMENT 28 - BRIDGE PARAPET 29 - BRIDGE RAIL 30 - GUARDRAIL FACE 31 - GUARDRAIL END 32 - PORTABLE BARRIER	

UNIT SPEED 020 <input checked="" type="checkbox"/> STATED <input type="checkbox"/> ESTIMATED	POSTED SPEED 25	TRAFFIC CONTROL 02 01 - NO CONTROLS 02 - STOP SIGN 03 - YIELD SIGN 04 - TRAFFIC SIGNAL 05 - TRAFFIC FLASHERS 06 - SCHOOL ZONE	07 - RAILROAD CROSSINGS 08 - RAILROAD FLASHERS 09 - RAILROAD GATES 10 - CONSTRUCTION BARRICADE 11 - PERSON (FLAGGER, OFFICER) 12 - PAVEMENT MARKINGS	13 - CROSSWALK LINES 14 - WALK/DON'T WALK 15 - OTHER 16 - NOT REPORTED	UNIT DIRECTION FROM 1 TO 2 1 - NORTH 2 - SOUTH 3 - EAST 4 - WEST	5 - NORTHWEST 6 - NORTHWEST 7 - SOUTHWEST 8 - SOUTHWEST 9 - UNKNOWN
--	---------------------------	---	---	---	---	---



MOTORIST / Non-MOTORIST / OCCUPANT

LOCAL REPORT NUMBER

2014010000118701

Motorist/Non-Motorist

Motorist/Non-Motorist

Occupant

Occupant

UNIT NUMBER 011	NAME: LAST, FIRST, MIDDLE POWERS JAMES M.	DATE OF BIRTH 09/21/1992	AGE 21	GENDER M
--------------------	--	-----------------------------	-----------	-------------

ADDRESS, CITY, STATE, ZIP 4273 PLACE POINTE DR. MASON OH	CONTACT PHONE- INCLUDE AREA CODE 513-410-0161
---	--

INJURIES 1	INJURED TAKEN BY 1	EMS AGENCY	MEDICAL FACILITY INJURED TAKEN TO	SAFETY EQUIPMENT USED 04	DOT COMPLIANT <input type="checkbox"/> MOTORCYCLE HELMET	SEATING POSITION 01	AIR BAG USAGE 1	EJECTION 1	TRAPPED 1
---------------	-----------------------	------------	-----------------------------------	-----------------------------	---	------------------------	--------------------	---------------	--------------

OL STATE OH	OPERATOR LICENSE NUMBER TE624213	OL CLASS 4	NO VALID OL <input type="checkbox"/>	M/C END. <input type="checkbox"/>	CONDITION 1	ALCOHOL/DRUG SUSPECTED 1	ALCOHOL TEST STATUS 1	ALCOHOL TEST TYPE 1	ALCOHOL TEST VALUE .000	DRUG TEST STATUS 1	DRUG TEST TYPE 1
----------------	-------------------------------------	---------------	---	--------------------------------------	----------------	-----------------------------	--------------------------	------------------------	----------------------------	-----------------------	---------------------

OFFENSE CHARGED (LOCAL CODE) 333.08	OFFENSE DESCRIPTION REASONABLE CONTROL	CITATION NUMBER 74872	HANDS-FREE DEVICE USED <input type="checkbox"/>	DRIVER DISTRACTED BY 2
--	---	--------------------------	--	---------------------------

UNIT NUMBER	NAME: LAST, FIRST, MIDDLE	DATE OF BIRTH	AGE	GENDER
-------------	---------------------------	---------------	-----	--------

ADDRESS, CITY, STATE, ZIP	CONTACT PHONE- INCLUDE AREA CODE
---------------------------	----------------------------------

INJURIES	INJURED TAKEN BY	EMS AGENCY	MEDICAL FACILITY INJURED TAKEN TO	SAFETY EQUIPMENT USED	DOT COMPLIANT	SEATING POSITION	AIR BAG USAGE	EJECTION	TRAPPED
----------	------------------	------------	-----------------------------------	-----------------------	---------------	------------------	---------------	----------	---------

OL STATE	OPERATOR LICENSE NUMBER	OL CLASS	NO VALID OL	M/C END.	CONDITION	ALCOHOL/DRUG SUSPECTED	ALCOHOL TEST STATUS	ALCOHOL TEST TYPE	ALCOHOL TEST VALUE	DRUG TEST STATUS	DRUG TEST TYPE
----------	-------------------------	----------	-------------	----------	-----------	------------------------	---------------------	-------------------	--------------------	------------------	----------------

OFFENSE CHARGED (LOCAL CODE)	OFFENSE DESCRIPTION	CITATION NUMBER	HANDS-FREE DEVICE USED	DRIVER DISTRACTED BY
------------------------------	---------------------	-----------------	------------------------	----------------------

INJURIES 1 - NO INJURY / NONE REPORTED 2 - POSSIBLE 3 - NON-IMPACTING 4 - IMPACTING 5 - FATAL	INJURED TAKEN BY 1 - NOT TRANSPORTED / TREATED AT SCENE 2 - EMS 3 - POLICE 4 - OTHER 9 - UNKNOWN	SAFETY EQUIPMENT USED 01 - NONE USED - VEHICLE OCCUPANT 02 - SHOULDER BELT ONLY USED 03 - LAP BELT ONLY USED 04 - SHOULDER AND LAP BELT USED 05 - CHILD RESTRAINT SYSTEM - FORWARD FACING 06 - CHILD RESTRAINT SYSTEM - REAR FACING 07 - BOOSTER SEAT 08 - HELMET USED 99 - UNKNOWN SAFETY EQUIPMENT	Non-Motorist 09 - NONE USED 10 - HELMET USED 11 - PROTECTIVE PADS USED (Elbows, Knees, Etc) 12 - REFLECTIVE CLOTHING 13 - LIGHTING 14 - OTHER
---	--	--	--

SEATING POSITION 01 - FRONT - LEFT SIDE (Motorcycle Driver) 02 - FRONT - MIDDLE 03 - FRONT - RIGHT SIDE 04 - SECOND - LEFT SIDE (Motorcycle Passenger) 05 - SECOND - MIDDLE 06 - SECOND - RIGHT SIDE 07 - THIRD - LEFT SIDE (Motorcycle Side-Car) 08 - THIRD - MIDDLE 09 - THIRD - RIGHT SIDE 10 - SLEEPER SECTION OF CAR (Truck) 11 - PASSENGER IN OTHER ENCLOSED CARGO AREA (Non-Trailing Unit Such as X-Bus, Pick-Up with Cap) 12 - PASSENGER IN UNENCLOSED CARGO AREA 13 - TRAILING UNIT 14 - RIDING ON VEHICLE EXTERIOR (Non-Trailing Unit) 15 - Non-Motorist 16 - OTHER 99 - UNKNOWN	AIR BAG USAGE 1 - NOT DEPLOYED 2 - DEPLOYED FRONT 3 - DEPLOYED SIDE 4 - DEPLOYED BOTH FRONT/SIDE 5 - NOT APPLICABLE 9 - DEPLOYMENT UNKNOWN
--	---

EJECTION 1 - NOT EJECTED 2 - TOTALLY EJECTED 3 - PARTIALLY EJECTED 4 - NOT APPLICABLE	TRAPPED 1 - NOT TRAPPED 2 - EXTRICATED BY MECHANICAL MEANS 3 - EXTRICATED BY NON-MECHANICAL MEANS	OPERATOR LICENSE CLASS 1 - CLASS A 2 - CLASS B 3 - CLASS C 4 - REGULAR CLASS (OH or "D") 5 - MC/Moped ONLY	CONDITION 1 - APPARENTLY NORMAL 2 - PHYSICAL IMPAIRMENT 3 - EMOTIONAL (DEPRESSED, ANGRY, DISTURBED) 4 - ILLNESS 5 - FELL ASLEEP, FAINTED, FATIGUED 6 - UNDER THE INFLUENCE OF MEDICATIONS, DRUGS, ALCOHOL 7 - OTHER	ALCOHOL/DRUG SUSPECTED 1 - NONE 2 - YES - ALCOHOL SUSPECTED 3 - YES - HBD NOT IMPAIRED 4 - YES - DRUGS SUSPECTED 5 - YES - ALCOHOL AND DRUGS SUSPECTED
--	---	--	---	--

ALCOHOL TEST STATUS 1 - NONE GIVEN 2 - TEST REFUSED 3 - TEST GIVEN, CONTAMINATED SAMPLE/UNUSABLE 4 - TEST GIVEN, RESULTS KNOWN 5 - TEST GIVEN, RESULTS UNKNOWN	ALCOHOL TEST TYPE 1 - NONE 2 - BLOOD 3 - URINE 4 - BREATH 5 - OTHER	DRUG TEST STATUS 1 - NONE GIVEN 2 - TEST REFUSED 3 - TEST GIVEN, CONTAMINATED SAMPLE/UNUSABLE 4 - TEST GIVEN, RESULTS KNOWN 5 - TEST GIVEN, RESULTS UNKNOWN	DRUG TEST TYPE 1 - NONE 2 - BLOOD 3 - URINE 4 - OTHER	DRIVER DISTRACTED BY 1 - NO DISTRACTION REPORTED 2 - PHONE 3 - TEXTING/E-MAILING 4 - ELECTRONIC COMMUNICATION DEVICE 5 - OTHER ELECTRONIC DEVICE (Navigation Device, Radio, DVD) 6 - OTHER INSIDE THE VEHICLE 7 - EXTERNAL DISTRACTION
--	---	---	--	--

UNIT NUMBER	NAME: LAST, FIRST, MIDDLE	DATE OF BIRTH	AGE	GENDER
-------------	---------------------------	---------------	-----	--------

ADDRESS, CITY, STATE, ZIP	CONTACT PHONE- INCLUDE AREA CODE
---------------------------	----------------------------------

INJURIES	INJURED TAKEN BY	EMS AGENCY	MEDICAL FACILITY INJURED TAKEN TO	SAFETY EQUIPMENT USED	DOT COMPLIANT	SEATING POSITION	AIR BAG USAGE	EJECTION	TRAPPED
----------	------------------	------------	-----------------------------------	-----------------------	---------------	------------------	---------------	----------	---------

UNIT NUMBER	NAME: LAST, FIRST, MIDDLE	DATE OF BIRTH	AGE	GENDER
-------------	---------------------------	---------------	-----	--------

ADDRESS, CITY, STATE, ZIP	CONTACT PHONE- INCLUDE AREA CODE
---------------------------	----------------------------------

INJURIES	INJURED TAKEN BY	EMS AGENCY	MEDICAL FACILITY INJURED TAKEN TO	SAFETY EQUIPMENT USED	DOT COMPLIANT	SEATING POSITION	AIR BAG USAGE	EJECTION	TRAPPED
----------	------------------	------------	-----------------------------------	-----------------------	---------------	------------------	---------------	----------	---------



LOCAL REPORT NUMBER 14-28701	REPORTING AGENCY MASON P.D.	DATE OF CRASH M 6 D 10 Y 14
IN COUNTY OF WARREN	CRASH LOCATION FAIRWAY / SPORTS COMPLEX WAY	

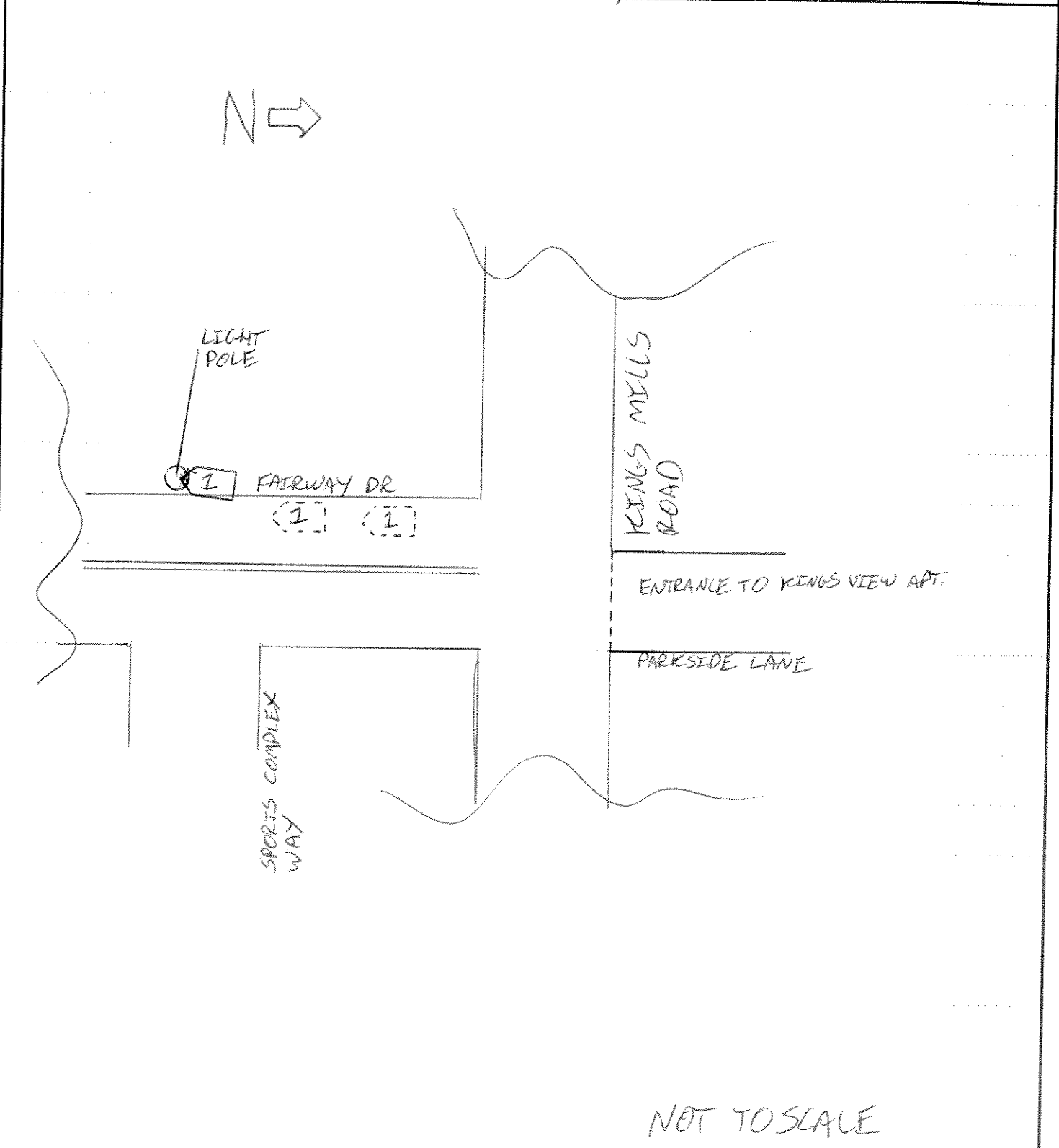

NOT TO SCALE

OFFICER'S SIGNATURE X A. SWAFFER	BADGE NUMBER 22
-------------------------------------	--------------------



LOCAL REPORT NUMBER 14-18701	REPORTING AGENCY MASON P.D.	DATE OF CRASH M 6 D 10 Y 14
---------------------------------	--------------------------------	------------------------------------

FOR LOCAL USE ONLY – DO NOT SUBMIT TO THE STATE EXCEPT FOR FATAL CRASHES

I, James Powers HEREBY MAKE THIS VOLUNTARY STATEMENT TO
PRINTED

A. SHAFFER AT FAIRWAY/SPORTS COMPLEX
OFFICER'S NAME LOCATION WAY

Last night at midnight, I was driving home from work and turned onto Fairway drive. At the time I was distracted from my phone (changing music), and hit a lamppost. I left the scene shortly after, not calling about the incident. The pole was hit on the front-right side of my car.

ADDRESS OF WITNESS 4215 Placepointe Drive, Mason, Ohio 45040	PHONE 513-410-0161
SIGNATURE OF WITNESS X	OFFICER'S SIGNATURE X