



Traffic Crash Report

Local Report Number *	Crash Severity	HITSkip
2014-13277	3 1 - Fatal 2 - Injury 3 - PDO	<input type="checkbox"/> 1 - Solved <input type="checkbox"/> 2 - Unsolved

Local Information		Reporting Agency NCIC *	Reporting Agency Name *	Number of Units	Unit in error
<input type="checkbox"/> Photos Taken OH-2 <input type="checkbox"/> OH-1P OH-3 <input type="checkbox"/> Other	<input type="checkbox"/> PDD Under State Reportable Dollar Amount	<input type="checkbox"/> Private Property	08304 MASON POLICE	02	02 98 - Animal 99 - Unknown

County *	City *	City, Village, Township *	Crash Date *	Time of Crash	Day of Week
SP	<input checked="" type="checkbox"/> City <input type="checkbox"/> Village <input type="checkbox"/> Township	MASON	10/10/2014	1648	FRI

Degrees / Minutes / Seconds	Latitude	Longitude	Decimal Degrees	Latitude	Longitude
	39° 20' 11.54"	-84° 17' 24.10"		39.336538	-84.290928

Roadway Division	Divided Lane Direction of Travel	Number of Thru Lanes	Road Types or Milepost 2
<input checked="" type="checkbox"/> Undivided	<input type="checkbox"/> N - Northbound E - Eastbound <input type="checkbox"/> S - Southbound W - Westbound	04	AL - Alley CR - Circle HE - Heights MP - Milepost PL - Place ST - Street WA - Way AV - Avenue CT - Court HW - Highway PK - Parkway RD - Road TE - Terrace BL - Boulevard DR - Drive LA - Lane PI - Pike SQ - Square TL - Trail

Location Route Type 1	Location Route Number	Loc Prefix	Location Road Name	Location Road Type 2	Route Types 3
		N, S, E, W	WESTERN Row	RD	IR - Interstate Route (inc. turnpike) CR - Numbered County Route US - US Route TR - Numbered Township Route SR - State Route

Distance From Reference	Dir From Ref	Reference Route Number	Ref Prefix	Reference Name (Road, Milepost, House #)	Reference Road Type 2
200 Miles	E N, S, E, W		N, S, E, W	INNOVATION	WY

Reference Point Used	Crash Location	Intersection Related	Location of First Harmful Event
1 - Intersection 2 - Mile Post 3 - House Number	01 01 - Not an intersection 02 - Four-way Intersection 03 - T-Intersection 04 - Y-Intersection 05 - Traffic Circle/Roundabout 06 - Five-point, or more 07 - On Ramp 08 - Off Ramp 09 - Crossover 10 - Driveway/Alley Access 11 - Railway Grade Crossing 12 - Shared-Use Paths or Trails 99 - Unknown	<input checked="" type="checkbox"/>	1 - On Roadway 2 - On Shoulder 3 - In Median 4 - On Roadside 5 - On Gore 6 - Outside Trafficway 9 - Unknown

Road Contour	Road Conditions	Weather
2 1 - Straight Level 2 - Straight Grade 3 - Curve Level 4 - Curve Grade 9 - Unknown	02 Primary Secondary 01 - Dry 02 - Wet 03 - Snow 04 - Ice 05 - Sand, Mud, Dirt, Oil, Gravel 06 - Water (Standing, Moving) 07 - Slush 08 - Debris* 09 - Rut, Holes, Bumps, Uneven Pavement* 10 - Other 99 - Unknown	4 1 - Clear 2 - Cloudy 3 - Fog, Smog, Smoke 4 - Rain 5 - Sleet, Hail 6 - Snow 7 - Severe Crosswinds 8 - Blowing Sand, Soil, Dirt, Snow 9 - Other/Unknown

Manner of Crash Collision/Impact	Weather
2 1 - Not Collision Between Two Motor Vehicles in Transport 2 - Rear-End 3 - Head-On 4 - Rear-to-Rear 5 - Backing 6 - Angle 7 - Sideswipe, Same Direction 8 - Sideswipe, Opposite Direction 9 - Unknown	4 1 - Clear 2 - Cloudy 3 - Fog, Smog, Smoke 4 - Rain 5 - Sleet, Hail 6 - Snow 7 - Severe Crosswinds 8 - Blowing Sand, Soil, Dirt, Snow 9 - Other/Unknown

Road Surface	Light Conditions	School Bus Related
2 1 - Concrete 2 - Blacktop, Bituminous, Asphalt 3 - Brick/Block 4 - Slag, Gravel, Stone 5 - Dirt 6 - Other	1 Primary Secondary 1 - Daylight 2 - Dawn 3 - Dusk 4 - Dark - Lighted Roadway 5 - Dark - Roadway Not Lighted 6 - Dark - Unknown Roadway Lighting 7 - Glare* 8 - Other	<input type="checkbox"/> School Bus Related <input type="checkbox"/> Yes, School Bus Directly Involved <input type="checkbox"/> Yes, School Bus Indirectly Involved

Work Zone Related	Workers Present	Type of Work Zone	Location of Crash in Work Zone
<input type="checkbox"/>	<input type="checkbox"/> Law Enforcement Present (Officer/Vehicle) <input type="checkbox"/> Law Enforcement Present (Vehicle Only)	<input type="checkbox"/> 1 - Lane Closure 2 - Lane Shift/Crossover 3 - Work on Shoulder or Median 4 - Intermittent or Moving Work 5 - Other	<input type="checkbox"/> 1 - Before the First Work Zone Warning Sign 2 - Advance Warning Area 3 - Transition Area 4 - Activity Area 5 - Termination Area

Narrative

UNITS #1 AND #2 WERE WESTBOUND ON WESTERN ROW ROAD. UNIT #1 WAS STOPPED IN TRAFFIC WHEN IT WAS STRUCK FROM BEHIND BY #2

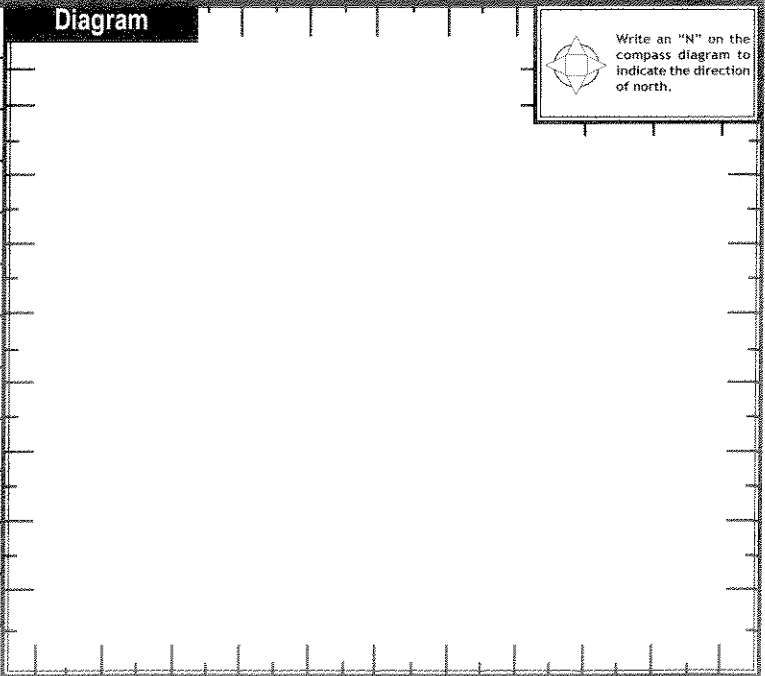

Report Taken By	Supplement (Correction or Addition to an Existing Report Sent to OGPS)	Date Crash Reported	Time Crash Reported	Dispatch Time	Arrival Time	Time Cleared	Other Investigation Time	Total Minutes
X Police Agency Motorist		10/10/2014	1652	1654	1700			
Officer's Name *	Officer's Badge Number	Checked By	Page of					
BRYANT	55	55						



MOTORIST / Non-MOTORIST / OCCUPANT

LOCAL REPORT NUMBER

20114-1321777

UNIT NUMBER 01	NAME: LAST, FIRST, MIDDLE RECHTIN, GREG R.	DATE OF BIRTH 03071977	AGE 37	GENDER M - MALE
-------------------	---	---------------------------	-----------	--------------------

ADDRESS, CITY, STATE, ZIP 236 SHELBY ST BROMLEY KY 41016	CONTACT PHONE - INCLUDE AREA CODE
---	-----------------------------------

INJURIES 1	INJURED TAKEN BY 1	EMS AGENCY	MEDICAL FACILITY INJURED TAKEN TO	SAFETY EQUIPMENT USED 04	DOT COMPLIANT <input type="checkbox"/> MOTORCYCLE HELMET	SEATING POSITION 01	AIR BAG USAGE 1	EJECTION 1	TRAPPED 1
---------------	-----------------------	------------	-----------------------------------	-----------------------------	---	------------------------	--------------------	---------------	--------------

OL STATE KY	OPERATOR LICENSE NUMBER R93350741	OL CLASS A	No VALID OL <input type="checkbox"/>	M/C END. <input type="checkbox"/>	CONDITION 1	ALCOHOL/DRUG SUSPECTED 1	ALCOHOL TEST STATUS 1	ALCOHOL TEST TYPE 1	ALCOHOL TEST VALUE	DRUG TEST STATUS 1	DRUG TEST TYPE 1
----------------	--------------------------------------	---------------	---	--------------------------------------	----------------	-----------------------------	--------------------------	------------------------	--------------------	-----------------------	---------------------

OFFENSE CHARGED (LOCAL CODE) <input type="checkbox"/>	OFFENSE DESCRIPTION	CITATION NUMBER	HANDS-FREE <input type="checkbox"/> DEVICE USED	DRIVER DISTRACTED BY 1 1
--	---------------------	-----------------	--	-----------------------------

UNIT NUMBER 02	NAME: LAST, FIRST, MIDDLE HUNT, SARAH L.	DATE OF BIRTH 09011977	AGE 37	GENDER F - FEMALE
-------------------	---	---------------------------	-----------	----------------------

ADDRESS, CITY, STATE, ZIP 2368 VISTA LAKE OL BATAVIA OH 45103	CONTACT PHONE - INCLUDE AREA CODE 5132534028
--	---

INJURIES 1	INJURED TAKEN BY 1	EMS AGENCY	MEDICAL FACILITY INJURED TAKEN TO	SAFETY EQUIPMENT USED 04	DOT COMPLIANT <input type="checkbox"/> MOTORCYCLE HELMET	SEATING POSITION 01	AIR BAG USAGE 1	EJECTION 1	TRAPPED 1
---------------	-----------------------	------------	-----------------------------------	-----------------------------	---	------------------------	--------------------	---------------	--------------

OL STATE OH	OPERATOR LICENSE NUMBER RK319045	OL CLASS A	No VALID OL <input type="checkbox"/>	M/C END. <input type="checkbox"/>	CONDITION 1	ALCOHOL/DRUG SUSPECTED 1	ALCOHOL TEST STATUS 1	ALCOHOL TEST TYPE 1	ALCOHOL TEST VALUE	DRUG TEST STATUS 1	DRUG TEST TYPE 1
----------------	-------------------------------------	---------------	---	--------------------------------------	----------------	-----------------------------	--------------------------	------------------------	--------------------	-----------------------	---------------------

OFFENSE CHARGED (LOCAL CODE) 333.03	OFFENSE DESCRIPTION ACCA	CITATION NUMBER 77202	HANDS-FREE <input type="checkbox"/> DEVICE USED	DRIVER DISTRACTED BY 1 1
--	-----------------------------	--------------------------	--	-----------------------------

INJURIES 1 - NO INJURY / NONE REPORTED 2 - POSSIBLE 3 - NON-INCAPACITATING 4 - INCAPACITATING 5 - FATAL	INJURED TAKEN BY 1 - NOT TRANSPORTED / TREATED AT SCENE 2 - EMS 3 - POLICE 4 - OTHER 9 - UNKNOWN	SAFETY EQUIPMENT USED MOTORIST 01 - NONE USED - VEHICLE OCCUPANT 02 - SHOULDER BELT ONLY USED 03 - LAP BELT ONLY USED 04 - SHOULDER AND LAP BELT USED	99 - UNKNOWN SAFETY EQUIPMENT 05 - CHILD RESTRAINT SYSTEM-FORWARD FACING 06 - CHILD RESTRAINT SYSTEM-REAR FACING 07 - BOOBYER SEAT 08 - HELMET USES	Non-MOTORIST 09 - NONE USED 10 - HELMET USED 11 - PROTECTIVE PADS USED (ELBOWS, KNEES, ETC) 12 - REFLECTIVE CLOTHING 13 - LIGHTING 14 - OTHER
--	---	--	---	---

SEATING POSITION 01 - FRONT - LEFT SIDE (MOTORCYCLE DRIVERS) 02 - FRONT - MIDDLE 03 - FRONT - RIGHT SIDE 04 - SECOND - LEFT SIDE (MOTORCYCLE PASSENGERS) 05 - SECOND - MIDDLE 06 - SECOND - RIGHT SIDE 07 - THIRD - LEFT SIDE (MOTORCYCLE SIDE CAR) 08 - THIRD - MIDDLE 09 - THIRD - RIGHT SIDE 10 - SLEEPER SECTION OF CAB (TRUCK) 11 - PASSENGER IN OTHER ENCLOSED CARGO AREA (NON-TRAILING UNIT SUCH AS A BUS, PICK-UP ORY CAR) 12 - PASSENGER IN UNENCLOSED CARGO AREA 13 - TRAILING UNIT 14 - RIDING ON VEHICLE EXTERIOR (NON-TRAILING UNIT) 15 - NON-MOTORIST 16 - OTHER 99 - UNKNOWN	AIR BAG USAGE 1 - NOT DEPLOYED 2 - DEPLOYED FRONT 3 - DEPLOYED SIDE 4 - DEPLOYED BOTH FRONT/SIDE 5 - NOT APPLICABLE 9 - DEPLOYMENT UNKNOWN
--	--

EJECTION 1 - NOT EJECTED 2 - TOTALLY EJECTED 3 - PARTIALLY EJECTED 4 - NOT APPLICABLE	TRAPPED 1 - NOT TRAPPED 2 - EXTRICATED BY MECHANICAL MEANS 3 - EXTRICATED BY NON-MECHANICAL MEANS	OPERATOR LICENSE CLASS 1 - CLASS A 2 - CLASS B 3 - CLASS C 4 - REGULAR CLASS (WITH "DP") 5 - MC/MOPED ONLY	CONDITION 1 - APPARENTLY NORMAL 2 - PHYSICAL IMPAIRMENT 3 - EMOTIONAL (DEPRESSED, ANGRY, DISTURBED) 4 - ILLNESS 5 - FELL ASLEEP, FAINTED, FATIGUED 6 - UNDER THE INFLUENCE OF MEDICATIONS, DRUGS, ALCOHOL 7 - OTHER	ALCOHOL/DRUG SUSPECTED 1 - NONE 2 - YES - ALCOHOL SUSPECTED 3 - YES - HBD NOT IMPAIRED 4 - YES - DRUGS SUSPECTED 5 - YES - ALCOHOL AND DRUGS SUSPECTED
---	--	---	--	---

ALCOHOL TEST STATUS 1 - NONE GIVEN 2 - TEST REFUSED 3 - TEST GIVEN, CONTAMINATED SAMPLE/UNUSABLE 4 - TEST GIVEN, RESULTS KNOWN 5 - TEST GIVEN, RESULTS UNKNOWN	ALCOHOL TEST TYPE 1 - NONE 2 - BLOOD 3 - URINE 4 - BREATH 5 - OTHER	DRUG TEST STATUS 1 - NONE GIVEN 2 - TEST REFUSED 3 - TEST GIVEN, CONTAMINATED SAMPLE/UNUSABLE 4 - TEST GIVEN, RESULTS KNOWN 5 - TEST GIVEN, RESULTS UNKNOWN	DRUG TEST TYPE 1 - NONE 2 - BLOOD 3 - URINE 4 - OTHER	DRIVER DISTRACTED BY 1 - NO DISTRACTION REPORTED 2 - PHONE 3 - TEXTING/E-MAILING 4 - ELECTRONIC COMMUNICATION DEVICE 5 - OTHER ELECTRONIC DEVICE (HANDHELD DEVICE, RADIO, DVD) 6 - OTHER INSIDE THE VEHICLE 7 - EXTERNAL DISTRACTION
---	--	--	---	---

UNIT NUMBER	NAME: LAST, FIRST, MIDDLE	DATE OF BIRTH	AGE	GENDER F - FEMALE M - MALE
-------------	---------------------------	---------------	-----	----------------------------------

ADDRESS, CITY, STATE, ZIP	CONTACT PHONE - INCLUDE AREA CODE
---------------------------	-----------------------------------

INJURIES	INJURED TAKEN BY	EMS AGENCY	MEDICAL FACILITY INJURED TAKEN TO	SAFETY EQUIPMENT USED	DOT COMPLIANT <input type="checkbox"/> MOTORCYCLE HELMET	SEATING POSITION	AIR BAG USAGE	EJECTION	TRAPPED
----------	------------------	------------	-----------------------------------	-----------------------	---	------------------	---------------	----------	---------

UNIT NUMBER	NAME: LAST, FIRST, MIDDLE	DATE OF BIRTH	AGE	GENDER F - FEMALE M - MALE
-------------	---------------------------	---------------	-----	----------------------------------

ADDRESS, CITY, STATE, ZIP	CONTACT PHONE - INCLUDE AREA CODE
---------------------------	-----------------------------------

INJURIES	INJURED TAKEN BY	EMS AGENCY	MEDICAL FACILITY INJURED TAKEN TO	SAFETY EQUIPMENT USED	DOT COMPLIANT <input type="checkbox"/> MOTORCYCLE HELMET	SEATING POSITION	AIR BAG USAGE	EJECTION	TRAPPED
----------	------------------	------------	-----------------------------------	-----------------------	---	------------------	---------------	----------	---------



Unit

Local Report Number
2014-132777

Unit Number 01	Owner Name: Last, First, Middle (X) Same As Driver	Owner Phone Number - inc. area code (X) Same As Driver	Damage Scale 2	Damage Area
--------------------------	--	--	--------------------------	-----------------

Owner Address: City, State, Zip **(X) Same As Driver**

LP State KY	License Plate Number 809 EJM	Vehicle Identification Number 5TEU42W36Z304963	# Occupants 01
-----------------------	--	--	--------------------------

Vehicle Year 2006	Vehicle Make TOYOTA	Vehicle Model TACOMA	Vehicle Color SILVER
-----------------------------	-------------------------------	--------------------------------	--------------------------------

<input checked="" type="checkbox"/> Proof of Insurance Shown	Insurance Company METROPOLITAN	Policy Number 345441960-0	Towed By
--	--	-------------------------------------	----------

Carrier Name, Address, City, State, Zip

Carrier Phone- include area code

US DOT	Vehicle Weight GVWR/GWR 1 1 - Less Than or Equal to 10k Lbs. 2 - 10,001 to 26,000 Lbs. 3 - More Than 26,000 Lbs.	Cargo Body Type 01 01 - No Cargo Body Type/Not Applicable 02 - Bus/Van (9-15 Seats, Inc Driver) 03 - Bus (16+ Seats, Inc Driver) 04 - Vehicle Towing Another Vehicle 05 - Logging 06 - Intermodal Container Chassis 07 - Cargo Van/Enclosed Box 08 - Grain, Chips, Gravel	09 - Pole 10 - Cargo Tank 11 - Flat Bed 12 - Dump 13 - Concrete Mixer 14 - Auto Transporter 15 - Garbage/Refuse 99 - Other/Unknown	Trafficway Description 1 1 - Two-Way, Not Divided 2 - Two-Way, Not Divided, Continuous Left Turn Lane 3 - Two-Way, Divided, Unprotected (Pavement or Grass - 4 Ft.) Median 4 - Two-Way, Divided, Positive Median Barrier 5 - One-Way Trafficway
--------	---	---	---	--

HM Placard ID No.	HM Class Number	Hazardous Material Released <input type="checkbox"/>	Non-Motorist Location Prior to Impact 01 01 - Intersection - Marked Crosswalk 02 - Intersection - No Crosswalk 03 - Intersection - Other 04 - Midblock - Marked Crosswalk 05 - Travel Lane - Other Location 06 - Bicycle Lane 07 - Shoulder/Roadside 08 - Sidewalk 09 - Median/Crossing Island 10 - Driveway Access 11 - Shared-Use Path or Trail 12 - Non-Trafficway Area 99 - Other/Unknown	Type of Use 1 1 - Personal 2 - Commercial 3 - Government <input type="checkbox"/> In Emergency Response	Unit Type 07 99 - Unknown or Hit / Skip	Passenger Vehicles (less than 9 passengers) 01 - Sub-Compact 02 - Compact 03 - Mid Size 04 - Full Size 05 - Minivan 06 - Sport Utility Vehicle 07 - Pickup 08 - Van 09 - Motorcycle 10 - Motorized Bicycle 11 - Snowmobile/ATV 12 - Other Passenger Vehicle	Med/Heavy Trucks or Combo Units > 10k lbs 13 - Single Unit Truck or Van 2axle, 6 tires 14 - Single Unit Truck; 3+ axles 15 - Single Unit Truck / Trailer 16 - Truck/Tractor (Bobtail) 17 - Tractor/Semi-Trailer 18 - Tractor/Double 19 - Tractor/Triples 20 - Other Med/Heavy Vehicle	Bus/Van/Limo (9 or More Including Driver) 21 - Bus/Van (9-15 Seats, Inc Driver) 22 - Bus (16+ Seats, Inc Driver) Non-Motorist 23 - Animal with Rider 24 - Animal with Buggy, Wagon, Surrey 25 - Bicycle/Pedacyclist 26 - Pedestrian/Skater 27 - Other Non-Motorist
-------------------	-----------------	---	--	---	--	---	---	---

Special Function 01 01 - None 02 - Taxi 03 - Rental Truck (Over 10k Lbs) 04 - Bus - School (Public or Private) 05 - Bus - Transit 06 - Bus - Charter 07 - Bus - Shuttle 08 - Bus - Other	09 - Ambulance 10 - Fire 11 - Highway/Maintenance 12 - Military 13 - Police 14 - Public Utility 15 - Other Government 16 - Construction Equip.	17 - Farm Vehicle 18 - Farm Equipment 19 - Motorhome 20 - Golf Cart 21 - Train 22 - Other (Explain in Narrative)	Most Damaged Area 06 01 - None 02 - Center Front 03 - Right Front 04 - Right Side 05 - Right Rear 06 - Rear Center 07 - Left Rear	08 - Left Side 09 - Left Front 10 - Top and Windows 11 - Undercarriage 12 - Load/Trailer 13 - Total(AH Area) 14 - Other	Action 4 1 - Non-Contact 2 - Non-Collision 3 - Striking 4 - Struck 5 - Striking/Struck 9 - Unknown
--	---	---	--	---	--

Pre-Crash Actions 00 99 - Unknown	Motorist 01 - Straight Ahead 02 - Backing 03 - Changing Lanes 04 - Overtaking/Passing 05 - Making Right Turn 06 - Making Left Turn	07 - Making U-Turn 08 - Entering Traffic Lane 09 - Leaving Traffic Lane 10 - Parked 11 - Slowing or Stopped in Traffic 12 - Driverless	13 - Negotiating a Curve 14 - Other Motorist Action	Non-Motorist 15 - Entering or Crossing Specified Location 16 - Walking, Running, Jogging, Playing, Cycling 17 - Working 18 - Pushing Vehicle 19 - Approaching or Leaving Vehicle 20 - Standing	21 - Other Non-Motorist Action
--	--	---	--	--	--------------------------------

Contributing Circumstances 01 Primary 01 - None 02 - Failure to Yield 03 - Ran Red Light 04 - Ran Stop Sign Secondary 05 - Exceeded Speed Limit 06 - Unsafe Speed 07 - Improper Turn 08 - Left of Center 09 - Followed Too Closely/ACDA 10 - Improper Lane Change /Passing/Off Road	Motorist 11 - Improper Backing 12 - Improper Start From Parked Position 13 - Stopped or Parked Illegally 14 - Operating Vehicle in Negligent Manner 15 - Swerving to Avoid (Due to External Conditions) 16 - Wrong Side/Wrong Way 17 - Failure to Control 18 - Vision Obstruction 19 - Operating Defective Equipment 20 - Load Shifting/Falling/Spilling 21 - Other Improper Action	Non-Motorist 22 - None 23 - Improper Crossing 24 - Darting 25 - Lying and/or Illegally in Roadway 26 - Failure to Yield Right of Way 27 - Not Visible (Dark Clothing) 28 - Inattentive 29 - Failure to Obey Traffic Signs /Signals/Officer 30 - Wrong Side of the Road 31 - Other Non-Motorist Action	Vehicle Defects 00 03 - Turn Signals 02 - Head Lamps 03 - Tail Lamps 04 - Brakes 05 - Steering 06 - Tire Blowout 07 - Worn or Slick tires 08 - Trailer Equipment Defective 09 - Motor Trouble 10 - Disabled From Prior Accident 11 - Other Defects
---	--	---	---

Sequence of Events 1 20 2 00 3 00 4 00 5 00 6 00 First Harmful Event 01 Most Harmful Event 01 Collision with Person, Vehicle or Object Not Fixed 14 - Pedestrian 15 - Pedalcycle 16 - Railway Vehicle (Train, Engine) 17 - Animal - Farm 18 - Animal - Deer 19 - Animal - Other 20 - Motor Vehicle in Transport	Non-Collision Events 01 - Overturn/Rollover 02 - Fire/Explosion 03 - Immersion 04 - Jackknife 05 - Cargo/Equipment Loss or Shift	Collision With Fixed Object 25 - Impact Attenuator/Crash Cushion 26 - Bridge Overhead Structure 27 - Bridge Pier or Abutment 28 - Bridge Parapet 29 - Bridge Rail 30 - Guardrail Face 31 - Guardrail End 32 - Portable Barrier	33 - Median Cable Barrier 34 - Median Guardrail Barrier 35 - Median Concrete Barrier 36 - Median Other Barrier 37 - Traffic Sign Post 38 - Overhead Sign Post 39 - Light/Luminaries Support 40 - Utility Pole	41 - Other Post, Pole or Support 42 - Culvert 43 - Curb 44 - Ditch 45 - Embankment 46 - Fence 47 - Mailbox	10 - Cross Median 11 - Cross Center Line Opposite Direction of Travel 12 - Downhill Runaway 13 - Other Non-Collision	48 - Tree 49 - Fire Hydrant 50 - Work Zone Maintenance Equipment 51 - Wall, Building, Tunnel 52 - Other Fixed Object
---	---	--	--	--	--	--

Unit Speed 10 <input checked="" type="checkbox"/> Stated <input type="checkbox"/> Estimated	Posted Speed 35	Traffic Control 12 01 - No Controls 02 - Stop Sign 03 - Yield Sign 04 - Traffic Signal 05 - Traffic Flashers 06 - School Zone	07 - Railroad Crossbucks 08 - Railroad Flashers 09 - Railroad Gates 10 - Construction Barricade 11 - Person (Pagger, Officer) 12 - Pavement Markings	13 - Crosswalk Lines 14 - Walk/Don't Walk 15 - Other 16 - Not Reported	Unit Direction From 3 To 4 1 - North 2 - South 3 - East 4 - West	5 - Northeast 6 - Northwest 7 - Southeast 8 - Southwest 9 - Unknown
---	---------------------------	---	---	---	---	---



Unit

Local Report Number
2019-132777

Unit Number 02	Owner Name: Last, First, Middle CWNTAS SERVICE <input type="checkbox"/> Same As Driver	Owner Phone Number - inc. area code 513 459 1200 <input type="checkbox"/> Same As Driver	Damage Scale 2	
Owner Address: City, State, Zip <input type="checkbox"/> Same As Driver 6800 CWNTAS BLVD MASON OHIO 45040			1 - None	
LP State OH	License Plate Number PGB 3576	Vehicle Identification Number 1F1TME124K48DA23092	2 - Minor	
Vehicle Year 2008	Vehicle Make FORD	Vehicle Model E 250	3 - Functional	
<input checked="" type="checkbox"/> Proof of Insurance Shown	Insurance Company AON RISK SERVICES	Policy Number HC2ECAP472M4661CT14	4 - Disabling	
Carrier Name, Address, City, State, Zip			9 - Unknown	
Carrier Phone - include area code				

US DOT	Vehicle Weight GVWR/GCWR 1 - Less Than or Equal to 10k Lbs. 2 - 10,001 to 26,000 Lbs. 3 - More Than 26,000 Lbs.	Cargo Body Type 01 01 - No Cargo Body Type/Not Applicable 02 - Bus/Van (9-15 Seats, Inc Driver) 03 - Bus (16 - Seats, Inc Driver) 04 - Vehicle Towing Another Vehicle 05 - Logging 06 - Intermodal Container Chassis 07 - Cargo Van/Enclosed Box 08 - Grain, Chips, Gravel	Trafficway Description 1 1 - Two-Way, Not Divided 2 - Two-Way, Not Divided, Continuous Left Turn Lane 3 - Two-Way, Divided, Unprotected/Painted or Grass - (s Fl.) Median 4 - Two-Way, Divided, Positive Median Barrier 5 - One-Way Trafficway
HM Placard ID No.	<input type="checkbox"/> Hazardous Material Released	09 - Pole 10 - Cargo Tank 11 - Flat Bed 12 - Dump 13 - Concrete Mixer 14 - Auto Transporter 15 - Garbage/Refuse 99 - Other/Unknown	<input type="checkbox"/> Hit / Skip Unit
HM Class Number			

Non-Motorist Location Prior to Impact 01 01 - Intersection - Marked Crosswalk 02 - Intersection - No Crosswalk 03 - Intersection - Other 04 - Midblock - Marked Crosswalk 05 - Travel Lane - Other Location 06 - Bicycle Lane 07 - Shoulder/Roadside 08 - Sidewalk 09 - Median/Crossing Island 10 - Driveway Access 11 - Shared-Use Path or Trail 12 - Non-Trafficway Area 99 - Other/Unknown	Type of Use 2 1 - Personal 2 - Commercial 3 - Government <input type="checkbox"/> In Emergency Response	Unit Type 08 99 - Unknown or Hit / Skip	Passenger Vehicles (less than 9 passengers) 01 - Sub-Compact 02 - Compact 03 - Mid Size 04 - Full Size 05 - Minivan 06 - Sport Utility Vehicle 07 - Pickup 08 - Van 09 - Motorcycle 10 - Motorized Bicycle 11 - Snowmobile/ATV 12 - Other Passenger Vehicle	Med/Heavy Trucks or Combo Units > 10k lbs 13 - Single Unit Truck or Van 2axle, 6 tires 14 - Single Unit Truck; 3+ axles 15 - Single Unit Truck / Trailer 16 - Tractor/Tractor (Bobtail) 17 - Tractor/Semi-Trailer 18 - Tractor/Double 19 - Tractor/Triples 20 - Other Med/Heavy Vehicle	Bus/Van/Limo (9 or More Including Driver) 21 - Bus/Van (9-15 Seats, Inc Driver) 22 - Bus (16+ Seats, Inc Driver) Non-Motorist 23 - Animal with Rider 24 - Animal with Buggy, Wagon, Surrey 25 - Bicycle/Pedacyclist 26 - Pedestrian/Skater 27 - Other Non-Motorist
			<input type="checkbox"/> Has HM Placard		

Special Function 01 01 - None 02 - Taxi 03 - Rental Truck (Over 10k Lbs) 04 - Bus - School (Public or Private) 05 - Bus - Transit 06 - Bus - Charter 07 - Bus - Shuttle 08 - Bus - Other	09 - Ambulance 10 - Fire 11 - Highway/Maintenance 12 - Military 13 - Police 14 - Public Utility 15 - Other Government 16 - Construction Equip.	17 - Farm Vehicle 18 - Farm Equipment 19 - Motorhome 20 - Golf Cart 21 - Train 22 - Other (Explain in Narrative)	Most Damaged Area 02 01 - None 02 - Center Front 03 - Right Front 04 - Right Side 05 - Right Rear 06 - Rear Center 07 - Left Rear	08 - Left Side 09 - Left Front 10 - Top and Windows 11 - Undercarriage 12 - Load/Trailer 13 - Total/All Areas 14 - Other	Action 3 1 - Non-Contact 2 - Non-Collision 3 - Striking 4 - Struck 5 - Striking/Struck 9 - Unknown
--	---	---	--	--	--

Pre-Crash Actions 01 99 - Unknown	Motorist 01 - Straight Ahead 02 - Backing 03 - Changing Lanes 04 - Overtaking/Passing 05 - Making Right Turn 06 - Making Left Turn	07 - Making U-Turn 08 - Entering Traffic Lane 09 - Leaving Traffic Lane 10 - Parked 11 - Slowing or Stopped in Traffic 12 - Driverless	13 - Negotiating a Curve 14 - Other Motorist Action	Non-Motorist 15 - Entering or Crossing Specified Location 16 - Walking, Running, Jogging, Playing, Cycling 17 - Working 18 - Pushing Vehicle 19 - Approaching or Leaving Vehicle 20 - Standing	21 - Other Non-Motorist Action
--	--	---	--	--	--------------------------------

Contributing Circumstances Primary 09 01 - None 02 - Failure to Yield 03 - Ran Red Light 04 - Ran Stop Sign 05 - Exceeded Speed Limit 06 - Unsafe Speed 07 - Improper Turn 08 - Left of Center 09 - Followed Too Closely/ACDA 10 - Improper Lane Change /Passing/Off Road 99 - Unknown	Motorist 11 - Improper Backing 12 - Improper Start From Parked Position 13 - Stopped or Parked Illegally 14 - Operating Vehicle in Negligent Manner 15 - Swerving to Avoid (Due to External Conditions) 16 - Wrong Side/Wrong Way 17 - Failure to Control 18 - Vision Obstruction 19 - Operating Defective Equipment 20 - Load Shifting/Falling/Spilling 21 - Other Improper Action	Non-Motorist 22 - None 23 - Improper Crossing 24 - Darting 25 - Lying and/or Illegally in Roadway 26 - Failure to Yield Right of Way 27 - Not Visible (Dark Clothing) 28 - Inattentive 29 - Failure to Obey Traffic Signs /Signals/Officer 30 - Wrong Side of the Road 31 - Other Non-Motorist Action	Vehicle Defects 01 01 - Turn Signals 02 - Head Lamps 03 - Tail Lamps 04 - Brakes 05 - Steering 06 - Tire Blowout 07 - Worn or Slick tires 08 - Trailer Equipment Defective 09 - Motor Trouble 10 - Disabled From Prior Accident 11 - Other Defects
--	--	---	---

Sequence of Events 1 20 2 01 3 01 4 01 5 01 6 01 First Harmful Event 1 Most Harmful Event 1 99 - Unknown	Non-Collision Events 01 - Overturn/Rollover 02 - Fire/Explosion 03 - Immersion 04 - Jackknife 05 - Cargo/Equipment Loss or Shift	06 - Equipment Failure (Blown Tire, Brake Failure, etc.) 07 - Separation of Units 08 - Ran Off Road Right 09 - Ran Off Road Left	10 - Cross Median 11 - Cross Center Line 12 - Downhill Runaway 13 - Other Non-Collision
Collision with Person, Vehicle or Object Not Fixed 14 - Pedestrian 15 - Pedacyclist 16 - Railway Vehicle (Train, Engine) 17 - Animal - Farm 18 - Animal - Deer 19 - Animal - Other 20 - Motor Vehicle in Transport	21 - Parked Motor Vehicle 22 - Work Zone Maintenance Equipment 23 - Struck by Falling, Shifting Cargo or Anything Set in Motion by a Motor Vehicle 24 - Other Movable Object	25 - Impact Attenuator/Crash Cushion 26 - Bridge Overhead Structure 27 - Bridge Pier or Abutment 28 - Bridge Parapet 29 - Bridge Rail 30 - Guardrail Face 31 - Guardrail End 32 - Portable Barrier	33 - Median Cable Barrier 34 - Median Guardrail Barrier 35 - Median Concrete Barrier 36 - Median Other Barrier 37 - Traffic Sign Post 38 - Overhead Sign Post 39 - Light/Luminaries Support 40 - Utility Pole
	41 - Other Post, Pole or Support 42 - Culvert 43 - Curb 44 - Ditch 45 - Embankment 46 - Fence 47 - Mailbox	48 - Tree 49 - Fire Hydrant 50 - Work Zone Maintenance Equipment 51 - Wall, Building, Tunnel 52 - Other Fixed Object	

Unit Speed 5	Posted Speed 35	Traffic Control 12 01 - No Controls 02 - Stop Sign 03 - Yield Sign 04 - Traffic Signal 05 - Traffic Flashers 06 - School Zone	07 - Railroad Crossbucks 08 - Railroad Flashers 09 - Railroad Gates 10 - Construction Barricade 11 - Person (Flagger, Officer) 12 - Pavement Markings	13 - Crosswalk Lines 14 - Walk/Don't Walk 15 - Other 16 - Not Reported	Unit Direction From 3 To 4 1 - North 2 - South 3 - East 4 - West	5 - Northeast 6 - Northwest 7 - Southeast 8 - Southwest 9 - Unknown
<input checked="" type="checkbox"/> Stated <input type="checkbox"/> Estimated						Page of



LOCAL REPORT NUMBER 14-32777	REPORTING AGENCY MASON POLICE	DATE OF CRASH M 10 D 10 Y 14
IN COUNTY OF WARREN	CRASH LOCATION WESTERN Row RD	

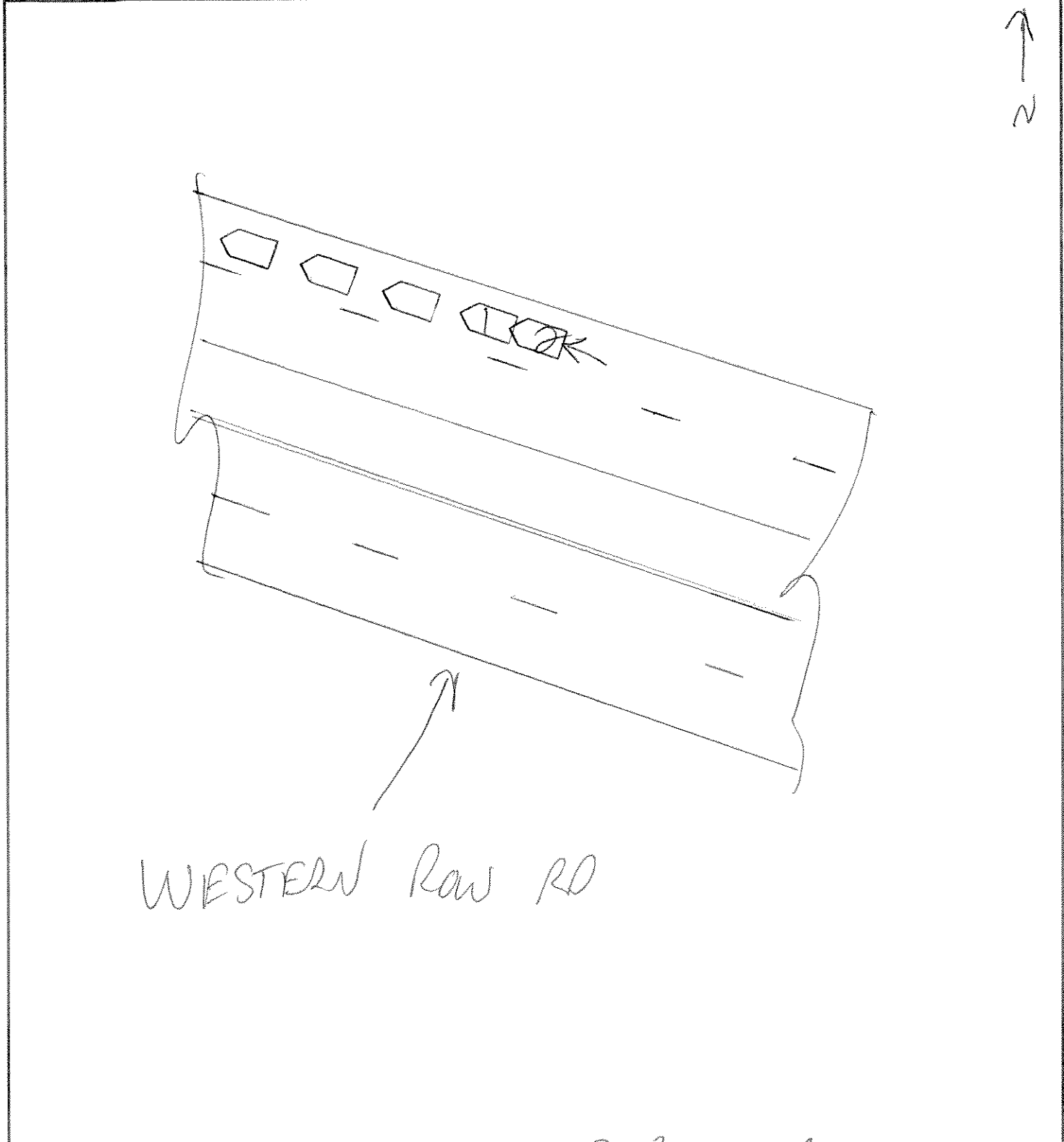

NOT TO SCALE

OFFICER'S SIGNATURE X [Signature]	BADGE NUMBER 55
--------------------------------------	--------------------



LOCAL REPORT NUMBER <i>14-32777</i>	REPORTING AGENCY MASON POLICE	DATE OF CRASH <i>M 10 D 10 Y 14</i>
--	---	--

FOR LOCAL USE ONLY - DO NOT SUBMIT TO THE STATE EXCEPT FOR FATAL CRASHES

I, *Greg Rechia* HEREBY MAKE THIS VOLUNTARY STATEMENT TO
PRINTED

P.O. K. S. BRYANT AT *Western Row and Innovation*
OFFICER'S NAME LOCATION

I was stopped at the traffic light. The light had just turned green and I was about go when my vehicle was struck from behind

Q. WERE YOU, OR ANYONE IN YOUR VEHICLE INJURED? *No*

Q. WERE YOU WEARING YOUR SEAT BELT? *Yes*

Q. WHAT DIRECTION WERE YOU GOING? *WEST*

Q. WHAT WAS YOUR SPEED? *Stopped*

Q. WERE YOU USING A CELL PHONE AT THE TIME OF THE CRASH? *No*

ADDRESS OF WITNESS
235 Shelby St Bronley KY 41016

SIGNATURE OF WITNESS *X*

PHONE
859-881-5367

OFFICER'S SIGNATURE *X*



LOCAL REPORT NUMBER 14-3277	REPORTING AGENCY MASON POLICE	DATE OF CRASH M 10 10 14
--------------------------------	----------------------------------	---------------------------------

FOR LOCAL USE ONLY – DO NOT SUBMIT TO THE STATE EXCEPT FOR FATAL CRASHES

I, _____ HEREBY MAKE THIS VOLUNTARY STATEMENT TO

PRINTED

P.O. K. S. BRYANT

AT

CRASH SCENE

OFFICER'S NAME

LOCATION

Stopped @ light. Light turned green; was adjusting header
& saw traffic start to move to my right & in front
^{from the corner of my eye}
so I started to go but driver directly in front
hadn't

Q. WERE YOU, OR ANYONE IN YOUR VEHICLE INJURED? No

Q. WERE YOU WEARING YOUR SEAT BELT? yes

Q. WHAT DIRECTION WERE YOU GOING? west

Q. WHAT WAS YOUR SPEED? —

Q. WERE YOU USING A CELL PHONE AT THE TIME OF THE CRASH? NO

ADDRESS OF WITNESS

PHONE

SIGNATURE OF WITNESS

X

[Handwritten signature]

OFFICER'S SIGNATURE

X

[Handwritten signature]

513 283 4628