



# TRAFFIC CRASH REPORT

LOCAL REPORT NUMBER * 2101315167	CRASH SEVERITY 1 - FATAL 2 - INJURY 3 - PDO 3	HIT/SKIP 1 - SOLVED 2 - UNSOLVED 2
-------------------------------------	---	---

PHOTOS TAKEN <input checked="" type="checkbox"/> OH-2 <input type="checkbox"/> OH-1P <input type="checkbox"/> OH-3 <input type="checkbox"/> OTHER	PDO UNDER STATE REPORTABLE DOLLAR AMOUNT 8304	PRIVATE PROPERTY MASON POLICE	REPORTING AGENCY NCIC * 8304	REPORTING AGENCY NAME * MASON POLICE	NUMBER OF UNITS 02	UNIT IN ERROR 01	98 - ANIMAL 99 - UNKNOWN
---	--	----------------------------------	---------------------------------	---	-----------------------	---------------------	-----------------------------

COUNTY * 83	CITY * MASON	CITY, VILLAGE, TOWNSHIP *	CRASH DATE * 05292013	TIME OF CRASH 1200	DAY OF WEEK WED
----------------	-----------------	---------------------------	--------------------------	-----------------------	--------------------

DEGREES / MINUTES / SECONDS LATITUDE 39° 21' 53.20"	LONGITUDE -84° 17' 20.78"	DECIMAL DEGREES LATITUDE 39.364777	LONGITUDE -84.289106
---	------------------------------	--	-------------------------

ROADWAY DIVISION <input type="checkbox"/> DIVIDED <input checked="" type="checkbox"/> UNDIVIDED	DIVIDED LANE DIRECTION OF TRAVEL N - NORTHBOUND E - EASTBOUND S - SOUTHBOUND W - WESTBOUND	NUMBER OF THRU LANES 01	ROAD TYPES OR MILEPOST * AL - ALLEY CR - CIRCLE HE - HEIGHTS MP - MILEPOST PL - PLACE ST - STREET WA - WAY AV - AVENUE CT - COURT HW - HIGHWAY PK - PARKWAY RD - ROAD TE - TERRACE BL - BOULEVARD DR - DRIVE LA - LAKE PI - PIKE SQ - SQUARE TL - TRAIL
---	--	----------------------------	--

LOCATION ROUTE TYPE 1 01	LOCATION ROUTE NUMBER	LOC PREFIX N, S, E, W	LOCATION ROAD NAME MARBLE RIDGE	LOCATION ROAD TYPE 2 LA	ROUTE TYPES * IR - INTERSTATE ROUTE (INC. TURNPIKE) CR - NUMBERED COUNTY ROUTE US - US ROUTE TR - NUMBERED TOWNSHIP ROUTE SR - STATE ROUTE
-----------------------------	-----------------------	-----------------------	------------------------------------	----------------------------	---

DISTANCE FROM REFERENCE MILES FEET YARDS	DIR FROM REF N, S, E, W	REFERENCE ROUTE TYPE 1 01	REFERENCE ROUTE NUMBER	REF PREFIX N, S, E, W	REFERENCE NAME (ROAD, MILEPOST, HOUSE #) 3983	REFERENCE ROAD TYPE 2
---	----------------------------	------------------------------	------------------------	-----------------------	--	-----------------------

REFERENCE POINT USED 1 - INTERSECTION 2 - MILE POST 3 - HOUSE NUMBER 3	CRASH LOCATION 01 - NOT AN INTERSECTION 02 - FOUR-WAY INTERSECTION 03 - T-INTERSECTION 04 - Y-INTERSECTION 05 - TRAFFIC CIRCLE/ROUNDABOUT 06 - FIVE-POINT OR MORE 07 - ON RAMP 08 - OFF RAMP 09 - CROSSOVER 10 - DRIVEWAY/ALLEY ACCESS	11 - RAILWAY GRADE CROSSING 12 - SHARED-USE PATHS OR TRAILS 99 - UNKNOWN	INTERSECTION RELATED <input type="checkbox"/>	LOCATION OF FIRST HARMFUL EVENT 1 - ON ROADWAY 2 - ON SHOULDER 3 - IN MEDIAN 4 - ON ROADSIDE 5 - ON GORE 6 - OUTSIDE TRAFFICWAY 9 - UNKNOWN
--	--	--	--	--

ROAD CONTOUR 1 - STRAIGHT LEVEL 2 - STRAIGHT GRADE 3 - CURVE LEVEL 4 - CURVE GRADE 9 - UNKNOWN	ROAD CONDITIONS PRIMARY SECONDARY	01 - DRY 02 - WET 03 - SNOW 04 - ICE 05 - SAND, MUD, DIRT, OIL, GRAVEL 06 - WATER (STANDING, MOVING) 07 - SLUSH 08 - DEBRIS* 09 - RUT, HOLES, BUMPS, UNEVEN PAVEMENT* 10 - OTHER 99 - UNKNOWN	* SECONDARY CONDITION ONLY
---	---	---	----------------------------

MANNER OF CRASH COLLISION/IMPACT 1 - NOT COLLISION BETWEEN TWO MOTOR VEHICLES IN TRANSPORT 2 - REAR-END 3 - HEAD-ON 4 - REAR-TO-REAR 5 - BACKING 6 - ANGLE 7 - SIDESWIPE, SAME DIRECTION 8 - SIDESWIPE, OPPOSITE DIRECTION 9 - UNKNOWN	WEATHER 1 - CLEAR 2 - CLOUDY 3 - FOG, SMOG, SMOKE 4 - RAIN 5 - SLEET, HAIL 6 - SNOW 7 - SEVERE CROSSWINDS 8 - BLOWING SAND, SOIL, DIRT, SNOW 9 - OTHER/UNKNOWN
---	---

ROAD SURFACE 1 - CONCRETE 2 - BLACKTOP, BITUMINOUS, ASPHALT 3 - BRICK/BLOCK 4 - SLAB, GRAVEL, STONE 5 - DIRT 6 - OTHER	LIGHT CONDITIONS PRIMARY SECONDARY	1 - DAYLIGHT 2 - DAWN 3 - DUSK 4 - DARK - LIGHTED ROADWAY 5 - DARK - ROADWAY NOT LIGHTED 6 - DARK - UNKNOWN ROADWAY LIGHTING 7 - GLARE* 8 - OTHER 9 - UNKNOWN	SCHOOL BUS RELATED <input type="checkbox"/> SCHOOL ZONE RELATED <input type="checkbox"/> YES, SCHOOL BUS DIRECTLY INVOLVED <input type="checkbox"/> YES, SCHOOL BUS INDIRECTLY INVOLVED
--	--	---	--

WORK ZONE RELATED <input type="checkbox"/>	WORKERS PRESENT <input type="checkbox"/> LAW ENFORCEMENT PRESENT (OFFICER/VEHICLE) <input type="checkbox"/> LAW ENFORCEMENT PRESENT (VEHICLE ONLY)	TYPE OF WORK ZONE 1 - LANE CLOSURE 2 - LANE SHIFT/CROSSOVER 3 - WORK ON SHOULDER OR MEDIAN 4 - INTERMITTENT OR MOVING WORK 5 - OTHER	LOCATION OF CRASH IN WORK ZONE 1 - BEFORE THE FIRST WORK ZONE WARNING SIGN 2 - ADVANCE WARNING AREA 3 - TRANSITION AREA 4 - ACTIVITY AREA 5 - TERMINATION AREA
---	--	---	---

NARRATIVE

UNIT #02 WAS PARKED UNOCCUPIED, IN FRONT OF 3983 MARBLE RIDGE LN.

UNIT #01 STRUCK UNIT #02 AND LEFT THE SCENE.

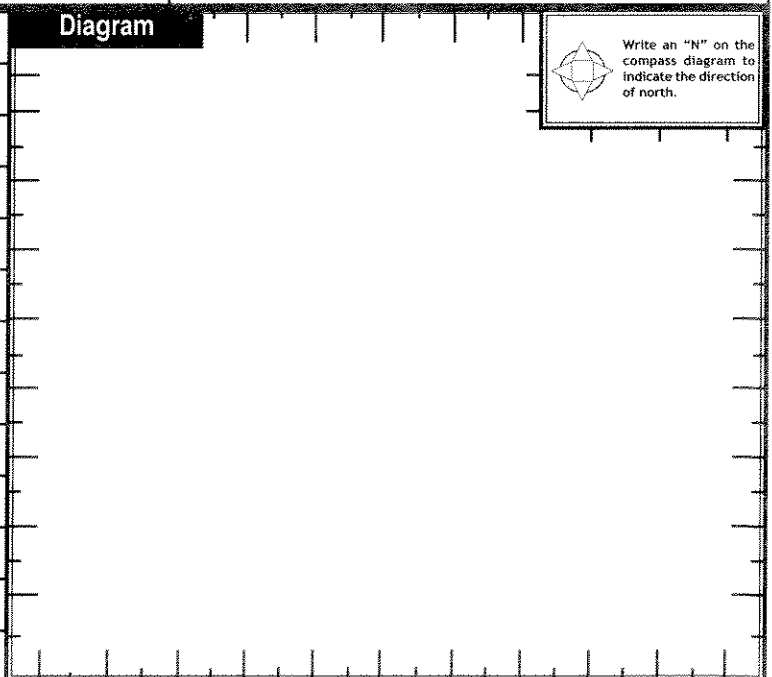

REPORT TAKEN BY <input checked="" type="checkbox"/> POLICE AGENCY <input type="checkbox"/> MOTORIST	SUPPLEMENT (CORRECTION OR ADDITION TO AN EXISTING REPORT SENT TO ODPS) <input type="checkbox"/>	DATE CRASH REPORTED 05292013	TIME CRASH REPORTED 2009	DISPATCH TIME 2010	ARRIVAL TIME 2014	TIME CLEARED 2041	OTHER INVESTIGATION TIME 30	TOTAL MINUTES 61
OFFICER'S NAME * ERIC FITZGERALD	OFFICER'S BADGE NUMBER 1637	CHECKED BY 1041	PAGE 1 OF 4					



# MOTORIST / Non-MOTORIST / OCCUPANT

LOCAL REPORT NUMBER  
2013-15167

MOTORIST/Non-MOTORIST

UNIT NUMBER 01	NAME: LAST, FIRST, MIDDLE UNKNOWN	DATE OF BIRTH	AGE	GENDER F - FEMALE M - MALE						
ADDRESS, CITY, STATE, ZIP			CONTACT PHONE- INCLUDE AREA CODE							
INJURIES	INJURED TAKEN BY	EMS AGENCY	MEDICAL FACILITY INJURED TAKEN TO	SAFETY EQUIPMENT USED	DOT COMPLIANT <input type="checkbox"/> MOTORCYCLE <input type="checkbox"/> HELMET	SEATING POSITION	AIR BAG USAGE	EJECTION	TRAPPED	
OL STATE	OPERATOR LICENSE NUMBER	OL CLASS	No <input type="checkbox"/> VALID OL M/C <input type="checkbox"/> END.	CONDITION	ALCOHOL/DRUG SUSPECTED	ALCOHOL TEST STATUS	ALCOHOL TEST TYPE	ALCOHOL TEST VALUE	DRUG TEST STATUS	DRUG TEST TYPE
OFFENSE CHARGED ( <input type="checkbox"/> LOCAL CODE)		OFFENSE DESCRIPTION			CITATION NUMBER	HANDS-FREE <input type="checkbox"/> DEVICE USED		DRIVER DISTRACTED BY		

MOTORIST/Non-MOTORIST

UNIT NUMBER 02	NAME: LAST, FIRST, MIDDLE UNOCCUPIED	DATE OF BIRTH	AGE	GENDER F - FEMALE M - MALE						
ADDRESS, CITY, STATE, ZIP			CONTACT PHONE- INCLUDE AREA CODE							
INJURIES	INJURED TAKEN BY	EMS AGENCY	MEDICAL FACILITY INJURED TAKEN TO	SAFETY EQUIPMENT USED	DOT COMPLIANT <input type="checkbox"/> MOTORCYCLE <input type="checkbox"/> HELMET	SEATING POSITION	AIR BAG USAGE	EJECTION	TRAPPED	
OL STATE	OPERATOR LICENSE NUMBER	OL CLASS	No <input type="checkbox"/> VALID OL M/C <input type="checkbox"/> END.	CONDITION	ALCOHOL/DRUG SUSPECTED	ALCOHOL TEST STATUS	ALCOHOL TEST TYPE	ALCOHOL TEST VALUE	DRUG TEST STATUS	DRUG TEST TYPE
OFFENSE CHARGED ( <input type="checkbox"/> LOCAL CODE)		OFFENSE DESCRIPTION			CITATION NUMBER	HANDS-FREE <input type="checkbox"/> DEVICE USED		DRIVER DISTRACTED BY		

INJURIES	INJURED TAKEN BY	SAFETY EQUIPMENT USED	99 - UNKNOWN SAFETY EQUIPMENT	Non-MOTORIST	12 - REFLECTIVE CLOTHING
1 - NO INJURY / NONE REPORTED	1 - NOT TRANSPORTED / TREATED AT SCENE	MOTORIST	01 - NONE USED - VEHICLE OCCUPANT	09 - NONE USED	13 - LIGHTING
2 - POSSIBLE	2 - EMS	02 - SHOULDER BELT ONLY USED	05 - CHILD RESTRAINT SYSTEM-FORWARD FACING	10 - HELMET USED	14 - OTHER
3 - NON-INCAPACITATING	3 - POLICE	03 - LAP BELT ONLY USED	06 - CHILD RESTRAINT SYSTEM-REAR FACING	11 - PROTECTIVE PADS USED (ELBOWS, KNEES, ETC)	
4 - INCAPACITATING	4 - OTHER	04 - SHOULDER AND LAP BELT USED	07 - BOOSTER SEAT		
5 - FATAL	9 - UNKNOWN		08 - HELMET USED		

SEATING POSITION	AIR BAG USAGE
01 - FRONT - LEFT SIDE (MOTORCYCLE DRIVER)	1 - NOT DEPLOYED
02 - FRONT - MIDDLE	2 - DEPLOYED FRONT
03 - FRONT - RIGHT SIDE	3 - DEPLOYED SIDE
04 - SECOND - LEFT SIDE (MOTORCYCLE PASSENGER)	4 - DEPLOYED BOTH FRONT/SIDE
05 - SECOND - MIDDLE	5 - NOT APPLICABLE
06 - SECOND - RIGHT SIDE	9 - DEPLOYMENT UNKNOWN
07 - THIRD - LEFT SIDE (MOTORCYCLE SIDE CAR)	
08 - THIRD - MIDDLE	
09 - THIRD - RIGHT SIDE	
10 - SLEEPER SECTION OF CAB (TRUCK)	
11 - PASSENGER IN OTHER ENCLOSED CARGO AREA (Non-Trailing Unit Such as a Bus, Pick-up with Cab)	
12 - PASSENGER IN UNENCLOSED CARGO AREA	
13 - TRAILING UNIT	
14 - RIDING ON VEHICLE EXTERIOR (NON-TRAILING UNIT)	
15 - Non-MOTORIST	
16 - OTHER	
99 - UNKNOWN	

EJECTION	TRAPPED	OPERATOR LICENSE CLASS	CONDITION	5 - FELL ASLEEP, FAINTED, FATIGUED	ALCOHOL/DRUG SUSPECTED
1 - NOT EJECTED	1 - NOT TRAPPED	1 - CLASS A	1 - APPARENTLY NORMAL	6 - UNDER THE INFLUENCE OF MEDICATIONS, DRUGS, ALCOHOL	1 - NONE
2 - TOTALLY EJECTED	2 - EXTRICATED BY MECHANICAL MEANS	2 - CLASS B	2 - PHYSICAL IMPAIRMENT	7 - OTHER	2 - YES - ALCOHOL SUSPECTED
3 - PARTIALLY EJECTED	3 - EXTRICATED BY NON-MECHANICAL MEANS	3 - CLASS C	3 - EMOTIONAL (DEPRESSED, ANGRY, DISTURBED)		3 - YES - HBD NOT IMPAIRED
4 - NOT APPLICABLE		4 - REGULAR CLASS (OHHS IS "D")	4 - ILLNESS		4 - YES - DRUGS SUSPECTED
		5 - MC/MORED ONLY			5 - YES - ALCOHOL AND DRUGS SUSPECTED

ALCOHOL TEST STATUS	ALCOHOL TEST TYPE	DRUG TEST STATUS	DRUG TEST TYPE	DRIVER DISTRACTED BY
1 - NONE GIVEN	1 - NONE	1 - NONE GIVEN	1 - NONE	1 - NO DISTRACTION REPORTED
2 - TEST REFUSED	2 - BLOOD	2 - TEST REFUSED	2 - BLOOD	2 - PHONE
3 - TEST GIVEN, CONTAMINATED SAMPLE/UNUSABLE	3 - URINE	3 - TEST GIVEN, CONTAMINATED SAMPLE/UNUSABLE	3 - URINE	3 - TEXTING/E-MAILING
4 - TEST GIVEN, RESULTS KNOWN	4 - BREATH	4 - TEST GIVEN, RESULTS KNOWN	4 - OTHER	4 - ELECTRONIC COMMUNICATION DEVICE
5 - TEST GIVEN, RESULTS UNKNOWN	5 - OTHER	5 - TEST GIVEN, RESULTS UNKNOWN		5 - OTHER ELECTRONIC DEVICE (NAVIGATION DEVICE, RADIO, DVD)
				6 - OTHER INSIDE THE VEHICLE
				7 - EXTERNAL DISTRACTION

OCCUPANT

UNIT NUMBER	NAME: LAST, FIRST, MIDDLE	DATE OF BIRTH	AGE	GENDER F - FEMALE M - MALE					
ADDRESS, CITY, STATE, ZIP			CONTACT PHONE- INCLUDE AREA CODE						
INJURIES	INJURED TAKEN BY	EMS AGENCY	MEDICAL FACILITY INJURED TAKEN TO	SAFETY EQUIPMENT USED	DOT COMPLIANT <input type="checkbox"/> MOTORCYCLE <input type="checkbox"/> HELMET	SEATING POSITION	AIR BAG USAGE	EJECTION	TRAPPED

OCCUPANT

UNIT NUMBER	NAME: LAST, FIRST, MIDDLE	DATE OF BIRTH	AGE	GENDER F - FEMALE M - MALE					
ADDRESS, CITY, STATE, ZIP			CONTACT PHONE- INCLUDE AREA CODE						
INJURIES	INJURED TAKEN BY	EMS AGENCY	MEDICAL FACILITY INJURED TAKEN TO	SAFETY EQUIPMENT USED	DOT COMPLIANT <input type="checkbox"/> MOTORCYCLE <input type="checkbox"/> HELMET	SEATING POSITION	AIR BAG USAGE	EJECTION	TRAPPED

UNIT NUMBER 01	OWNER NAME: LAST, FIRST, MIDDLE ( <input type="checkbox"/> SAME AS DRIVER ) UNKNOWN	OWNER PHONE NUMBER - INC. AREA CODE ( <input type="checkbox"/> SAME AS DRIVER )	DAMAGE SCALE 9	DAMAGED AREA FRONT
OWNER ADDRESS: CITY, STATE, ZIP ( <input type="checkbox"/> SAME AS DRIVER )			1 - NONE	
LP STATE	LICENSE PLATE NUMBER	VEHICLE IDENTIFICATION NUMBER	2 - MINOR	
VEHICLE YEAR	VEHICLE MAKE	VEHICLE MODEL	3 - FUNCTIONAL	
VEHICLE COLOR	INSURANCE COMPANY	POLICY NUMBER	4 - DISABLING	
<input type="checkbox"/> PROOF OF INSURANCE SHOWN	TOWED BY	CARRIER NAME, ADDRESS, CITY, STATE, ZIP	9 - UNKNOWN	REAR

US DOT	VEHICLE WEIGHT GVWR/GCWR 1 - LESS THAN OR EQUAL TO 10K LBS. 2 - 10,001 TO 26,000 LBS. 3 - MORE THAN 26,000 LBS.	CARGO BODY TYPE 99	TRAFFICWAY DESCRIPTION 1 - TWO-WAY, NOT DIVIDED 2 - TWO-WAY, NOT DIVIDED, CONTINUOUS LEFT TURN LANE 3 - TWO-WAY, DIVIDED, UNPROTECTED (PAINTED OR GRASS >4 FT.) MEDIAN 4 - TWO-WAY, DIVIDED, POSITIVE MEDIAN BARRIER 5 - ONE-WAY TRAFFICWAY
HM PLACARD ID NO.	<input type="checkbox"/> HAZARDOUS MATERIAL RELEASED	01 - NO CARGO BODY TYPE/NOT APPLICABLE 02 - BUS/VAN (9-15 SEATS, INC DRIVER) 03 - BUS (16+ SEATS, INC DRIVER) 04 - VEHICLE TOWING ANOTHER VEHICLE 05 - LOGGING 06 - INTERMODAL CONTAINER CHASSIS 07 - CARGO VAN/ENCLOSED BOX 08 - GRAIN, CHIPS, GRAVEL 09 - POLE 10 - CARGO TANK 11 - FLAT BED 12 - DUMP 13 - CONCRETE MIXER 14 - AUTO TRANSPORTER 15 - GARBAGE/REFUSE 99 - OTHER/UNKNOWN	<input type="checkbox"/> HIT / SKIP UNIT
HM CLASS NUMBER			

NON-MOTORIST LOCATION PRIOR TO IMPACT 01 - INTERSECTION - MARKED CROSSWALK 02 - INTERSECTION - NO CROSSWALK 03 - INTERSECTION - OTHER 04 - MIDBLOCK - MARKED CROSSWALK 05 - TRAVEL LANE - OTHER LOCATION 06 - BICYCLE LANE 07 - SHOULDER/ROADSIDE 08 - SIDEWALK 09 - MEDIAN/CROSSING ISLAND 10 - DRIVEWAY ACCESS 11 - SHARED-USE PATH OR TRAIL 12 - NON-TRAFFICWAY AREA 99 - OTHER/UNKNOWN	TYPE OF USE 1 - PERSONAL 2 - COMMERCIAL 3 - GOVERNMENT <input type="checkbox"/> IN EMERGENCY RESPONSE	UNIT TYPE 99 99 - UNKNOWN OR HIT / SKIP	PASSENGER VEHICLES (LESS THAN 9 PASSENGERS) 01 - SUB-COMPACT 02 - COMPACT 03 - MID SIZE 04 - FULL SIZE 05 - MINIVAN 06 - SPORT UTILITY VEHICLE 07 - PICKUP 08 - VAN 09 - MOTORCYCLE 10 - MODIFIED BICYCLE 11 - SNOWMOBILE/ATV 12 - OTHER PASSENGER VEHICLE	MED/HEAVY TRUCKS OR COMBO UNITS > 10K LBS 13 - SINGLE UNIT TRUCK OR VAN 2AXLE, 6 TYRES 14 - SINGLE UNIT TRUCK; 3+ AXLES 15 - SINGLE UNIT TRUCK / TRAILER 16 - TRUCK/TRACTOR (BOBTAIL) 17 - TRACTOR/SEMI-TRAILER 18 - TRACTOR/DOUBLE 19 - TRACTOR/TripLES 20 - OTHER MED/HEAVY VEHICLE	BUS/VAN/LIMO (9 OR MORE INCLUDING DRIVER) 21 - BUS/VAN (9-15 SEATS, INC DRIVER) 22 - BUS (16+ SEATS, INC DRIVER) NON-MOTORIST 23 - ANIMAL WITH RIDER 24 - ANIMAL WITH BUCKY, WAGON, SUREVY 25 - BICYCLE/PEDALCYLIST 26 - PEDESTRIAN/SCATER 27 - OTHER NON-MOTORIST
			<input type="checkbox"/> HAS HM PLACARD		

SPECIAL FUNCTION 01 - NONE 02 - TAXI 03 - RENTAL TRUCK (OVER 10K LBS) 04 - BUS - SCHOOL (PUBLIC OR PRIVATE) 05 - BUS - TRANSIT 06 - BUS - CHARTER 07 - BUS - SHUTTLE 08 - BUS - OTHER 09 - AMBULANCE 10 - FIRE 11 - HIGHWAY/MAINTENANCE 12 - MILITARY 13 - POLICE 14 - PUBLIC UTILITY 15 - OTHER GOVERNMENT 16 - CONSTRUCTION EQUIP. 17 - FARM VEHICLE 18 - FARM EQUIPMENT 19 - MOTORHOME 20 - GOLF CART 21 - TRAIN 22 - OTHER (EXPLAIN IN NARRATIVE)	MOST DAMAGED AREA 99 01 - NONE 02 - CENTER FRONT 03 - RIGHT FRONT 04 - RIGHT SIDE 05 - RIGHT REAR 06 - REAR CENTER 07 - LEFT REAR	IMPACT AREA 99	08 - LEFT SIDE 09 - LEFT FRONT 10 - TOP AND WINDOWS 11 - UNDERCARRIAGE 12 - LOAD/TRAILER 13 - TOTAL/ALL AREA 14 - OTHER	ACTION 3 1 - NON-CONTACT 2 - NON-COLLISION 3 - STRIKING 4 - STRUCK 5 - STRIKING/STRUCK 9 - UNKNOWN
---	---	-------------------	---	---

PRE-CRASH ACTIONS 99 99 - UNKNOWN	MOTORIST 01 - STRAIGHT AHEAD 02 - BACKING 03 - CHANGING LANES 04 - OVERTAKING/PASSING 05 - MAKING RIGHT TURN 06 - MAKING LEFT TURN 07 - MAKING U-TURN 08 - ENTERING TRAFFIC LANE 09 - LEAVING TRAFFIC LANE 10 - PARKED 11 - SLOWING OR STOPPED IN TRAFFIC 12 - DRIVELESS	NON-MOTORIST 13 - NEGOTIATING A CURVE 14 - OTHER MOTORIST ACTION 15 - ENTERING OR CROSSING SPECIFIED LOCATION 16 - WALKING, RUNNING, JOGGING, PLAYING, CYCLING 17 - WORKING 18 - PUSHING VEHICLE 19 - APPROACHING OR LEAVING VEHICLE 20 - STANDING 21 - OTHER NON-MOTORIST ACTION
---	--	--

CONTRIBUTING CIRCUMSTANCES PRIMARY 99 99 - UNKNOWN	MOTORIST 01 - NONE 02 - FAILURE TO YIELD 03 - RAN RED LIGHT 04 - RAN STOP SIGN 05 - EXCEEDED SPEED LIMIT 06 - UNSAFE SPEED 07 - IMPROPER TURN 08 - LEFT OF CENTER 09 - FOLLOWED TOO CLOSELY/ACDA 10 - IMPROPER LANE CHANGE /PASSING/OFF ROAD 11 - IMPROPER BACKING 12 - IMPROPER START FROM PARKED POSITION 13 - STOPPER OR PARKED ILLEGALLY 14 - OPERATING VEHICLE IN NEGLIGENT MANNER 15 - SWERVING TO AVOID (DUE TO EXTERNAL CONDITIONS) 16 - WRONG SIDE/WRONG WAY 17 - FAILURE TO CONTROL 18 - VISION OBSTRUCTION 19 - OPERATING DEFECTIVE EQUIPMENT 20 - LOAD SHIFTING/FALLING/SPILLING 21 - OTHER IMPROPER ACTION	NON-MOTORIST 22 - NONE 23 - IMPROPER CROSSING 24 - DARTING 25 - LYING AND/OR ILLEGALLY IN ROADWAY 26 - FAILURE TO YIELD RIGHT OF WAY 27 - NOT VISIBLE (DARK CLOTHING) 28 - INATTENTIVE 29 - FAILURE TO OBEY TRAFFIC SIGNS /SIGNALS/OFFICER 30 - WRONG SIDE OF THE ROAD 31 - OTHER NON-MOTORIST ACTION	VEHICLE DEFECTS 01 - TURN SIGNALS 02 - HEAD LAMPS 03 - TAIL LAMPS 04 - BRAKES 05 - STEERING 06 - TIRE BLOWOUT 07 - WORN OR SLICK TIRES 08 - TRAILER EQUIPMENT DEFECTIVE 09 - MOTOR TROUBLE 10 - DISABLED FROM PRIOR ACCIDENT 11 - OTHER DEFECTS
---	--	---	--

SEQUENCE OF EVENTS 1 21 2 3 4 5 6 FIRST HARMFUL EVENT 11 MOST HARMFUL EVENT 11 99 - UNKNOWN	NON-COLLISION EVENTS 01 - OVERTURN/Rollover 02 - FIRE/EXPLOSION 03 - IMMERSION 04 - JACKKNIFE 05 - CARGO/EQUIPMENT LOSS OR SHIFT 06 - EQUIPMENT FAILURE (BLOW TIRE, BRAKE FAILURE, ETC) 07 - SEPARATION OF UNITS 08 - RAN OFF ROAD RIGHT 09 - RAN OFF ROAD LEFT 10 - CROSS MEDIAN 11 - CROSS CENTER LINE OPPOSITE DIRECTION OF TRAVEL 12 - DOWNHILL RUNAWAY 13 - OTHER NON-COLLISION
---	---

COLLISION WITH PERSON, VEHICLE OR OBJECT NOT FIRES 14 - PEDESTRIAN 15 - PEDALCYCLE 16 - RAILWAY VEHICLE (TRAIN, ENGINE) 17 - ANIMAL - FARM 18 - ANIMAL - DEER 19 - ANIMAL - OTHER 20 - MOTOR VEHICLE IN TRANSPORT 21 - PARKED MOTOR VEHICLE 22 - WORK ZONE MAINTENANCE EQUIPMENT 23 - STRUCK BY FALLING, SHIFTING CARGO OR ANYTHING SET IN MOTION BY A MOTOR VEHICLE 24 - OTHER MOVABLE OBJECT 25 - IMPACT ATTENUATOR/CRASH CUSHION 26 - BRIDGE OVERHEAD STRUCTURE 27 - BRIDGE PIER OR ABUTMENT 28 - BRIDGE PARAPET 29 - BRIDGE RAIL 30 - GUARDRAIL FACE 31 - GUARDRAIL END 32 - PORTABLE BARRIER 33 - MEDIAN CABLE BARRIER 34 - MEDIAN GUARDRAIL BARRIER 35 - MEDIAN CONCRETE BARRIER 36 - MEDIAN OTHER BARRIER 37 - TRAFFIC SIGN POST 38 - OVERHEAD SIGN POST 39 - LIGHT/LUMINARIES SUPPORT 40 - UTILITY POLE 41 - OTHER POST, POLE OR SUPPORT 42 - CULVERT 43 - CURB 44 - DITCH 45 - EMBANKMENT 46 - FENCE 47 - MAILBOX 48 - TREE 49 - FIRE HYDRANT 50 - WORK ZONE MAINTENANCE EQUIPMENT 51 - WALL, BUILDING, TUNNEL 52 - OTHER FIXED OBJECT
--

UNIT SPEED 15 <input type="checkbox"/> STATED <input checked="" type="checkbox"/> ESTIMATED	POSTED SPEED 25	TRAFFIC CONTROL 01 - NO CONTROLS 02 - STOP SIGN 03 - YIELD SIGN 04 - TRAFFIC SIGNAL 05 - TRAFFIC FLASHERS 06 - SCHOOL ZONE 07 - RAILROAD CROSSBUCKS 08 - RAILROAD FLASHERS 09 - RAILROAD GATES 10 - CONSTRUCTION BARRICADE 11 - PERSON (FLAGGER, OFFICER) 12 - PAVEMENT MARKINGS 13 - CROSSWALK LINES 14 - WALK/DON'T WALK 15 - OTHER 16 - NOT REPORTED	UNIT DIRECTION FROM 9 TO 9 1 - NORTH 2 - SOUTH 3 - EAST 4 - WEST 5 - NORTHEAST 6 - NORTHWEST 7 - SOUTHEAST 8 - SOUTHWEST 9 - UNKNOWN
--	--------------------	---	--



# UNIT

LOCAL REPORT NUMBER

2013-15167

UNIT NUMBER 02	OWNER NAME: LAST, FIRST, MIDDLE ( <input type="checkbox"/> SAME AS DRIVER ) ESLER WILDA	OWNER PHONE NUMBER - INC. AREA CODE ( <input type="checkbox"/> SAME AS DRIVER ) 513-608-2150	DAMAGE SCALE 3	DAMAGED AREA FRONT 09 03 08 10 04 07 06 05 REAR
OWNER ADDRESS: CITY, STATE, ZIP ( <input type="checkbox"/> SAME AS DRIVER ) 7646 LAKE POINTE ST MAINVILLE OH 45039				
LP STATE OH	LICENSE PLATE NUMBER BGK 493Z	VEHICLE IDENTIFICATION NUMBER 119UUA564J3XA03961H	# OCCUPANTS 00	
VEHICLE YEAR 119919	VEHICLE MAKE ACURA	VEHICLE MODEL J.2 TL	VEHICLE COLOR SILVER	
<input type="checkbox"/> PROOF OF INSURANCE SHOWN	INSURANCE COMPANY STATE FARM	POLICY NUMBER C064667F0135H	TOWED BY	
CARRIER NAME, ADDRESS, CITY, STATE, ZIP			CARRIER PHONE - INCLUDE AREA CODE	

US DOT	VEHICLE WEIGHT GVWR/GCWR 1 - LESS THAN OR EQUAL TO 10K LBS. 2 - 10,001 TO 26,000 LBS. 3 - MORE THAN 26,000 LBS.	CARGO BODY TYPE 01 - NO CARGO BODY TYPE/NOT APPLICABLE 02 - BUS/VAN (9-15 SEATS, INC DRIVER) 03 - BUS (16+ SEATS, INC DRIVER) 04 - VEHICLE TOWING ANOTHER VEHICLE 05 - LOGGING 06 - INTERMODAL CONTAINER CHASSIS 07 - CARGO VAN/ENCLOSED BOX 08 - GRAB, CHIPS, GRAVEL	09 - PCLT 10 - CARGO TANK 11 - FLAT BED 12 - DUMP 13 - CONCRETE MIXER 14 - AUTO TRANSPORTER 15 - GARBAGE/REFUSE 99 - OTHER/UNKNOWN	TRAFFICWAY DESCRIPTION 1 - TWO-WAY, NOT DIVIDED 2 - TWO-WAY, NOT DIVIDED, CONTINUOUS LEFT TURN LANE 3 - TWO-WAY, DIVIDED, UNPROTECTED (PAVING OR GRASS >4 FT.) MEDIAN 4 - TWO-WAY, DIVIDED, POSITIVE MEDIAN BARRIER 5 - ONE-WAY TRAFFICWAY
HM PLACARD ID NO.	<input type="checkbox"/> HAZARDOUS MATERIAL RELEASED			<input type="checkbox"/> HIT / SKIP UNIT

NON-MOTORIST LOCATION PRIOR TO IMPACT 01 - INTERSECTION - MARKED CROSSWALK 02 - INTERSECTION - NO CROSSWALK 03 - INTERSECTION - OTHER 04 - MIDBLOCK - MARKED CROSSWALK 05 - TRAVEL LANE - OTHER LOCATION 06 - BICYCLE LANE 07 - SHOULDER/ROADSIDE 08 - SIDEWALK 09 - MEDIAN/CROSSING ISLAND 10 - DRIVEWAY ACCESS 11 - SHARED-USE PATH OR TRAIL 12 - NON-TRAFFICWAY AREA 99 - OTHER/UNKNOWN	TYPE OF USE 1 - PERSONAL 2 - COMMERCIAL 3 - GOVERNMENT <input type="checkbox"/> IN EMERGENCY RESPONSE	UNIT TYPE 03 99 - UNKNOWN OR HIT / SKIP	PASSENGER VEHICLES (LESS THAN 9 PASSENGERS) 01 - SUB-COMPACT 02 - COMPACT 03 - MID SIZE 04 - FULL SIZE 05 - MINIVAN 06 - SPORT UTILITY VEHICLE 07 - PICKUP 08 - VAN 09 - MOTORCYCLE 10 - MOTORIZED BICYCLE 11 - SNOWMOBILE/ATV 12 - OTHER PASSENGER VEHICLE	MED/HEAVY TRUCKS OR COMBO UNITS > 10K LBS 13 - SINGLE UNIT TRUCK OR VAN ZAXLE, 6 TIRES 14 - SINGLE UNIT TRUCK; 3+ AXLES 15 - SINGLE UNIT TRUCK / TRAILER 16 - TRUCK/TRACTOR (BOBTAIL) 17 - TRACTOR/SEMI-TRAILER 18 - TRACTOR/DOUBLE 19 - TRACTOR/TRIPLES 20 - OTHER MED/HEAVY VEHICLE	BUS/VAN/LIMO (9 OR MORE INCLUDING DRIVER) 21 - BUS/VAN (9-15 SEATS, INC DRIVER) 22 - BUS (16+ SEATS, INC DRIVER) NON-MOTORIST 23 - ANIMAL WITH RIDER 24 - ANIMAL WITH BUGGY, WAGON, SURETY 25 - BICYCLE/PEDALCYCLIST 26 - PEDESTRIAN/SKATER 27 - OTHER NON-MOTORIST
			<input type="checkbox"/> HAS HM PLACARD		

SPECIAL FUNCTION 01 - NONE 02 - TAXI 03 - RENTAL TRUCK (OVER 10K LBS) 04 - BUS - SCHOOL (PUBLIC OR PRIVATE) 05 - BUS - TRANSIT 06 - BUS - CHARTER 07 - BUS - SHUTTLE 08 - BUS - OTHER	09 - AMBLANCE 10 - FIRE 11 - HIGHWAY/MAINTENANCE 12 - MILITARY 13 - POLICE 14 - PUBLIC UTILITY 15 - OTHER GOVERNMENT 16 - CONSTRUCTION EQUIP.	17 - FARM VEHICLE 18 - FARM EQUIPMENT 19 - MOTORHOME 20 - GOLF CART 21 - TRAIN 22 - OTHER (EXPLAIN IN NARRATIVE)	MOST DAMAGED AREA 08 08	01 - NONE 02 - CENTER FRONT 03 - RIGHT FRONT 04 - RIGHT SIDE 05 - RIGHT REAR 06 - REAR CENTER 07 - LEFT REAR	08 - LEFT SIDE 09 - LEFT FRONT 10 - TOP AND WINDOWS 11 - UNDERCARRIAGE 12 - LOAD/TRAILER 13 - TOTAL/LAD AHEAD 14 - OTHER	ACTION 4	1 - NON-CONTACT 2 - NON-COLLISION 3 - STRIKING 4 - STRUCK 5 - STRIKING/STRUCK 9 - UNKNOWN
---	--	---	-------------------------------	--	--	-------------	--

PRE-CRASH ACTIONS 10	MOTORIST 01 - STRAIGHT AHEAD 02 - BACKING 03 - CHANGING LANES 04 - OVERTAKING/PASSING 05 - MAKING RIGHT TURN 06 - MAKING LEFT TURN 99 - UNKNOWN	07 - MAKING U-TURN 08 - ENTERING TRAFFIC LANE 09 - LEAVING TRAFFIC LANE 10 - PARKED 11 - SLOWING OR STOPPED IN TRAFFIC 12 - DRIVERLESS	13 - NEGOTIATING A CURVE 14 - OTHER MOTORIST ACTION	NON-MOTORIST 15 - ENTERING OR CROSSING SPECIFIED LOCATION 16 - WALKING, RUNNING, JOGGING, PLAYING, CYCLING 17 - WORKING 18 - PUSHING VEHICLE 19 - APPROACHING OR LEAVING VEHICLE 20 - STANDING 21 - OTHER NON-MOTORIST ACTION
-------------------------	--	---	--	--

CONTRIBUTING CIRCUMSTANCES PRIMARY 01	MOTORIST 01 - NONE 02 - FAILURE TO YIELD 03 - RAN RED LIGHT 04 - RAN STOP SIGN 05 - EXCEEDED SPEED LIMIT 06 - UNSAFE SPEED 07 - IMPROPER TURN 08 - LEFT OF CENTER 09 - FOLLOWED TOO CLOSELY/ACDA 10 - IMPROPER LANE CHANGE /PASSING/OFF ROAD 11 - IMPROPER BACKING 12 - IMPROPER START FROM PARKED POSITION 13 - STOPPED OR PARKED ILLEGALLY 14 - OPERATING VEHICLE IN NEGLIGENT MANNER 15 - SWERVING TO AVOID (DUE TO EXTERNAL CONDITIONS) 16 - WRONG SIDE/WRONG WAY 17 - FAILURE TO CONTROL 18 - VISION OBSTRUCTION 19 - OPERATING DEFECTIVE EQUIPMENT 20 - LOAD SHIFTING/FALLING/SPILLING 21 - OTHER IMPROPER ACTION	NON-MOTORIST 22 - NONE 23 - IMPROPER CROSSING 24 - DARTING 25 - LYING AND/OR ILLEGALLY IN ROADWAY 26 - FAILURE TO YIELD RIGHT OF WAY 27 - NOT VISIBLE (DARK CLOTHING) 28 - INATTENTIVE 29 - FAILURE TO OBEY TRAFFIC SIGNS /SIGNALS/OFFICER 30 - WRONG SIDE OF THE ROAD 31 - OTHER NON-MOTORIST ACTION	VEHICLE DEFECTS 01 - TURN SIGNALS 02 - HEAD LAMPS 03 - TAIL LAMPS 04 - BRAKES 05 - STEERING 06 - TIRE BLOWOUT 07 - WORN OR SLICK TIRES 08 - TRAILER EQUIPMENT DEFECTIVE 09 - MOTOR TROUBLE 10 - DISABLED FROM PRIOR ACCIDENT 11 - OTHER DEFECTS
---	--	---	--

SEQUENCE OF EVENTS 1 20 2 3 4 5 6 FIRST HARMFUL EVENT 1 MOST HARMFUL EVENT 1 99 - UNKNOWN	NON-COLLISION EVENTS 01 - OVERTURN/ROLLOVER 02 - FIRE/EXPLOSION 03 - IMMERSION 04 - JACKKNIFE 05 - CARGO/EQUIPMENT LOSS OR SHIFT 06 - EQUIPMENT FAILURE (BLOWN TIRE, BRAKE FAILURE, ETC) 07 - SEPARATION OF UNITS 08 - RAN OFF ROAD RIGHT 09 - RAN OFF ROAD LEFT 10 - CROSS MEDIAN 11 - CROSS CENTER LINE OPPOSITE DIRECTION OF TRAVEL 12 - DOWNHILL RUNAWAY 13 - OTHER NON-COLLISION	COLLISION WITH PERSON, VEHICLE OR OBJECT NOT FIXED 14 - PEDESTRIAN 15 - PEDALCYCLE 16 - RAILWAY VEHICLE (TRAIN, ENGINE) 17 - ANIMAL - FARM 18 - ANIMAL - DEER 19 - ANIMAL - OTHER 20 - MOTOR VEHICLE IN TRANSPORT 21 - PARKED MOTOR VEHICLE 22 - WORK ZONE MAINTENANCE EQUIPMENT 23 - STRUCK BY FALLING, SHIFTING CARGO OR ANYTHING SET IN MOTION BY A MOTOR VEHICLE 24 - OTHER MOVABLE OBJECT 25 - IMPACT ATTENUATOR/CRASH CUSHION 26 - BRIDGE OVERHEAD STRUCTURE 27 - BRIDGE PIER OR ABUTMENT 28 - BRIDGE PARAPET 29 - BRIDGE RAIL 30 - GUARDRAIL FACE 31 - GUARDRAIL END 32 - PORTABLE BARRIER 33 - MEDIAN CABLE BARRIER 34 - MEDIAN GUARDRAIL BARRIER 35 - MEDIAN CONCRETE BARRIER 36 - MEDIAN OTHER BARRIER 37 - TRAFFIC SIGN POST 38 - OVERHEAD SIGN POST 39 - LIGHT/LUMINAIRIES SUPPORT 40 - UTILITY POLE 41 - OTHER POST, POLE OR SUPPORT 42 - CULVERT 43 - CURB 44 - DITCH 45 - EMBANKMENT 46 - FENCE 47 - MAILBOX 48 - TREE 49 - FIRE HYDRANT 50 - WORK ZONE MAINTENANCE EQUIPMENT 51 - WALL, BUILDING, TUNNEL 52 - OTHER FIXED OBJECT
--	--	---

UNIT SPEED 0	POSTED SPEED 25	TRAFFIC CONTROL 01 - NO CONTROLS 02 - STOP SIGN 03 - YIELD SIGN 04 - TRAFFIC SIGNAL 05 - TRAFFIC FLASHERS 06 - SCHOOL ZONE 07 - RAILROAD CROSSINGS 08 - RAILROAD FLASHERS 09 - RAILROAD GATES 10 - CONSTRUCTION BARRICADE 11 - PERSON (FLAGGER, OFFICER) 12 - PAVEMENT MARKINGS 13 - CROSSWALK LINES 14 - WALK/DONT WALK 15 - OTHER 16 - NOT REPORTED	UNIT DIRECTION FROM 4 TO J 1 - NORTH 2 - SOUTH 3 - EAST 4 - WEST 5 - NORTHEAST 6 - NORTHWEST 7 - SOUTHWEST 8 - SOUTHWEST 9 - UNKNOWN
-----------------	--------------------	---	--



LOCAL REPORT NUMBER 13-15167	REPORTING AGENCY MASON POLICE	DATE OF CRASH M 05   D 29   Y 13
IN COUNTY OF WARREN	CRASH LOCATION 3983 MARBLE RIDGE LN	

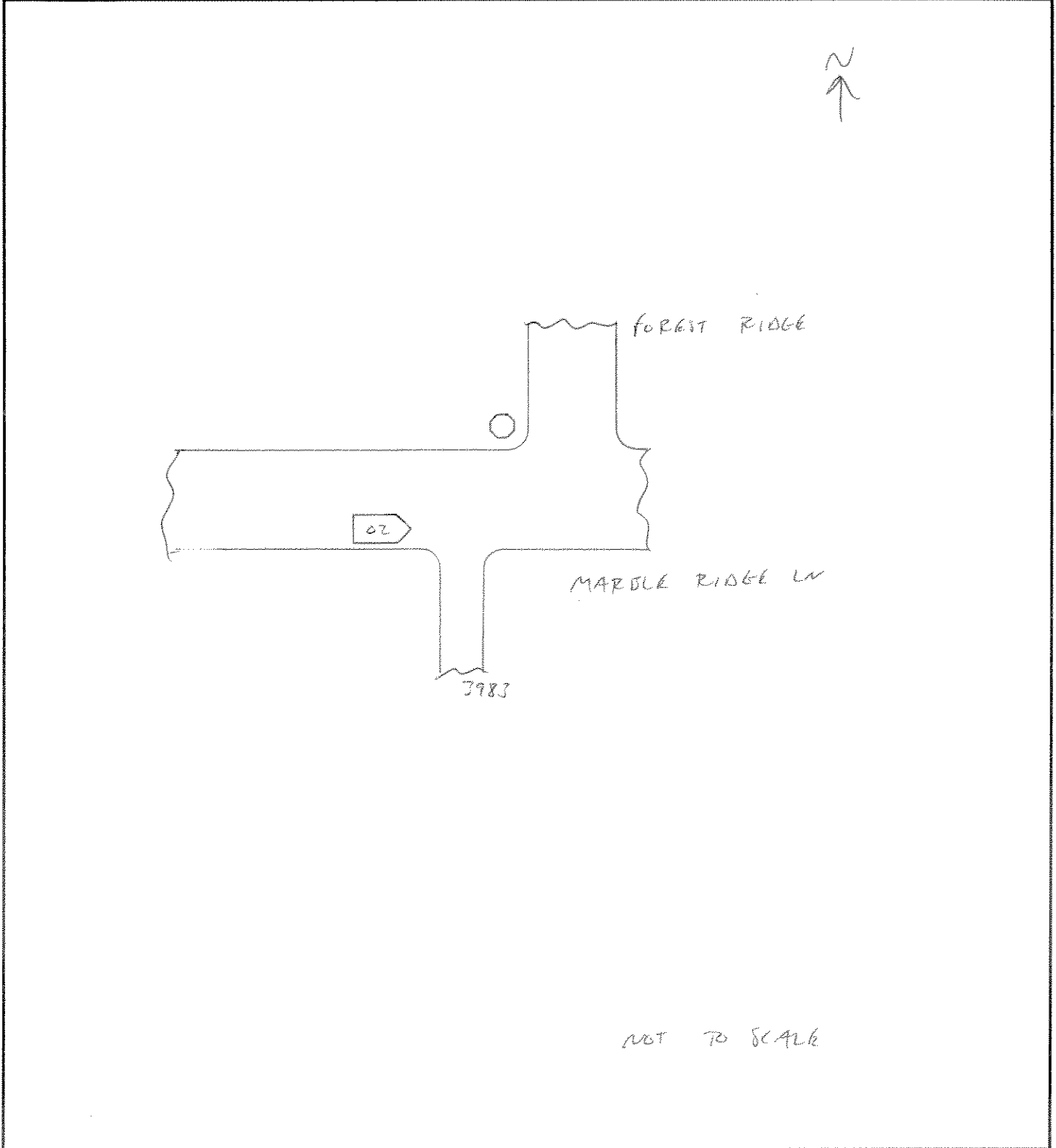

OFFICER'S SIGNATURE X [Signature]	BADGE NUMBER 1077
--------------------------------------	----------------------