



TRAFFIC CRASH REPORT

| | | |
|-----------------------|---|----------------------------|
| LOCAL REPORT NUMBER * | CRASH SEVERITY | HIT/SKIP |
| 12011500000032979 | 3 1 - FATAL 2 - INJURY 3 - PDO | 1 - SOLVED 2 - UNSOLVED |

| | | | | | | |
|--|--|------------------|-------------------------|-------------------------|-----------------|-----------------------------------|
| PHOTOS TAKEN <input checked="" type="checkbox"/> OH-2 <input type="checkbox"/> OH-1P <input checked="" type="checkbox"/> OH-3 <input type="checkbox"/> OTHER | PDO UNDER STATE REPORTABLE DOLLAR AMOUNT | PRIVATE PROPERTY | REPORTING AGENCY NCIC * | REPORTING AGENCY NAME * | NUMBER OF UNITS | UNIT IN ERROR |
| | | | 083104 | MASON PD | 102 | 01 98 - ANIMAL 99 - UNKNOWN |

| | | | | | |
|----------|--------|---------------------------|--------------|---------------|-------------|
| COUNTY * | CITY * | CITY, VILLAGE, TOWNSHIP * | CRASH DATE * | TIME OF CRASH | DAY OF WEEK |
| 183 | 183 | MASON | 11011820115 | 119211 | 15UN |

| | | | |
|---|----------------|-----------------------------|------------|
| DEGREES / MINUTES / SECONDS LATITUDE | LONGITUDE | DECIMAL DEGREES LATITUDE | LONGITUDE |
| 39° 22' 36.02" | 78° 41' 11.42" | 39.3768195 | 78.4208450 |

| | | | |
|---|--|----------------------|--|
| ROADWAY DIVISION | DIVIDED LANE DIRECTION OF TRAVEL | NUMBER OF THRU LANES | ROAD TYPES OR MILEPOST 2 |
| <input type="checkbox"/> DIVIDED <input checked="" type="checkbox"/> UNDIVIDED | <input type="checkbox"/> N - NORTHBOUND E - EASTBOUND <input type="checkbox"/> S - SOUTHBOUND W - WESTBOUND | 102 | AL - ALLEY CR - CIRCLE HE - HEIGHTS MP - MILEPOST PL - PLACE ST - STREET WA - WAY AV - AVENUE CT - COURT HW - HIGHWAY PK - PARKWAY RD - ROAD TE - TERRACE BL - BOULEVARD DR - DRIVE LA - LANE PI - PIKE SQ - SQUARE TL - TRAIL |

| | | | |
|-----------------------|--------------------|--------------------|--|
| LOCATION ROUTE NUMBER | LOC PREFIX N,S,E,W | LOCATION ROAD NAME | ROUTE TYPES 1 |
| SR 17411 | | BETHANY | IR - INTERSTATE ROUTE (INC. TURNPIKE) CR - NUMBERED COUNTY ROUTE US - US ROUTE TR - NUMBERED TOWNSHIP ROUTE SR - STATE ROUTE |

| | | | | | | |
|-------------------------|--------------|------------------------|------------------------|--------------------|--|-----------------------|
| DISTANCE FROM REFERENCE | DIR FROM REF | REFERENCE ROUTE TYPE 1 | REFERENCE ROUTE NUMBER | REF PREFIX N,S,E,W | REFERENCE NAME (ROAD, MILEPOST, HOUSE #) | REFERENCE ROAD TYPE 2 |
| 100 | 5 | | | | BETHANY | RD |

| | | |
|---|---|---|
| REFERENCE POINT USED | CRASH LOCATION | LOCATION OF FIRST HARMFUL EVENT |
| 1 - INTERSECTION 2 - MILE POST 3 - HOUSE NUMBER | 01 - NOT AN INTERSECTION 02 - FOUR-WAY INTERSECTION 03 - T-INTERSECTION 04 - Y-INTERSECTION 05 - TRAFFIC CIRCLE/ROUNDBOUNT 06 - FIVE-POINT, OR MORE 07 - ON RAMP 08 - OFF RAMP 09 - CROSSOVER 10 - DRIVEWAY/ALLEY ACCESS | 1 - ON ROADWAY 2 - ON SHOULDER 3 - IN MEDIAN 4 - ON ROADSIDE 5 - ON GORE 6 - OUTSIDE TRAFFICWAY 9 - UNKNOWN |

| | | |
|---|-------------------------|--|
| ROAD CONTOUR | ROAD CONDITIONS | WEATHER |
| 1 - STRAIGHT LEVEL 2 - STRAIGHT GRADE 3 - CURVE LEVEL 4 - CURVE GRADE 9 - UNKNOWN | PRIMARY 01 SECONDARY | 1 - CLEAR 2 - CLOUDY 3 - FOG, SMOG, SMOKE 4 - RAIN 5 - SLEET, HAIL 6 - SNOW 7 - SEVERE CROSSWINDS 8 - BLOWING SAND, SOIL, DIRT, SNOW 9 - OTHER/UNKNOWN |

| | |
|---|--|
| MANNER OF CRASH COLLISION/IMPACT | WEATHER |
| 1 - NOT COLLISION BETWEEN TWO MOTOR VEHICLES IN TRANSPORT 2 - REAR-END 3 - HEAD-ON 4 - REAR-TO-REAR 5 - BACKING 6 - ANGLE 7 - SIDESWIPE, SAME DIRECTION 8 - SIDESWIPE, OPPOSITE DIRECTION 9 - UNKNOWN | 1 - CLEAR 2 - CLOUDY 3 - FOG, SMOG, SMOKE 4 - RAIN 5 - SLEET, HAIL 6 - SNOW 7 - SEVERE CROSSWINDS 8 - BLOWING SAND, SOIL, DIRT, SNOW 9 - OTHER/UNKNOWN |

| | | |
|--|------------------------|--|
| ROAD SURFACE | LIGHT CONDITIONS | SCHOOL BUS RELATED |
| 1 - CONCRETE 2 - BLACKTOP, BITUMINOUS, ASPHALT 3 - BRICK/BLOCK 4 - SLAG, GRAVEL, STONE 5 - DIRT 6 - OTHER | PRIMARY 5 SECONDARY | <input type="checkbox"/> SCHOOL ZONE RELATED <input type="checkbox"/> YES, SCHOOL BUS DIRECTLY INVOLVED <input type="checkbox"/> YES, SCHOOL BUS INDIRECTLY INVOLVED |

| | | |
|---|--|---|
| WORK ZONE RELATED | TYPE OF WORK ZONE | LOCATION OF CRASH IN WORK ZONE |
| <input type="checkbox"/> WORKERS PRESENT <input type="checkbox"/> LAW ENFORCEMENT PRESENT (OFFICER/VEHICLE) <input type="checkbox"/> LAW ENFORCEMENT PRESENT (VEHICLE ONLY) | 1 - LANE CLOSURE 2 - LANE SHIFT/CROSSOVER 3 - WORK ON SHOULDER OR MEDIAN 4 - INTERMITTENT OR MOVING WORK 5 - OTHER | 1 - BEFORE THE FIRST WORK ZONE WARNING SIGN 2 - ADVANCE WARNING AREA 3 - TRANSITION AREA 4 - ACTIVITY AREA 5 - TERMINATION AREA |

NARRATIVE
 UNIT #2 WAS STOPPED AT A REDLIGHT, NORTHBOUND ON STATE ROUTE 741 @ BETHANY. UNIT #1 WAS TRAVELING NORTHBOUND ON STATE ROUTE 741 SOUTH OF BETHANY RD AND STRUCK UNIT #2 FROM THE REAR. THE TRAFFIC CRASH CAUSED MINOR DAMAGE TO BOTH VEHICLES.

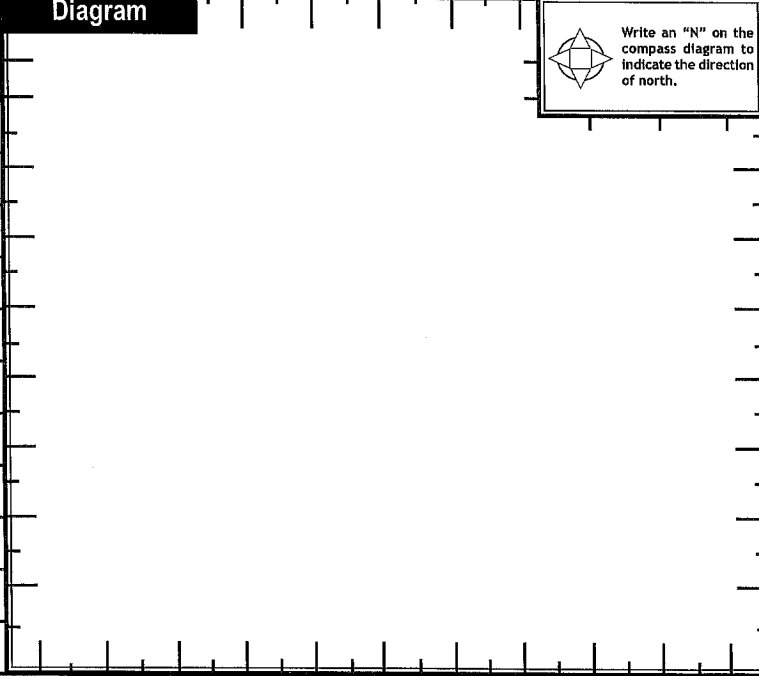

| | | | | | | | | |
|--|--|---------------------|---------------------|---------------|--------------|--------------|--------------------------|---------------|
| REPORT TAKEN BY | SUPPLEMENT (CORRECTION OR ADDITION TO AN EXISTING REPORT SENT TO ODPS) | DATE CRASH REPORTED | TIME CRASH REPORTED | DISPATCH TIME | ARRIVAL TIME | TIME CLEARED | OTHER INVESTIGATION TIME | TOTAL MINUTES |
| 20 POLICE AGENCY <input type="checkbox"/> MOTORIST | | 11011820115 | 119211 | 119211 | 11927 | 201091 | 1160 | 1102 |
| OFFICER'S NAME * | OFFICER'S BADGE NUMBER | CHECKED BY | | | | | | |
| E. WALLACE | 29 | 37 / 50 | | | | | | |



MOTORIST / Non-MOTORIST / OCCUPANT

LOCAL REPORT NUMBER

201151900101829179

| | | | | |
|---------------------------|--|--------------------------------------|------------------|---|
| UNIT NUMBER 011 | NAME: LAST, FIRST, MIDDLE NADINE ALEXANDER | DATE OF BIRTH 108109119143 | AGE 72 | GENDER F F - FEMALE M - MALE |
|---------------------------|--|--------------------------------------|------------------|---|

| | |
|--|--|
| ADDRESS, CITY, STATE, ZIP 1020 MEADOW THRUSH ENGLEWOOD, OH | CONTACT PHONE - INCLUDE AREA CODE (937) 829-1836 |
|--|--|

| | | | | | | | | | |
|----------------------|------------------|------------|-----------------------------------|------------------------------------|---|-------------------------------|---------------------------|----------------------|---------------------|
| INJURIES 1 | INJURED TAKEN BY | EMS AGENCY | MEDICAL FACILITY INJURED TAKEN TO | SAFETY EQUIPMENT USED 04 | DOT COMPLIANT <input type="checkbox"/> MOTORCYCLE HELMET | SEATING POSITION 01 | AIR BAG USAGE 1 | EJECTION 1 | TRAPPED 1 |
|----------------------|------------------|------------|-----------------------------------|------------------------------------|---|-------------------------------|---------------------------|----------------------|---------------------|

| | | | | | | | | | | | |
|-----------------------|--|----------------------|---|--------------------------------------|-----------------------|------------------------------------|---------------------------------|-------------------------------|--------------------------------|------------------------------|----------------------------|
| OL STATE OH | OPERATOR LICENSE NUMBER R6663409 | OL CLASS 4 | No VALID OL <input type="checkbox"/> | M/C END. <input type="checkbox"/> | CONDITION 1 | ALCOHOL/DRUG SUSPECTED 1 | ALCOHOL TEST STATUS 1 | ALCOHOL TEST TYPE 1 | ALCOHOL TEST VALUE 1 | DRUG TEST STATUS 1 | DRUG TEST TYPE 1 |
|-----------------------|--|----------------------|---|--------------------------------------|-----------------------|------------------------------------|---------------------------------|-------------------------------|--------------------------------|------------------------------|----------------------------|

| | | | | |
|--|------------------------------------|----------------------------------|--|----------------------------------|
| OFFENSE CHARGED (LOCAL CODE) 333.03a | OFFENSE DESCRIPTION ARDA | CITATION NUMBER 079045 | HANDS-FREE DEVICE USED <input type="checkbox"/> | DRIVER DISTRACTED BY 1 |
|--|------------------------------------|----------------------------------|--|----------------------------------|

| | | | | |
|---------------------------|---|-------------------------------------|------------------|---|
| UNIT NUMBER 012 | NAME: LAST, FIRST, MIDDLE OWENS, E. MARSHAL | DATE OF BIRTH 11128119158 | AGE 57 | GENDER M F - FEMALE M - MALE |
|---------------------------|---|-------------------------------------|------------------|---|

| | |
|---|--|
| ADDRESS, CITY, STATE, ZIP 811 ARLINGTON AVE. FRANKLIN, OH 45005 | CONTACT PHONE - INCLUDE AREA CODE (937) 361-5021 |
|---|--|

| | | | | | | | | | |
|----------------------|------------------|------------|-----------------------------------|------------------------------------|---|-------------------------------|---------------------------|----------------------|---------------------|
| INJURIES 1 | INJURED TAKEN BY | EMS AGENCY | MEDICAL FACILITY INJURED TAKEN TO | SAFETY EQUIPMENT USED 04 | DOT COMPLIANT <input type="checkbox"/> MOTORCYCLE HELMET | SEATING POSITION 01 | AIR BAG USAGE 1 | EJECTION 1 | TRAPPED 1 |
|----------------------|------------------|------------|-----------------------------------|------------------------------------|---|-------------------------------|---------------------------|----------------------|---------------------|

| | | | | | | | | | | | |
|-----------------------|--|----------------------|---|--------------------------------------|-----------------------|------------------------------------|---------------------------------|-------------------------------|--------------------------------|------------------------------|----------------------------|
| OL STATE OH | OPERATOR LICENSE NUMBER RF504588 | OL CLASS 4 | No VALID OL <input type="checkbox"/> | M/C END. <input type="checkbox"/> | CONDITION 1 | ALCOHOL/DRUG SUSPECTED 1 | ALCOHOL TEST STATUS 1 | ALCOHOL TEST TYPE 1 | ALCOHOL TEST VALUE 1 | DRUG TEST STATUS 1 | DRUG TEST TYPE 1 |
|-----------------------|--|----------------------|---|--------------------------------------|-----------------------|------------------------------------|---------------------------------|-------------------------------|--------------------------------|------------------------------|----------------------------|

| | | | | |
|------------------------------|---------------------|-----------------|--|----------------------------------|
| OFFENSE CHARGED (LOCAL CODE) | OFFENSE DESCRIPTION | CITATION NUMBER | HANDS-FREE DEVICE USED <input type="checkbox"/> | DRIVER DISTRACTED BY 1 |
|------------------------------|---------------------|-----------------|--|----------------------------------|

| | | | | | |
|--|---|--|--|--|---|
| INJURIES 1 - NO INJURY / NONE REPORTED 2 - POSSIBLE 3 - NON-INCAPACITATING 4 - INCAPACITATING 5 - FATAL | INJURED TAKEN BY 1 - NOT TRANSPORTED / TREATED AT SCENE 2 - EMS 3 - POLICE 4 - OTHER 9 - UNKNOWN | SAFETY EQUIPMENT USED MOTORIST 01 - NONE USED - VEHICLE OCCUPANT 02 - SHOULDER BELT ONLY USED 03 - LAP BELT ONLY USED 04 - SHOULDER AND LAP BELT USED | 99 - UNKNOWN SAFETY EQUIPMENT 05 - CHILD RESTRAINT SYSTEM-FORWARD FACING 06 - CHILD RESTRAINT SYSTEM- REAR FACING 07 - BOOSTER SEAT 08 - HELMET USED | NON-MOTORIST 09 - NONE USED 10 - HELMET USED 11 - PROTECTIVE PADS USED (ELBOWS, KNEES, ETC) | 12 - REFLECTIVE CLOTHING 13 - LIGHTING 14 - OTHER |
|--|---|--|--|--|---|

| | | | |
|--|--|---|--|
| SEATING POSITION 01 - FRONT - LEFT SIDE (MOTORCYCLE DRIVER) 02 - FRONT - MIDDLE 03 - FRONT - RIGHT SIDE 04 - SECOND - LEFT SIDE (MOTORCYCLE PASSENGER) 05 - SECOND - MIDDLE 06 - SECOND - RIGHT SIDE | 07 - THIRD - LEFT SIDE (MOTORCYCLE SIDE CAR) 08 - THIRD - MIDDLE 09 - THIRD - RIGHT SIDE 10 - SLEEPER SECTION OF CAB (TRUCK) 11 - PASSENGER IN OTHER ENCLOSED CARGO AREA (NON-TRAILING UNIT SUCH AS A BUS, PICK-UP WITH CAP) | 12 - PASSENGER IN UNENCLOSED CARGO AREA 13 - TRAILING UNIT 14 - RIDING ON VEHICLE EXTERIOR (NON-TRAILING UNIT) 15 - NON-MOTORIST 16 - OTHER 99 - UNKNOWN | AIR BAG USAGE 1 - NOT DEPLOYED 2 - DEPLOYED FRONT 3 - DEPLOYED SIDE 4 - DEPLOYED BOTH FRONT/SIDE 5 - NOT APPLICABLE 9 - DEPLOYMENT UNKNOWN |
|--|--|---|--|

| | | | | | |
|---|--|---|---|---|---|
| EJECTION 1 - NOT EJECTED 2 - TOTALLY EJECTED 3 - PARTIALLY EJECTED 4 - NOT APPLICABLE | TRAPPED 1 - NOT TRAPPED 2 - EXTRICATED BY MECHANICAL MEANS 3 - EXTRICATED BY NON-MECHANICAL MEANS | OPERATOR LICENSE CLASS 1 - CLASS A 2 - CLASS B 3 - CLASS C 4 - REGULAR CLASS (OHIO IS "D") 5 - MC/MOPED ONLY | CONDITION 1 - APPARENTLY NORMAL 2 - PHYSICAL IMPAIRMENT 3 - EMOTIONAL (DEPRESSED, ANGRY, DISTURBED) 4 - ILLNESS | 5 - FELL ASLEEP, FAINTED, FATIGUED 6 - UNDER THE INFLUENCE OF MEDICATIONS, DRUGS, ALCOHOL 7 - OTHER | ALCOHOL/DRUG SUSPECTED 1 - NONE 2 - YES - ALCOHOL SUSPECTED 3 - YES - HBD NOT IMPAIRED 4 - YES - DRUGS SUSPECTED 5 - YES - ALCOHOL AND DRUGS SUSPECTED |
|---|--|---|---|---|---|

| | | | | | |
|---|--|--|---|---|--|
| ALCOHOL TEST STATUS 1 - NONE GIVEN 2 - TEST REFUSED 3 - TEST GIVEN, CONTAMINATED SAMPLE/UNUSABLE 4 - TEST GIVEN, RESULTS KNOWN 5 - TEST GIVEN, RESULTS UNKNOWN | ALCOHOL TEST TYPE 1 - NONE 2 - BLOOD 3 - URINE 4 - BREATH 5 - OTHER | DRUG TEST STATUS 1 - NONE GIVEN 2 - TEST REFUSED 3 - TEST GIVEN, CONTAMINATED SAMPLE/UNUSABLE 4 - TEST GIVEN, RESULTS KNOWN 5 - TEST GIVEN, RESULTS UNKNOWN | DRUG TEST TYPE 1 - NONE 2 - BLOOD 3 - URINE 4 - OTHER | DRIVER DISTRACTED BY 1 - NO DISTRACTION REPORTED 2 - PHONE 3 - TEXTING/E-MAILING 4 - ELECTRONIC COMMUNICATION DEVICE 5 - OTHER ELECTRONIC DEVICE (NAVIGATION DEVICE, RADIO, DVD) | 6 - OTHER INSIDE THE VEHICLE 7 - EXTERNAL DISTRACTION |
|---|--|--|---|---|--|

| | | | | |
|----------------------------|--|--------------------------------------|------------------|---|
| UNIT NUMBER 1011 | NAME: LAST, FIRST, MIDDLE SHEPHERD, ALEXIS | DATE OF BIRTH 111115119191 | AGE 15 | GENDER F F - FEMALE M - MALE |
|----------------------------|--|--------------------------------------|------------------|---|

| | |
|---|--|
| ADDRESS, CITY, STATE, ZIP 111 NORTH MAIN STREET Union, OH 45322 | CONTACT PHONE - INCLUDE AREA CODE (937) 540-8174 |
|---|--|

| | | | | | | | | | |
|----------------------|------------------|------------|-----------------------------------|------------------------------------|---|-------------------------------|---------------------------|----------------------|---------------------|
| INJURIES 1 | INJURED TAKEN BY | EMS AGENCY | MEDICAL FACILITY INJURED TAKEN TO | SAFETY EQUIPMENT USED 04 | DOT COMPLIANT <input type="checkbox"/> MOTORCYCLE HELMET | SEATING POSITION 03 | AIR BAG USAGE 1 | EJECTION 1 | TRAPPED 1 |
|----------------------|------------------|------------|-----------------------------------|------------------------------------|---|-------------------------------|---------------------------|----------------------|---------------------|

| | | | | |
|----------------------------|---|--------------------------------------|------------------|---|
| UNIT NUMBER 1011 | NAME: LAST, FIRST, MIDDLE NELSON, ROBIN | DATE OF BIRTH 110105119191 | AGE 16 | GENDER F F - FEMALE M - MALE |
|----------------------------|---|--------------------------------------|------------------|---|

| | |
|---|--|
| ADDRESS, CITY, STATE, ZIP 111 NORTH MAIN STREET Union, OH 45322 | CONTACT PHONE - INCLUDE AREA CODE (937) 540-8174 |
|---|--|

| | | | | | | | | | |
|----------------------|------------------|------------|-----------------------------------|------------------------------------|---|-------------------------------|---------------------------|----------------------|---------------------|
| INJURIES 1 | INJURED TAKEN BY | EMS AGENCY | MEDICAL FACILITY INJURED TAKEN TO | SAFETY EQUIPMENT USED 04 | DOT COMPLIANT <input type="checkbox"/> MOTORCYCLE HELMET | SEATING POSITION 06 | AIR BAG USAGE 1 | EJECTION 1 | TRAPPED 1 |
|----------------------|------------------|------------|-----------------------------------|------------------------------------|---|-------------------------------|---------------------------|----------------------|---------------------|



UNIT

LOCAL REPORT NUMBER

1201150100101329779

| | | | | |
|--|--|---|-----------------------------------|------------------|
| UNIT NUMBER 1011 | OWNER NAME: LAST, FIRST, MIDDLE (X) SAME AS DRIVER | OWNER PHONE NUMBER - INC. AREA CODE (X) SAME AS DRIVER | DAMAGE SCALE 2 | DAMAGED AREA |
| OWNER ADDRESS: CITY, STATE, ZIP (X) SAME AS DRIVER | | | 1 - NONE | |
| LP STATE OH | LICENSE PLATE NUMBER GFB1492 | VEHICLE IDENTIFICATION NUMBER 1K4L81C1B165P181EK14140143181 | 2 - MINOR | |
| VEHICLE YEAR 2011 | VEHICLE MAKE CHEVROLET | VEHICLE MODEL SONIC | 3 - FUNCTIONAL | |
| PROOF OF INSURANCE SHOWN (X) | INSURANCE COMPANY GEICO | POLICY NUMBER 4346-88-09-43 | 4 - DISABLING | |
| CARRIER NAME, ADDRESS, CITY, STATE, ZIP | | | 9 - UNKNOWN | |
| | | | CARRIER PHONE - INCLUDE AREA CODE | |

| | | | |
|-------------------|--|---|--|
| US DOT | VEHICLE WEIGHT GVWR/GCWR 1 1 - LESS THAN OR EQUAL TO 10K LBS. 2 - 10,001 TO 26,000 LBS. 3 - MORE THAN 26,000 LBS. | CARGO BODY TYPE 01 01 - NO CARGO BODY TYPE/NOT APPLICABLE 02 - BUS/VAN (9-15 SEATS, INC DRIVER) 03 - BUS (16+ SEATS, INC DRIVER) 04 - VEHICLE TOWING ANOTHER VEHICLE 05 - LOGGING 06 - INTERMODAL CONTAINER CHASSIS 07 - CARGO VAN/ENCLOSED BOX 08 - GRAIN, CHIPS, GRAVEL | TRAFFICWAY DESCRIPTION 1 1 - TWO-WAY, NOT DIVIDED 2 - TWO-WAY, NOT DIVIDED, CONTINUOUS LEFT TURN LANE 3 - TWO-WAY, DIVIDED, UNPROTECTED (PAINTED OR GRASS >4 FT.) MEDIAN 4 - TWO-WAY, DIVIDED, POSITIVE MEDIAN BARRIER 5 - ONE-WAY TRAFFICWAY |
| HM PLACARD ID NO. | <input type="checkbox"/> HAZARDOUS MATERIAL RELEASED | 09 - POLE 10 - CARGO TANK 11 - FLAT BED 12 - DUMP 13 - CONCRETE MIXER 14 - AUTO TRANSPORTER 15 - GARBAGE/REFUSE 99 - OTHER/UNKNOWN | <input type="checkbox"/> HIT / SKIP UNIT |
| HM CLASS NUMBER | | | |

| | | | | |
|--|---|---|---|--|
| NON-MOTORIST LOCATION PRIOR TO IMPACT 01 01 - INTERSECTION - MARKED CROSSWALK 02 - INTERSECTION - NO CROSSWALK 03 - INTERSECTION - OTHER 04 - MIDBLOCK - MARKED CROSSWALK 05 - TRAVEL LANE - OTHER LOCATION 06 - BICYCLE LANE 07 - SHOULDER/ROADSIDE 08 - SIDEWALK 09 - MEDIAN/CROSSING ISLAND 10 - DRIVEWAY ACCESS 11 - SHARED-USE PATH OR TRAIL 12 - NON-TRAFFICWAY AREA 99 - OTHER/UNKNOWN | TYPE OF USE 1 1 - PERSONAL 2 - COMMERCIAL 3 - GOVERNMENT <input type="checkbox"/> IN EMERGENCY RESPONSE | UNIT TYPE 02 99 - UNKNOWN OR HIT / SKIP PASSENGER VEHICLES (LESS THAN 9 PASSENGERS) 01 - SUB-COMPACT 02 - COMPACT 03 - MID SIZE 04 - FULL SIZE 05 - MINIVAN 06 - SPORT UTILITY VEHICLE 07 - PICKUP 08 - VAN 09 - MOTORCYCLE 10 - MOTORIZED BICYCLE 11 - SNOWMOBILE/ATV 12 - OTHER PASSENGER VEHICLE | MED/HEAVY TRUCKS OR COMBO UNITS > 10K LBS 13 - SINGLE UNIT TRUCK OR VAN 2AXLE, 6 TIRES 14 - SINGLE UNIT TRUCK; 3+ AXLES 15 - SINGLE UNIT TRUCK / TRAILER 16 - TRUCK/TRACTOR (BOBTAIL) 17 - TRACTOR/SEMI-TRAILER 18 - TRACTOR/DOUBLE 19 - TRACTOR/TRIPLES 20 - OTHER MED/HEAVY VEHICLE | BUS/VAN/LIMO (9 OR MORE INCLUDING DRIVER) 21 - BUS/VAN (9-15 SEATS, INC DRIVER) 22 - BUS (16+ SEATS, INC DRIVER) NON-MOTORIST 23 - ANIMAL WITH RIDER 24 - ANIMAL WITH BUGGY, WAGON, SURREY 25 - BICYCLE/PEDALCYLIST 26 - PEDESTRIAN/SKATER 27 - OTHER NON-MOTORIST |
| <input type="checkbox"/> HAS HM PLACARD | | | | |

| | | | | | |
|--|---|---|--|---|--|
| SPECIAL FUNCTION 01 01 - NONE 02 - TAXI 03 - RENTAL TRUCK (OVER 10K LBS) 04 - BUS - SCHOOL (PUBLIC OR PRIVATE) 05 - BUS - TRANSIT 06 - BUS - CHARTER 07 - BUS - SHUTTLE 08 - BUS - OTHER | 09 - AMBULANCE 10 - FIRE 11 - HIGHWAY/MAINTENANCE 12 - MILITARY 13 - POLICE 14 - PUBLIC UTILITY 15 - OTHER GOVERNMENT 16 - CONSTRUCTION EQUIP. | 17 - FARM VEHICLE 18 - FARM EQUIPMENT 19 - MOTORHOME 20 - GOLF CART 21 - TRAIL 22 - OTHER (EXPLAIN IN NARRATIVE) | MOST DAMAGED AREA 02 01 - NONE 02 - CENTER FRONT 03 - RIGHT FRONT 04 - RIGHT SIDE 05 - RIGHT REAR 06 - REAR CENTER 07 - LEFT REAR | 08 - LEFT SIDE 09 - LEFT FRONT 10 - TOP AND WINDOWS 11 - UNDERCARRIAGE 12 - LOAD/TRAILER 13 - TOTAL(ALL AREAS) 14 - OTHER | ACTION 3 1 - NON-CONTACT 2 - NON-COLLISION 3 - STRIKING 4 - STRUCK 5 - STRIKING/STRUCK 9 - UNKNOWN |
|--|---|---|--|---|--|

| | | | |
|--|---|--|--|
| PRE-CRASH ACTIONS 01 01 - STRAIGHT AHEAD 02 - BACKING 03 - CHANGING LANES 04 - OVERTAKING/PASSING 05 - MAKING RIGHT TURN 06 - MAKING LEFT TURN 99 - UNKNOWN | MOTORIST 07 - MAKING U-TURN 08 - ENTERING TRAFFIC LANE 09 - LEAVING TRAFFIC LANE 10 - PARKED 11 - SLOWING OR STOPPED IN TRAFFIC 12 - DRIVERLESS | 13 - NEGOTIATING A CURVE 14 - OTHER MOTORIST ACTION | NON-MOTORIST 15 - ENTERING OR CROSSING SPECIFIED LOCATION 16 - WALKING, RUNNING, JOGGING, PLAYING, CYCLING 17 - WORKING 18 - PUSHING VEHICLE 19 - APPROACHING OR LEAVING VEHICLE 20 - STANDING 21 - OTHER NON-MOTORIST ACTION |
|--|---|--|--|

| | | | |
|--|--|---|---|
| CONTRIBUTING CIRCUMSTANCES 09 PRIMARY 01 - NONE 02 - FAILURE TO YIELD 03 - RAN RED LIGHT 04 - RAN STOP SIGN 05 - EXCEEDED SPEED LIMIT 06 - UNSAFE SPEED 07 - IMPROPER TURN 08 - LEFT OF CENTER 09 - FOLLOWED TOO CLOSELY/ACDA 10 - IMPROPER LANE CHANGE /PASSING/OFF ROAD | MOTORIST 11 - IMPROPER BACKING 12 - IMPROPER START FROM PARKED POSITION 13 - STOPPED OR PARKED ILLEGALLY 14 - OPERATING VEHICLE IN NEGLIGENT MANNER 15 - SWERVING TO AVOID (DUE TO EXTERNAL CONDITIONS) 16 - WRONG SIDE/WRONG WAY 17 - FAILURE TO CONTROL 18 - VISION OBSTRUCTION 19 - OPERATING DEFECTIVE EQUIPMENT 20 - LOAD SHIFTING/FALLING/SPILLING 21 - OTHER IMPROPER ACTION | NON-MOTORIST 22 - NONE 23 - IMPROPER CROSSING 24 - DARTING 25 - LYING AND/OR ILLEGALLY IN ROADWAY 26 - FAILURE TO YIELD RIGHT OF WAY 27 - NOT VISIBLE (DARK CLOTHING) 28 - INATTENTIVE 29 - FAILURE TO OBEY TRAFFIC SIGNS /SIGNALS/OFFICER 30 - WRONG SIDE OF THE ROAD 31 - OTHER NON-MOTORIST ACTION | VEHICLE DEFECTS 01 01 - TURN SIGNALS 02 - HEAD LAMPS 03 - TAIL LAMPS 04 - BRAKES 05 - STEERING 06 - TIRE BLOWOUT 07 - WORN OR SLICK TIRES 08 - TRAILER EQUIPMENT DEFECTIVE 09 - MOTOR TROUBLE 10 - DISABLED FROM PRIOR ACCIDENT 11 - OTHER DEFECTS |
|--|--|---|---|

| | |
|---|--|
| SEQUENCE OF EVENTS 1 20 2 01 3 01 4 01 5 01 6 01 FIRST HARMFUL EVENT 1 MOST HARMFUL EVENT 1 99 - UNKNOWN | NON-COLLISION EVENTS 01 - OVERTURN/ROLLOVER 02 - FIRE/EXPLOSION 03 - IMMERSION 04 - JACKKNIFE 05 - CARGO/EQUIPMENT LOSS OR SHIFT 06 - EQUIPMENT FAILURE (BLOWN TIRE, BRAKE FAILURE, ETC) 07 - SEPARATION OF UNITS 08 - RAN OFF ROAD RIGHT 09 - RAN OFF ROAD LEFT 10 - CROSS MEDIAN OR SUPPORT 11 - CROSS CENTER LINE OPPOSITE DIRECTION OF TRAVEL 12 - DOWNHILL RUNAWAY 13 - OTHER NON-COLLISION |
| COLLISION WITH PERSON, VEHICLE OR OBJECT NOT FIXED 14 - PEDESTRIAN 15 - PEDALCYCLE 16 - RAILWAY VEHICLE (TRAIN, ENGINE) 17 - ANIMAL - FARM 18 - ANIMAL - DEER 19 - ANIMAL - OTHER 20 - MOTOR VEHICLE IN TRANSPORT 21 - PARKED MOTOR VEHICLE 22 - WORK ZONE MAINTENANCE EQUIPMENT 23 - STRUCK BY FALLING, SHIFTING CARGO OR ANYTHING SET IN MOTION BY A MOTOR VEHICLE 24 - OTHER MOVABLE OBJECT | COLLISION WITH FIXED OBJECT 25 - IMPACT ATTENUATOR/CRASH CUSHION 26 - BRIDGE OVERHEAD STRUCTURE 27 - BRIDGE PIER OR ABUTMENT 28 - BRIDGE PARAPET 29 - BRIDGE RAIL 30 - GUARDRAIL FACE 31 - GUARDRAIL END 32 - PORTABLE BARRIER 33 - MEDIAN CABLE BARRIER 34 - MEDIAN GUARDRAIL BARRIER 35 - MEDIAN CONCRETE BARRIER 36 - MEDIAN OTHER BARRIER 37 - TRAFFIC SIGN POST 38 - OVERHEAD SIGN POST 39 - LIGHT/LUMINARIES SUPPORT 40 - UTILITY POLE 41 - OTHER POST, POLE OR SUPPORT 42 - CULVERT 43 - CURB 44 - DITCH 45 - EMBANKMENT 46 - FENCE 47 - MAILBOX 48 - TREE 49 - FIRE HYDRANT 50 - WORK ZONE MAINTENANCE EQUIPMENT 51 - WALL, BUILDING, TUNNEL 52 - OTHER FIXED OBJECT |

| | | | |
|--------------------------|---------------------------|--|--|
| UNIT SPEED 140 | POSTED SPEED 45 | TRAFFIC CONTROL 12 01 - NO CONTROLS 02 - STOP SIGN 03 - YIELD SIGN 04 - TRAFFIC SIGNAL 05 - TRAFFIC FLASHERS 06 - SCHOOL ZONE 07 - RAILROAD CROSSBUCKS 08 - RAILROAD FLASHERS 09 - RAILROAD GATES 10 - CONSTRUCTION BARRICADE 11 - PERSON (FLAGGER, OFFICER) 12 - PAVEMENT MARKINGS 13 - CROSSWALK LINES 14 - WALK/DON'T WALK 15 - OTHER 16 - NOT REPORTED | UNIT DIRECTION FROM 2 TO 1 1 - NORTH 2 - SOUTH 3 - EAST 4 - WEST 5 - NORTHEAST 6 - NORTHWEST 7 - SOUTHEAST 8 - SOUTHWEST 9 - UNKNOWN |
|--------------------------|---------------------------|--|--|



UNIT

LOCAL REPORT NUMBER

201151010101329719

| | | | | |
|--|--|--|--------------------------|--------------|
| UNIT NUMBER 012 | OWNER NAME: LAST, FIRST, MIDDLE (SAME AS DRIVER) <input checked="" type="checkbox"/> | OWNER PHONE NUMBER - INC. AREA CODE (SAME AS DRIVER) <input checked="" type="checkbox"/> | DAMAGE SCALE 2 | DAMAGED AREA |
| OWNER ADDRESS: CITY, STATE, ZIP (SAME AS DRIVER) <input checked="" type="checkbox"/> | | | 1 - NONE | |
| LP STATE OH | LICENSE PLATE NUMBER CN24BS | VEHICLE IDENTIFICATION NUMBER 15NPEU416F016H10141071812 | 2 - MINOR | |
| VEHICLE YEAR 2010 | VEHICLE MAKE HYUNDAI | VEHICLE MODEL SONATA | 3 - FUNCTIONAL | |
| PROOF OF INSURANCE SHOWN <input checked="" type="checkbox"/> | INSURANCE COMPANY ALLIED INSURANCE | POLICY NUMBER PPXM0031745647 | 4 - DISABLING | |
| CARRIER NAME, ADDRESS, CITY, STATE, ZIP | | | 9 - UNKNOWN | |

| | | | |
|-------------------|--|---|--|
| US DOT | VEHICLE WEIGHT GVWR/GCWR 1 1 - LESS THAN OR EQUAL TO 10K LBS. 2 - 10,001 TO 26,000 LBS. 3 - MORE THAN 26,000 LBS. | CARGO BODY TYPE 01 01 - NO CARGO BODY TYPE/NOT APPLICABLE 02 - BUS/VAN (9-15 SEATS, INC DRIVER) 03 - BUS (16+ SEATS, INC DRIVER) 04 - VEHICLE TOWING ANOTHER VEHICLE 05 - LOGGING 06 - INTERMODAL CONTAINER CHASSIS 07 - CARGO VAN/ENCLOSED BOX 08 - GRAIN, CHIPS, GRAVEL | TRAFFICWAY DESCRIPTION 1 1 - TWO-WAY, NOT DIVIDED 2 - TWO-WAY, NOT DIVIDED, CONTINUOUS LEFT TURN LANE 3 - TWO-WAY, DIVIDED, UNPROTECTED (PAINTED OR GRASS >4 FT.) MEDIAN 4 - TWO-WAY, DIVIDED, POSITIVE MEDIAN BARRIER 5 - ONE-WAY TRAFFICWAY |
| HM PLACARD ID No. | <input type="checkbox"/> HAZARDOUS MATERIAL RELEASED | 09 - POLE 10 - CARGO TANK 11 - FLAT BED 12 - DUMP 13 - CONCRETE MIXER 14 - AUTO TRANSPORTER 15 - GARBAGE/REFUSE 99 - OTHER/UNKNOWN | <input type="checkbox"/> HIT / SKIP UNIT |
| HM CLASS NUMBER | | | |

| | | | | | |
|--|---|--|---|---|---|
| NON-MOTORIST LOCATION PRIOR TO IMPACT 01 01 - INTERSECTION - MARKED CROSSWALK 02 - INTERSECTION - NO CROSSWALK 03 - INTERSECTION - OTHER 04 - MIDBLOCK - MARKED CROSSWALK 05 - TRAVEL LANE - OTHER LOCATION 06 - BICYCLE LANE 07 - SHOULDER/ROADSIDE 08 - SIDEWALK 09 - MEDIAN/CROSSING ISLAND 10 - DRIVEWAY ACCESS 11 - SHARED-USE PATH OR TRAIL 12 - NON-TRAFFICWAY AREA 99 - OTHER/UNKNOWN | TYPE OF USE 1 1 - PERSONAL 2 - COMMERCIAL 3 - GOVERNMENT <input type="checkbox"/> IN EMERGENCY RESPONSE | UNIT TYPE 01 99 - UNKNOWN OR HIT / SKIP | PASSENGER VEHICLES (LESS THAN 9 PASSENGERS) 01 - SUB-COMPACT 02 - COMPACT 03 - MID SIZE 04 - FULL SIZE 05 - MINIVAN 06 - SPORT UTILITY VEHICLE 07 - PICKUP 08 - VAN 09 - MOTORCYCLE 10 - MOTORIZED BICYCLE 11 - SNOWMOBILE/ATV 12 - OTHER PASSENGER VEHICLE | MED/HEAVY TRUCKS OR COMBO UNITS > 10K LBS 13 - SINGLE UNIT TRUCK OR VAN 2AXLE, 6 TIRES 14 - SINGLE UNIT TRUCK; 3+ AXLES 15 - SINGLE UNIT TRUCK / TRAILER 16 - TRUCK/TRACTOR (BOBTAIL) 17 - TRACTOR/SEMI-TRAILER 18 - TRACTOR/DOUBLE 19 - TRACTOR/TRIPLES 20 - OTHER MED/HEAVY VEHICLE | BUS/VAN/LIMO (9 OR MORE INCLUDING DRIVER) 21 - BUS/VAN (9-15 SEATS, INC DRIVER) 22 - BUS (16+ SEATS, INC DRIVER) NON-MOTORIST 23 - ANIMAL WITH RIDER 24 - ANIMAL WITH BUGGY, WAGON, SURREY 25 - BICYCLE/PEDALCYCLIST 26 - PEDESTRIAN/SKATER 27 - OTHER NON-MOTORIST |
| | | | <input type="checkbox"/> HAS HM PLACARD | | |

| | | | | | | |
|--|---|---|--|---|--------------|--|
| SPECIAL FUNCTION 01 01 - NONE 02 - TAXI 03 - RENTAL TRUCK (OVER 10K LBS) 04 - BUS - SCHOOL (PUBLIC OR PRIVATE) 05 - BUS - TRANSIT 06 - BUS - CHARTER 07 - BUS - SHUTTLE 08 - BUS - OTHER | 09 - AMBULANCE 10 - FIRE 11 - HIGHWAY/MAINTENANCE 12 - MILITARY 13 - POLICE 14 - PUBLIC UTILITY 15 - OTHER GOVERNMENT 16 - CONSTRUCTION EQUIP. | 17 - FARM VEHICLE 18 - FARM EQUIPMENT 19 - MOTORHOME 20 - GOLF CART 21 - TRAIN 22 - OTHER (EXPLAIN IN NARRATIVE) | MOST DAMAGED AREA 06 01 - NONE 02 - CENTER FRONT 03 - RIGHT FRONT 04 - RIGHT SIDE 05 - RIGHT REAR 06 - REAR CENTER 07 - LEFT REAR | 08 - LEFT SIDE 09 - LEFT FRONT 10 - TOP AND WINDOWS 11 - UNDERCARRIAGE 12 - LOAD/TRAILER 13 - TOTAL(ALL AREAS) 14 - OTHER | 99 - UNKNOWN | ACTION 4 1 - NON-CONTACT 2 - NON-COLLISION 3 - STRIKING 4 - STRUCK 5 - STRIKING/STRUCK 9 - UNKNOWN |
|--|---|---|--|---|--------------|--|

| | | | | | |
|--|--|---|--|--|--------------------------------|
| PRE-CRASH ACTIONS 11 99 - UNKNOWN | MOTORIST 01 - STRAIGHT AHEAD 02 - BACKING 03 - CHANGING LANES 04 - OVERTAKING/PASSING 05 - MAKING RIGHT TURN 06 - MAKING LEFT TURN | 07 - MAKING U-TURN 08 - ENTERING TRAFFIC LANE 09 - LEAVING TRAFFIC LANE 10 - PARKED 11 - SLOWING OR STOPPED IN TRAFFIC 12 - DRIVERLESS | 13 - NEGOTIATING A CURVE 14 - OTHER MOTORIST ACTION | NON-MOTORIST 15 - ENTERING OR CROSSING SPECIFIED LOCATION 16 - WALKING, RUNNING, JOGGING, PLAYING, CYCLING 17 - WORKING 18 - PUSHING VEHICLE 19 - APPROACHING OR LEAVING VEHICLE 20 - STANDING | 21 - OTHER NON-MOTORIST ACTION |
|--|--|---|--|--|--------------------------------|

| | | | | |
|--|--|--|---|---|
| CONTRIBUTING CIRCUMSTANCES PRIMARY 01 99 - UNKNOWN | MOTORIST 01 - NONE 02 - FAILURE TO YIELD 03 - RAN RED LIGHT 04 - RAN STOP SIGN 05 - EXCEEDED SPEED LIMIT 06 - UNSAFE SPEED 07 - IMPROPER TURN 08 - LEFT OF CENTER 09 - FOLLOWED TOO CLOSELY/ACDA 10 - IMPROPER LANE CHANGE /PASSING/OFF ROAD | 11 - IMPROPER BACKING 12 - IMPROPER START FROM PARKED POSITION 13 - STOPPED OR PARKED ILLEGALLY 14 - OPERATING VEHICLE IN NEGLIGENT MANNER 15 - SWERVING TO AVOID (DUE TO EXTERNAL CONDITIONS) 16 - WRONG SIDE/WRONG WAY 17 - FAILURE TO CONTROL 18 - VISION OBSTRUCTION 19 - OPERATING DEFECTIVE EQUIPMENT 20 - LOAD SHIFTING/FALLING/SPILLING 21 - OTHER IMPROPER ACTION | NON-MOTORIST 22 - NONE 23 - IMPROPER CROSSING 24 - DARTING 25 - LYING AND/OR ILLEGALLY IN ROADWAY 26 - FAILURE TO YIELD RIGHT OF WAY 27 - NOT VISIBLE (DARK CLOTHING) 28 - INATTENTIVE 29 - FAILURE TO OBEY TRAFFIC SIGNS /SIGNALS/OFFICER 30 - WRONG SIDE OF THE ROAD 31 - OTHER NON-MOTORIST ACTION | VEHICLE DEFECTS 01 01 - TURN SIGNALS 02 - HEAD LAMPS 03 - TAIL LAMPS 04 - BRAKES 05 - STEERING 06 - TIRE BLOWOUT 07 - WORN OR SLICK TIRES 08 - TRAILER EQUIPMENT DEFECTIVE 09 - MOTOR TROUBLE 10 - DISABLED FROM PRIOR ACCIDENT 11 - OTHER DEFECTS |
|--|--|--|---|---|

| | |
|--|---|
| SEQUENCE OF EVENTS 1 20 2 01 3 01 4 01 5 01 6 01 FIRST HARMFUL EVENT 1 MOST HARMFUL EVENT 1 99 - UNKNOWN | NON-COLLISION EVENTS 01 - OVERTURN/ROLLOVER 02 - FIRE/EXPLOSION 03 - IMMERSION 04 - JACKKNIFE 05 - CARGO/EQUIPMENT LOSS OR SHIFT 06 - EQUIPMENT FAILURE (BLOWN TIRE, BRAKE FAILURE, ETC) 07 - SEPARATION OF UNITS 08 - RAN OFF ROAD RIGHT 09 - RAN OFF ROAD LEFT 10 - CROSS MEDIAN OR SUPPORT 11 - CROSS CENTER LINE OPPOSITE DIRECTION OF TRAVEL 12 - DOWNHILL RUNAWAY 13 - OTHER NON-COLLISION |
| COLLISION WITH PERSON, VEHICLE OR OBJECT NOT FIXED 14 - PEDESTRIAN 15 - PEDALCYCLE 16 - RAILWAY VEHICLE (TRAIN, ENGINE) 17 - ANIMAL - FARM 18 - ANIMAL - DEER 19 - ANIMAL - OTHER 20 - MOTOR VEHICLE IN TRANSPORT 21 - PARKED MOTOR VEHICLE 22 - WORK ZONE MAINTENANCE EQUIPMENT 23 - STRUCK BY FALLING, SHIFTING CARGO OR ANYTHING SET IN MOTION BY A MOTOR VEHICLE 24 - OTHER MOVABLE OBJECT | |
| COLLISION WITH FIXED OBJECT 25 - IMPACT ATTENUATOR/CRASH CUSHION 26 - BRIDGE OVERHEAD STRUCTURE 27 - BRIDGE PIER OR ABUTMENT 28 - BRIDGE PARAPET 29 - BRIDGE RAIL 30 - GUARDRAIL FACE 31 - GUARDRAIL END 32 - PORTABLE BARRIER 33 - MEDIAN CABLE BARRIER 34 - MEDIAN GUARDRAIL BARRIER 35 - MEDIAN CONCRETE BARRIER 36 - MEDIAN OTHER BARRIER 37 - TRAFFIC SIGN POST 38 - OVERHEAD SIGN POST 39 - LIGHT/LUMINARIES SUPPORT 40 - UTILITY POLE 41 - OTHER POST, POLE OR SUPPORT 42 - CULVERT 43 - CURB 44 - DITCH 45 - EMBANKMENT 46 - FENCE 47 - MAILBOX 48 - TREE 49 - FIRE HYDRANT 50 - WORK ZONE MAINTENANCE EQUIPMENT 51 - WALL, BUILDING, TUNNEL 52 - OTHER FIXED OBJECT | |

| | | | |
|--------------------------|---------------------------|--|--|
| UNIT SPEED 110 | POSTED SPEED 45 | TRAFFIC CONTROL 12 01 - NO CONTROLS 02 - STOP SIGN 03 - YIELD SIGN 04 - TRAFFIC SIGNAL 05 - TRAFFIC FLASHERS 06 - SCHOOL ZONE 07 - RAILROAD CROSSBUCKS 08 - RAILROAD FLASHERS 09 - RAILROAD GATES 10 - CONSTRUCTION BARRICADE 11 - PERSON (FLAGGER, OFFICER) 12 - PAVEMENT MARKINGS 13 - CROSSWALK LINES 14 - WALK/DON'T WALK 15 - OTHER 16 - NOT REPORTED | UNIT DIRECTION FROM 2 TO 1 1 - NORTH 2 - SOUTH 3 - EAST 4 - WEST 5 - NORTHEAST 6 - NORTHWEST 7 - SOUTHEAST 8 - SOUTHWEST 9 - UNKNOWN |
|--------------------------|---------------------------|--|--|



| | | |
|---------------------------------|---|-------------------------------------|
| LOCAL REPORT NUMBER 15-32979 | REPORTING AGENCY MASON PD | DATE OF CRASH M 08 D 18 Y 15 |
| IN COUNTY OF WARREN | CRASH LOCATION ST. ROUTE 741 @ BETHANY | |

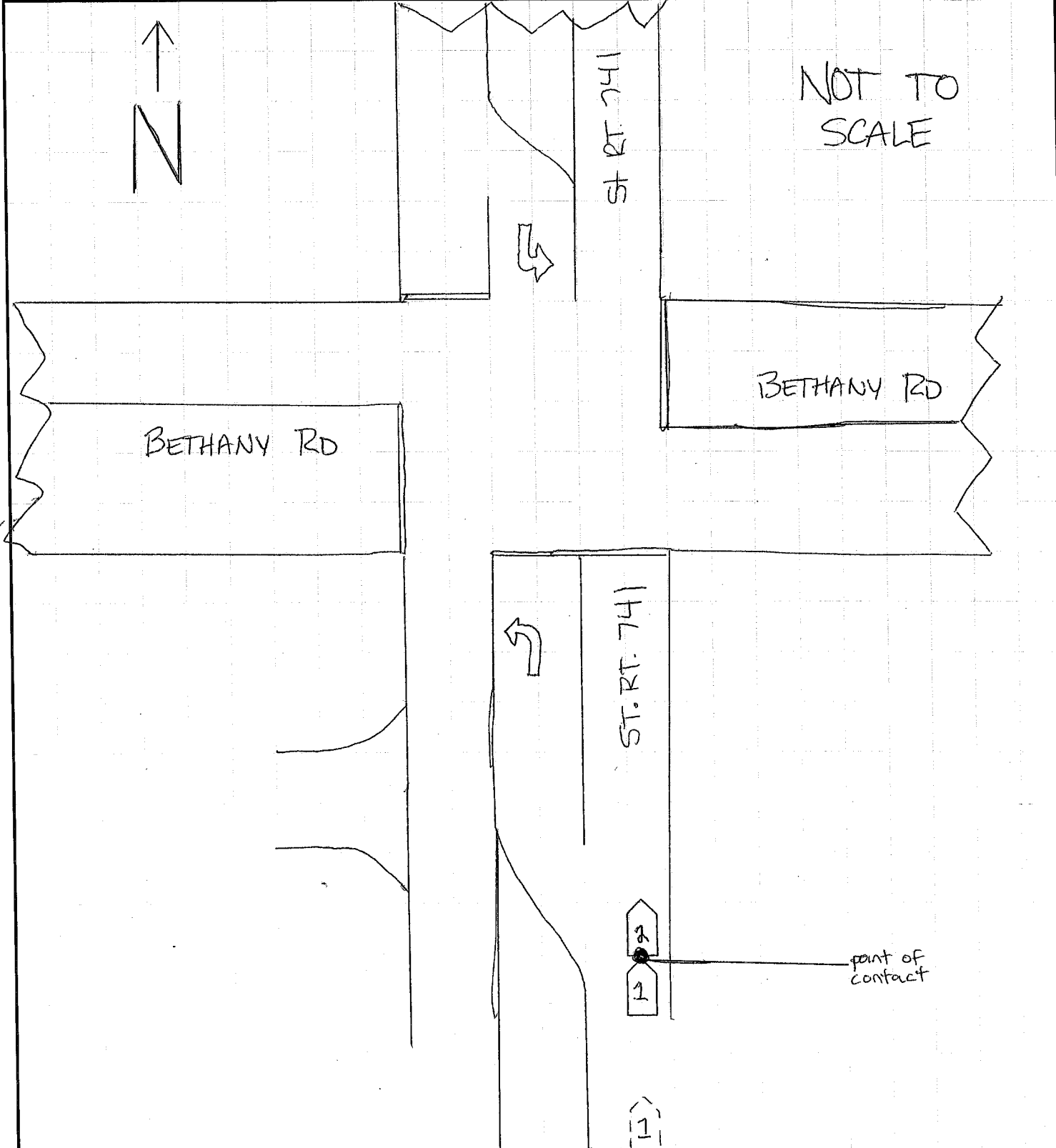

| | |
|---|----------------------|
| OFFICER'S SIGNATURE X <i>[Signature]</i> | BADGE NUMBER 1029 |
|---|----------------------|



| | | |
|---------------------------------|----------------------------------|-------------------------------------|
| LOCAL REPORT NUMBER 15-32979 | REPORTING AGENCY MASON POLICE | DATE OF CRASH M 10 D 08 Y 15 |
|---------------------------------|----------------------------------|-------------------------------------|

FOR LOCAL USE ONLY - DO NOT SUBMIT TO THE STATE EXCEPT FOR FATAL CRASHES

I, Alexander, Nadene HEREBY MAKE THIS VOLUNTARY STATEMENT TO
PRINTED

P.O. Wallace AT 741 / BETHANY
OFFICER'S NAME LOCATION

While traveling north on 741
 I did not see brake lights
 on front of me and hit
 the black car

Q. WERE YOU, OR ANYONE IN YOUR VEHICLE INJURED? NO

Q. WERE YOU WEARING YOUR SEAT BELT? YES

Q. WHAT DIRECTION WERE YOU GOING? NORTH

Q. WHAT WAS YOUR SPEED? under 25 MPH

Q. WERE YOU USING A CELL PHONE AT THE TIME OF THE CRASH? NO

ADDRESS OF WITNESS 1929 Meadows Thrush ENGLEWOOD PHONE 977-809

SIGNATURE OF WITNESS X [Signature] OFFICER'S SIGNATURE X [Signature] 43322 1830



| | | |
|---------------------------------|----------------------------------|---------------------------------------|
| LOCAL REPORT NUMBER 15-32977 | REPORTING AGENCY MASON POLICE | DATE OF CRASH M 10 D 18 Y 2015 |
|---------------------------------|----------------------------------|---------------------------------------|

FOR LOCAL USE ONLY - DO NOT SUBMIT TO THE STATE EXCEPT FOR FATAL CRASHES

I, Marshall Owens HEREBY MAKE THIS VOLUNTARY STATEMENT TO
PRINTED
P.O. Wallace AT St Rt 741 / Bethany
OFFICER'S NAME LOCATION

Setting At Red Light 741 North At
Bethany Road Got Rear Ended By
Lady in Red Car. Damaged BACK
Bumper

- Q. WERE YOU, OR ANYONE IN YOUR VEHICLE INJURED? NO
- Q. WERE YOU WEARING YOUR SEAT BELT? YES
- Q. WHAT DIRECTION WERE YOU GOING? North on 741
- Q. WHAT WAS YOUR SPEED? Stopped At Red light
- Q. WERE YOU USING A CELL PHONE AT THE TIME OF THE CRASH? NO

ADDRESS OF WITNESS 811 ARLINGTON AVE. FRANKLIN, OH 45005 PHONE 937-361-5621

SIGNATURE OF WITNESS [Signature] OFFICER'S SIGNATURE X Marshall Owens

Wallace 1029