



# TRAFFIC CRASH REPORT

LOCAL REPORT NUMBER *	CRASH SEVERITY	HIT/SKIP
36584	3 - PDD	1 - SOLVED 2 - UNSOLVED

### LOCAL INFORMATION

<input type="checkbox"/> PHOTOS TAKEN <input checked="" type="checkbox"/> OH-2 <input type="checkbox"/> OH-1P <input type="checkbox"/> OH-3 <input type="checkbox"/> OTHER	<input type="checkbox"/> PDD UNDER STATE REPORTABLE DOLLAR AMOUNT	<input type="checkbox"/> PRIVATE PROPERTY	REPORTING AGENCY NCIC * 08304	REPORTING AGENCY NAME * MASON POLICE	NUMBER OF UNITS 02	UNIT IN ERROR 98 - ANIMAL 99 - UNKNOWN 02
--	---	---	----------------------------------	---	-----------------------	--

COUNTY * 83	CITY * MASON	CITY, VILLAGE, TOWNSHIP *	CRASH DATE * 11/19/2015	TIME OF CRASH 11:23	DAY OF WEEK THU
----------------	-----------------	---------------------------	----------------------------	------------------------	--------------------

DEGREES / MINUTES / SECONDS LATITUDE 39° 21' 43.81"	LONGITUDE - 84° 16' 51.26"	DECIMAL DEGREES LATITUDE 39.362168	LONGITUDE - 84.280906
---	-------------------------------	--	--------------------------

ROADWAY DIVISION <input checked="" type="checkbox"/> DIVIDED <input type="checkbox"/> UNDIVIDED	DIVIDED LANE DIRECTION OF TRAVEL N - NORTHBOUND E - EASTBOUND S - SOUTHBOUND W - WESTBOUND	NUMBER OF THRU LANES 02	ROAD TYPES OR MILEPOST 2 AL - ALLEY CR - CIRCLE HE - HEIGHTS MP - MILEPOST PL - PLACE ST - STREET WA - WAY AV - AVENUE CT - COURT HW - HIGHWAY PK - PARKWAY RD - ROAD TE - TERRACE BL - BOULEVARD DR - DRIVE LA - LANE PI - PIKE SQ - SQUARE TL - TRAIL
---	--	----------------------------	--

LOCATION ROUTE TYPE 1 SR 741	LOCATION ROUTE TYPE 2	ROUTE TYPES 1 IR - INTERSTATE ROUTE (INC. TURNPIKE) CR - NUMBERED COUNTY ROUTE US - US ROUTE TR - NUMBERED TOWNSHIP ROUTE
---------------------------------	-----------------------	---

DISTANCE FROM REFERENCE MILES FEET YARDS	DIR FROM REF N, S, E, W	REFERENCE ROUTE TYPE 1	REFERENCE ROUTE NUMBER	REF PREFIX N, S, E, W	REFERENCE NAME (ROAD, MILEPOST, HOUSE #) COX SMITH	REFERENCE ROAD TYPE 2 RA
---	----------------------------	------------------------	------------------------	--------------------------	---	-----------------------------

REFERENCE POINT USED 1 - INTERSECTION 2 - MILE POST 3 - HOUSE NUMBER	CRASH LOCATION 01 - NOT AN INTERSECTION 02 - FOUR-WAY INTERSECTION 03 - T-INTERSECTION 04 - Y-INTERSECTION 05 - TRAFFIC CIRCLE/ROUNDBOAT	06 - FIVE-POINT, OR MORE 07 - ON RAMP 08 - OFF RAMP 09 - CROSSOVER 10 - DRIVEWAY/ALLEY ACCESS	11 - RAILWAY GRADE CROSSING 12 - SHARED-USE PATHS OR TRAILS 99 - UNKNOWN	<input type="checkbox"/> INTERSECTION RELATED	LOCATION OF FIRST HARMFUL EVENT 1 - ON ROADWAY 2 - ON SHOULDER 3 - IN MEDIAN 4 - ON ROADSIDE 5 - ON GORE 6 - OUTSIDE TRAFFICWAY 9 - UNKNOWN
---	---	---	--	---	--

ROAD CONTOUR 1 - STRAIGHT LEVEL 2 - STRAIGHT GRADE 3 - CURVE LEVEL 4 - CURVE GRADE 9 - UNKNOWN	ROAD CONDITIONS PRIMARY 01	SECONDARY	01 - DRY 02 - WET 03 - SNOW 04 - ICE 05 - SAND, MUD, DIRT, OIL, GRAVEL 06 - WATER (STANDING, MOVING) 07 - SLUSH 08 - DEBRIS*	09 - RUT, HOLES, BUMPS, UNEVEN PAVEMENT* 10 - OTHER 99 - UNKNOWN
---	----------------------------------	-----------	---	--

MANNER OF CRASH COLLISION/IMPACT 1 - NOT COLLISION BETWEEN TWO MOTOR VEHICLES IN TRANSPORT 2 - REAR-END 3 - HEAD-ON 4 - REAR-TO-REAR 5 - BACKING 6 - ANGLE 7 - SIDESWIPE, SAME DIRECTION 8 - SIDESWIPE, OPPOSITE DIRECTION 9 - UNKNOWN	WEATHER 1 - CLEAR 2 - CLOUDY 3 - FOG, SMOG, SMOKE 4 - RAIN 5 - SLEET, HAIL 6 - SNOW 7 - SEVERE CROSSWINDS 8 - BLOWING SAND, SOIL, DIRT, SNOW 9 - OTHER/UNKNOWN
---	---

ROAD SURFACE 1 - CONCRETE 2 - BLACKTOP, BITUMINOUS, ASPHALT 3 - BRICK/BLOCK 4 - SLAG, GRAVEL, STONE 5 - DIRT 6 - OTHER	LIGHT CONDITIONS PRIMARY 3	SECONDARY	1 - DAYLIGHT 2 - DAWN 3 - DUSK 4 - DARK - LIGHTED ROADWAY 5 - DARK - ROADWAY NOT LIGHTED 6 - DARK - UNKNOWN ROADWAY LIGHTING 7 - GLARE* 8 - OTHER 9 - UNKNOWN	<input type="checkbox"/> SCHOOL ZONE RELATED <input type="checkbox"/> SCHOOL BUS DIRECTLY INVOLVED <input type="checkbox"/> SCHOOL BUS INDIRECTLY INVOLVED
--	----------------------------------	-----------	---	--

<input type="checkbox"/> WORK ZONE RELATED	<input type="checkbox"/> WORKERS PRESENT <input type="checkbox"/> LAW ENFORCEMENT PRESENT (OFFICER/VEHICLE) <input type="checkbox"/> LAW ENFORCEMENT PRESENT (VEHICLE ONLY)	TYPE OF WORK ZONE 1 - LANE CLOSURE 2 - LANE SHIFT/CROSSOVER 3 - WORK ON SHOULDER OR MEDIAN 4 - INTERMITTENT OR MOVING WORK 5 - OTHER	LOCATION OF CRASH IN WORK ZONE 1 - BEFORE THE FIRST WORK ZONE WARNING SIGN 2 - ADVANCE WARNING AREA 3 - TRANSITION AREA 4 - ACTIVITY AREA 5 - TERMINATION AREA
--	---	---	---

NARRATIVE

UNIT #1 WAS NORTHBOUND ON SR741. UNIT #2 BEGAN TO MAKE A LEFT TURN FROM COX SMITH RD TO SOUTHBOUND SR741. UNIT #2 FAILED TO YIELD AND WAS STRUCK BY #1.

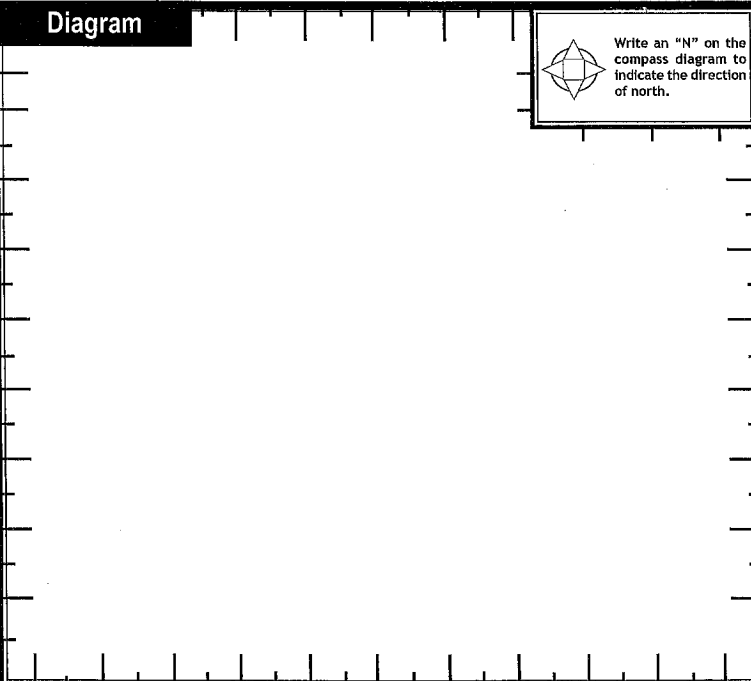

REPORT TAKEN BY <input checked="" type="checkbox"/> POLICE AGENCY <input type="checkbox"/> MOTORIST	<input type="checkbox"/> SUPPLEMENT (CORRECTION OR ADDITION TO AN EXISTING REPORT SENT TO ODPS)	DATE CRASH REPORTED 11/19/2015	TIME CRASH REPORTED 11:25	DISPATCH TIME 11:26	ARRIVAL TIME 11:35	TIME CLEARED 11:00	OTHER INVESTIGATION TIME 30	TOTAL MINUTES 57
OFFICER'S NAME * BRYANT	OFFICER'S BADGE NUMBER 55	CHECKED BY 50	PAGE OF					



# MOTORIST / Non-MOTORIST / OCCUPANT

LOCAL REPORT NUMBER

UNIT NUMBER <b>01</b>	NAME: LAST, FIRST, MIDDLE <b>HAMILTON, RAYMOND S.</b>	DATE OF BIRTH <b>09251971</b>	AGE <b>44</b>	GENDER <b>M</b> F - FEMALE M - MALE
--------------------------	--	----------------------------------	------------------	---

ADDRESS, CITY, STATE, ZIP <b>3625 AVALON TRL LEBANON OHIO 45036</b>	CONTACT PHONE- INCLUDE AREA CODE <b>513 313 0838</b>
--	---

INJURIES <input type="checkbox"/>	INJURED TAKEN BY <input type="checkbox"/>	EMS AGENCY	MEDICAL FACILITY INJURED TAKEN TO	SAFETY EQUIPMENT USED <b>04</b>	DOT COMPLIANT <input type="checkbox"/> MOTORCYCLE HELMET	SEATING POSITION <b>01</b>	AIR BAG USAGE <input type="checkbox"/>	EJECTION <input type="checkbox"/>	TRAPPED <input type="checkbox"/>		
OL STATE <b>OH</b>	OPERATOR LICENSE NUMBER <b>RN702821</b>	OL CLASS <b>4</b>	No <input type="checkbox"/> VALID OL	M/C END. <input type="checkbox"/>	CONDITION <b>1</b>	ALCOHOL/DRUG SUSPECTED <b>1</b>	ALCOHOL TEST STATUS <b>1</b>	ALCOHOL TEST TYPE <b>1</b>	ALCOHOL TEST VALUE	DRUG TEST STATUS <b>1</b>	DRUG TEST TYPE <b>1</b>
OFFENSE CHARGED ( <input type="checkbox"/> LOCAL CODE)	OFFENSE DESCRIPTION	CITATION NUMBER		HANDS-FREE <input type="checkbox"/> DEVICE USED	DRIVER DISTRACTED BY <input type="checkbox"/>						

UNIT NUMBER <b>02</b>	NAME: LAST, FIRST, MIDDLE <b>GIRARD, BRADLEY R.</b>	DATE OF BIRTH <b>10041986</b>	AGE <b>29</b>	GENDER <b>M</b> F - FEMALE M - MALE
--------------------------	--	----------------------------------	------------------	---

ADDRESS, CITY, STATE, ZIP <b>921 MEADOW LN LEBANON OHIO 45036</b>	CONTACT PHONE- INCLUDE AREA CODE <b>937 572 0313</b>
--	---

INJURIES <input type="checkbox"/>	INJURED TAKEN BY <input type="checkbox"/>	EMS AGENCY	MEDICAL FACILITY INJURED TAKEN TO	SAFETY EQUIPMENT USED <b>04</b>	DOT COMPLIANT <input type="checkbox"/> MOTORCYCLE HELMET	SEATING POSITION <b>01</b>	AIR BAG USAGE <input type="checkbox"/>	EJECTION <input type="checkbox"/>	TRAPPED <input type="checkbox"/>		
OL STATE <b>OH</b>	OPERATOR LICENSE NUMBER <b>SN116462</b>	OL CLASS <b>4</b>	No <input type="checkbox"/> VALID OL	M/C END. <input type="checkbox"/>	CONDITION <b>1</b>	ALCOHOL/DRUG SUSPECTED <b>1</b>	ALCOHOL TEST STATUS <b>1</b>	ALCOHOL TEST TYPE <b>1</b>	ALCOHOL TEST VALUE	DRUG TEST STATUS <b>1</b>	DRUG TEST TYPE <b>1</b>
OFFENSE CHARGED ( <input type="checkbox"/> LOCAL CODE)	OFFENSE DESCRIPTION	CITATION NUMBER		HANDS-FREE <input type="checkbox"/> DEVICE USED	DRIVER DISTRACTED BY <input type="checkbox"/>						

INJURIES 1 - NO INJURY / NONE REPORTED 2 - POSSIBLE 3 - NON-INCAPACITATING 4 - INCAPACITATING 5 - FATAL	INJURED TAKEN BY 1 - NOT TRANSPORTED / TREATED AT SCENE 2 - EMS 3 - POLICE 4 - OTHER 9 - UNKNOWN	SAFETY EQUIPMENT USED MOTORIST 01 - NONE USED - VEHICLE OCCUPANT 02 - SHOULDER BELT ONLY USED 03 - LAP BELT ONLY USED 04 - SHOULDER AND LAP BELT USED	99 - UNKNOWN SAFETY EQUIPMENT 05 - CHILD RESTRAINT SYSTEM-FORWARD FACING 06 - CHILD RESTRAINT SYSTEM-REAR FACING 07 - BOOSTER SEAT 08 - HELMET USED	Non-MOTORIST 09 - NONE USED 10 - HELMET USED 11 - PROTECTIVE PADS USED (ELBOWS, KNEES, ETC)	12 - REFLECTIVE CLOTHING 13 - LIGHTING 14 - OTHER
--	---	--	---	--	---

SEATING POSITION 01 - FRONT - LEFT SIDE (MOTORCYCLE DRIVER) 02 - FRONT - MIDDLE 03 - FRONT - RIGHT SIDE 04 - SECOND - LEFT SIDE (MOTORCYCLE PASSENGER) 05 - SECOND - MIDDLE 06 - SECOND - RIGHT SIDE	07 - THIRD - LEFT SIDE (MOTORCYCLE SIDE CAR) 08 - THIRD - MIDDLE 09 - THIRD - RIGHT SIDE 10 - SLEEPER SECTION OF CAB (TRUCK) 11 - PASSENGER IN OTHER ENCLOSED CARGO AREA (NON-TRAILING UNIT SUCH AS A BUS, PICK-UP WITH CAP)	12 - PASSENGER IN UNENCLOSED CARGO AREA 13 - TRAILING UNIT 14 - RIDING ON VEHICLE EXTERIOR (NON-TRAILING UNIT) 15 - NON-MOTORIST 16 - OTHER 99 - UNKNOWN	AIR BAG USAGE 1 - NOT DEPLOYED 2 - DEPLOYED FRONT 3 - DEPLOYED SIDE 4 - DEPLOYED BOTH FRONT/SIDE 5 - NOT APPLICABLE 9 - DEPLOYMENT UNKNOWN
--	--	---	--

EJECTION 1 - NOT EJECTED 2 - TOTALLY EJECTED 3 - PARTIALLY EJECTED 4 - NOT APPLICABLE	TRAPPED 1 - NOT TRAPPED 2 - EXTRICATED BY MECHANICAL MEANS 3 - EXTRICATED BY NON-MECHANICAL MEANS	OPERATOR LICENSE CLASS 1 - CLASS A 2 - CLASS B 3 - CLASS C 4 - REGULAR CLASS (OHIO IS "D") 5 - MC/MOPED ONLY	CONDITION 1 - APPARENTLY NORMAL 2 - PHYSICAL IMPAIRMENT 3 - EMOTIONAL (DEPRESSED, ANGRY, DISTURBED) 4 - ILLNESS	5 - FELL ASLEEP, FAINTED, FATIGUED 6 - UNDER THE INFLUENCE OF MEDICATIONS, DRUGS, ALCOHOL 7 - OTHER	ALCOHOL/DRUG SUSPECTED 1 - NONE 2 - YES - ALCOHOL SUSPECTED 3 - YES - HBD NOT IMPAIRED 4 - YES - DRUGS SUSPECTED 5 - YES - ALCOHOL AND DRUGS SUSPECTED
---	--	---	---	---	---

ALCOHOL TEST STATUS 1 - NONE GIVEN 2 - TEST REFUSED 3 - TEST GIVEN, CONTAMINATED SAMPLE/UNUSABLE 4 - TEST GIVEN, RESULTS KNOWN 5 - TEST GIVEN, RESULTS UNKNOWN	ALCOHOL TEST TYPE 1 - NONE 2 - BLOOD 3 - URINE 4 - BREATH 5 - OTHER	DRUG TEST STATUS 1 - NONE GIVEN 2 - TEST REFUSED 3 - TEST GIVEN, CONTAMINATED SAMPLE/UNUSABLE 4 - TEST GIVEN, RESULTS KNOWN 5 - TEST GIVEN, RESULTS UNKNOWN	DRUG TEST TYPE 1 - NONE 2 - BLOOD 3 - URINE 4 - OTHER	DRIVER DISTRACTED BY 1 - NO DISTRACTION REPORTED 2 - PHONE 3 - TEXTING/E-MAILING 4 - ELECTRONIC COMMUNICATION DEVICE 5 - OTHER ELECTRONIC DEVICE (NAVIGATION DEVICE, RADIO, DVD)	6 - OTHER INSIDE THE VEHICLE 7 - EXTERNAL DISTRACTION
---	--	--	---	---	--

UNIT NUMBER <input type="checkbox"/>	NAME: LAST, FIRST, MIDDLE	DATE OF BIRTH	AGE	GENDER <input type="checkbox"/> F - FEMALE M - MALE
---	---------------------------	---------------	-----	---

ADDRESS, CITY, STATE, ZIP	CONTACT PHONE- INCLUDE AREA CODE
---------------------------	----------------------------------

INJURIES <input type="checkbox"/>	INJURED TAKEN BY <input type="checkbox"/>	EMS AGENCY	MEDICAL FACILITY INJURED TAKEN TO	SAFETY EQUIPMENT USED	DOT COMPLIANT <input type="checkbox"/> MOTORCYCLE HELMET	SEATING POSITION	AIR BAG USAGE	EJECTION	TRAPPED
--------------------------------------	--	------------	-----------------------------------	-----------------------	---	------------------	---------------	----------	---------

UNIT NUMBER <input type="checkbox"/>	NAME: LAST, FIRST, MIDDLE	DATE OF BIRTH	AGE	GENDER <input type="checkbox"/> F - FEMALE M - MALE
---	---------------------------	---------------	-----	---

ADDRESS, CITY, STATE, ZIP	CONTACT PHONE- INCLUDE AREA CODE
---------------------------	----------------------------------

INJURIES <input type="checkbox"/>	INJURED TAKEN BY <input type="checkbox"/>	EMS AGENCY	MEDICAL FACILITY INJURED TAKEN TO	SAFETY EQUIPMENT USED	DOT COMPLIANT <input type="checkbox"/> MOTORCYCLE HELMET	SEATING POSITION	AIR BAG USAGE	EJECTION	TRAPPED
--------------------------------------	--	------------	-----------------------------------	-----------------------	---	------------------	---------------	----------	---------



# UNIT

LOCAL REPORT NUMBER

UNIT NUMBER <b>01</b>	OWNER NAME: LAST, FIRST, MIDDLE <input checked="" type="checkbox"/> SAME AS DRIVER	OWNER PHONE NUMBER - INC. AREA CODE <input checked="" type="checkbox"/> SAME AS DRIVER	DAMAGE SCALE <b>2</b>	DAMAGED AREA FRONT  REAR
OWNER ADDRESS: CITY, STATE, ZIP <input checked="" type="checkbox"/> SAME AS DRIVER			1 - NONE	09
LP STATE <b>OH</b>	LICENSE PLATE NUMBER <b>FRH 5438</b>	VEHICLE IDENTIFICATION NUMBER <b>2G2W P5520711171234</b>	2 - MINOR	03
VEHICLE YEAR <b>2007</b>	VEHICLE MAKE <b>PONTIAC</b>	VEHICLE MODEL <b>GRAND PRIX</b>	3 - FUNCTIONAL	08
PROOF OF INSURANCE SHOWN <input checked="" type="checkbox"/>	INSURANCE COMPANY <b>STATE FARM</b>	POLICY NUMBER <b>D13 014 8A 2135H</b>	4 - DISABLING	07
CARRIER NAME, ADDRESS, CITY, STATE, ZIP			9 - UNKNOWN	06
			CARRIER PHONE - INCLUDE AREA CODE	

US DOT	VEHICLE WEIGHT GVWR/GCWR <input type="checkbox"/> 1 - LESS THAN OR EQUAL TO 10K LBS. <input type="checkbox"/> 2 - 10,001 TO 26,000 LBS. <input type="checkbox"/> 3 - MORE THAN 26,000 LBS.	CARGO BODY TYPE <b>01</b> 01 - NO CARGO BODY TYPE/NOT APPLICABLE 02 - BUS/VAN (9-15 SEATS, INC DRIVER) 03 - BUS (16+ SEATS, INC DRIVER) 04 - VEHICLE TOWING ANOTHER VEHICLE 05 - LOGGING 06 - INTERMODAL CONTAINER CHASSIS 07 - CARGO VAN/ENCLOSED BOX 08 - GRAIN, CHIPS, GRAVEL	TRAFFICWAY DESCRIPTION <b>1</b> 1 - TWO-WAY, NOT DIVIDED 2 - TWO-WAY, NOT DIVIDED, CONTINUOUS LEFT TURN LANE 3 - TWO-WAY, DIVIDED, UNPROTECTED (PAINTED OR GRASS >4 FT.) MEDIAN 4 - TWO-WAY, DIVIDED, POSITIVE MEDIAN BARRIER 5 - ONE-WAY TRAFFICWAY
HM PLACARD ID No.	<input type="checkbox"/> HAZARDOUS MATERIAL RELEASED	09 - POLE 10 - CARGO TANK 11 - FLAT BED 12 - DUMP 13 - CONCRETE MIXER 14 - AUTO TRANSPORTER 15 - GARBAGE/REFUSE 99 - OTHER/UNKNOWN	<input type="checkbox"/> HIT / SKIP UNIT
HM CLASS NUMBER			

NON-MOTORIST LOCATION PRIOR TO IMPACT <b>01</b> 01 - INTERSECTION - MARKED CROSSWALK 02 - INTERSECTION - NO CROSSWALK 03 - INTERSECTION - OTHER 04 - MIDBLOCK - MARKED CROSSWALK 05 - TRAVEL LANE - OTHER LOCATION 06 - BICYCLE LANE 07 - SHOULDER/ROADSIDE 08 - SIDEWALK 09 - MEDIAN/CROSSING ISLAND 10 - DRIVEWAY ACCESS 11 - SHARED-USE PATH OR TRAIL 12 - NON-TRAFFICWAY AREA 99 - OTHER/UNKNOWN	TYPE OF USE <b>02</b> 1 - PERSONAL 2 - COMMERCIAL 3 - GOVERNMENT <input type="checkbox"/> IN EMERGENCY RESPONSE	UNIT TYPE <b>02</b> 99 - UNKNOWN OR HIT / SKIP	PASSENGER VEHICLES (LESS THAN 9 PASSENGERS) 01 - SUB-COMPACT 02 - COMPACT 03 - MID SIZE 04 - FULL SIZE 05 - MINIVAN 06 - SPORT UTILITY VEHICLE 07 - PICKUP 08 - VAN 09 - MOTORCYCLE 10 - MOTORIZED BICYCLE 11 - SNOWMOBILE/ATV 12 - OTHER PASSENGER VEHICLE	MED/HEAVY TRUCKS OR COMBO UNITS > 10K LBS 13 - SINGLE UNIT TRUCK OR VAN 2AXLE, 6 TIRES 14 - SINGLE UNIT TRUCK; 3+ AXLES 15 - SINGLE UNIT TRUCK / TRAILER 16 - TRUCK/TRACTOR (BOBTAIL) 17 - TRACTOR/SEMI-TRAILER 18 - TRACTOR/DOUBLE 19 - TRACTOR/TRIPLES 20 - OTHER MED/HEAVY VEHICLE	BUS/VAN/LIMO (9 OR MORE INCLUDING DRIVER) 21 - BUS/VAN (9-15 SEATS, INC DRIVER) 22 - BUS (16+ SEATS, INC DRIVER) NON-MOTORIST 23 - ANIMAL WITH RIDER 24 - ANIMAL WITH BUGGY, WAGON, SURREY 25 - BICYCLE/PEDALCYCLIST 26 - PEDESTRIAN/SKATER 27 - OTHER NON-MOTORIST
			<input type="checkbox"/> HAS HM PLACARD		

SPECIAL FUNCTION <b>01</b> 01 - NONE 02 - TAXI 03 - RENTAL TRUCK (OVER 10K LBS) 04 - BUS - SCHOOL (PUBLIC OR PRIVATE) 05 - BUS - TRANSIT 06 - BUS - CHARTER 07 - BUS - SHUTTLE 08 - BUS - OTHER	09 - AMBULANCE 10 - FIRE 11 - HIGHWAY/MAINTENANCE 12 - MILITARY 13 - POLICE 14 - PUBLIC UTILITY 15 - OTHER GOVERNMENT 16 - CONSTRUCTION EQUIP.	17 - FARM VEHICLE 18 - FARM EQUIPMENT 19 - MOTORHOME 20 - GOLF CART 21 - TRAIL 22 - OTHER (EXPLAIN IN NARRATIVE)	MOST DAMAGED AREA <b>02</b> 01 - NONE 02 - CENTER FRONT 03 - RIGHT FRONT 04 - RIGHT SIDE 05 - RIGHT REAR 06 - REAR CENTER 07 - LEFT REAR	08 - LEFT SIDE 09 - LEFT FRONT 10 - TOP AND WINDOWS 11 - UNDERCARRIAGE 12 - LOAD/TRAILER 13 - TOTAL(ALL AREAS) 14 - OTHER	ACTION <b>3</b> 1 - NON-CONTACT 2 - NON-COLLISION 3 - STRIKING 4 - STRUCK 5 - STRIKING/STRUCK 9 - UNKNOWN
--	---	---	--	---	--

PRE-CRASH ACTIONS <b>01</b> 99 - UNKNOWN	MOTORIST 01 - STRAIGHT AHEAD 02 - BACKING 03 - CHANGING LANES 04 - OVERTAKING/PASSING 05 - MAKING RIGHT TURN 06 - MAKING LEFT TURN	07 - MAKING U-TURN 08 - ENTERING TRAFFIC LANE 09 - LEAVING TRAFFIC LANE 10 - PARKED 11 - SLOWING OR STOPPED IN TRAFFIC 12 - DRIVERLESS	13 - NEGOTIATING A CURVE 14 - OTHER MOTORIST ACTION	NON-MOTORIST 15 - ENTERING OR CROSSING SPECIFIED LOCATION 16 - WALKING, RUNNING, JOGGING, PLAYING, CYCLING 17 - WORKING 18 - PUSHING VEHICLE 19 - APPROACHING OR LEAVING VEHICLE 20 - STANDING	21 - OTHER NON-MOTORIST ACTION
--	--	---	--	--	--------------------------------

CONTRIBUTING CIRCUMSTANCES PRIMARY <b>01</b> SECONDARY <b>01</b> 99 - UNKNOWN	MOTORIST 01 - NONE 02 - FAILURE TO YIELD 03 - RAN RED LIGHT 04 - RAN STOP SIGN 05 - EXCEEDED SPEED LIMIT 06 - UNSAFE SPEED 07 - IMPROPER TURN 08 - LEFT OF CENTER 09 - FOLLOWED TOO CLOSELY/ACDA 10 - IMPROPER LANE CHANGE /PASSING/OFF ROAD	11 - IMPROPER BACKING 12 - IMPROPER START FROM PARKED POSITION 13 - STOPPED OR PARKED ILLEGALLY 14 - OPERATING VEHICLE IN NEGLIGENT MANNER 15 - SWERVING TO AVOID (DUE TO EXTERNAL CONDITIONS) 16 - WRONG SIDE/WRONG WAY 17 - FAILURE TO CONTROL 18 - VISION OBSTRUCTION 19 - OPERATING DEFECTIVE EQUIPMENT 20 - LOAD SHIFTING/FALLING/SPILLING 21 - OTHER IMPROPER ACTION	NON-MOTORIST 22 - NONE 23 - IMPROPER CROSSING 24 - DARTING 25 - LYING AND/OR ILLEGALLY IN ROADWAY 26 - FAILURE TO YIELD RIGHT OF WAY 27 - NOT VISIBLE (DARK CLOTHING) 28 - INATTENTIVE 29 - FAILURE TO OBEY TRAFFIC SIGNS /SIGNALS/OFFICER 30 - WRONG SIDE OF THE ROAD 31 - OTHER NON-MOTORIST ACTION	VEHICLE DEFECTS <b>01</b> 01 - TURN SIGNALS 02 - HEAD LAMPS 03 - TAIL LAMPS 04 - BRAKES 05 - STEERING 06 - TIRE BLOWOUT 07 - WORN OR SLICK TIRES 08 - TRAILER EQUIPMENT DEFECTIVE 09 - MOTOR TROUBLE 10 - DISABLED FROM PRIOR ACCIDENT 11 - OTHER DEFECTS
--	--	--	---	---

SEQUENCE OF EVENTS 1 <b>20</b> 2 <b>01</b> 3 <b>01</b> 4 <b>01</b> 5 <b>01</b> 6 <b>01</b> FIRST HARMFUL EVENT <b>1</b> MOST HARMFUL EVENT <b>1</b> 99 - UNKNOWN	NON-COLLISION EVENTS 01 - OVERTURN/ROLLOVER 02 - FIRE/EXPLOSION 03 - IMMERSION 04 - JACKKNIFE 05 - CARGO/EQUIPMENT LOSS OR SHIFT 06 - EQUIPMENT FAILURE (BLOWN TIRE, BRAKE FAILURE, ETC) 07 - SEPARATION OF UNITS 08 - RAN OFF ROAD RIGHT 09 - RAN OFF ROAD LEFT 10 - CROSS MEDIAN OR SUPPORT 11 - CROSS CENTER LINE OPPOSITE DIRECTION OF TRAVEL 12 - DOWNHILL RUNAWAY 13 - OTHER NON-COLLISION
---	---

COLLISION WITH PERSON, VEHICLE OR OBJECT NOT FIXED 14 - PEDESTRIAN 15 - PEDALCYCLE 16 - RAILWAY VEHICLE (TRAIN, ENGINE) 17 - ANIMAL - FARM 18 - ANIMAL - DEER 19 - ANIMAL - OTHER 20 - MOTOR VEHICLE IN TRANSPORT	21 - PARKED MOTOR VEHICLE 22 - WORK ZONE MAINTENANCE EQUIPMENT 23 - STRUCK BY FALLING, SHIFTING OBJECT OR ANYTHING SET IN MOTION BY A MOTOR VEHICLE 24 - OTHER MOVABLE OBJECT	25 - IMPACT ATTENUATOR/CRASH CUSHION 26 - BRIDGE OVERHEAD STRUCTURE 27 - BRIDGE PIER OR ABUTMENT 28 - BRIDGE PARAPET 29 - BRIDGE RAIL 30 - GUARDRAIL FACE 31 - GUARDRAIL END 32 - PORTABLE BARRIER	33 - MEDIAN CABLE BARRIER 34 - MEDIAN GUARDRAIL BARRIER 35 - MEDIAN CONCRETE BARRIER 36 - MEDIAN OTHER BARRIER 37 - TRAFFIC SIGN POST 38 - OVERHEAD SIGN POST 39 - LIGHT/LUMINARIES SUPPORT 40 - UTILITY POLE	41 - OTHER POST, POLE OR SUPPORT 42 - CULVERT 43 - CURB 44 - DITCH 45 - EMBANKMENT 46 - FENCE 47 - MAILBOX	48 - TREE 49 - FIRE HYDRANT 50 - WORK ZONE MAINTENANCE EQUIPMENT 51 - WALL, BUILDING, TUNNEL 52 - OTHER FIXED OBJECT
--	--	---	--	--	--

UNIT SPEED <b>15</b> <input checked="" type="checkbox"/> STATED <input type="checkbox"/> ESTIMATED	POSTED SPEED <b>40</b>	TRAFFIC CONTROL <b>12</b> 01 - NO CONTROLS 02 - STOP SIGN 03 - YIELD SIGN 04 - TRAFFIC SIGNAL 05 - TRAFFIC FLASHERS 06 - SCHOOL ZONE 07 - RAILROAD CROSSBUCKS 08 - RAILROAD FLASHERS 09 - RAILROAD GATES 10 - CONSTRUCTION BARRICADE 11 - PERSON (FLAGGER, OFFICER) 12 - PAVEMENT MARKINGS 13 - CROSSWALK LINES 14 - WALK/DON'T WALK 15 - OTHER 16 - NOT REPORTED	UNIT DIRECTION FROM <b>2</b> TO <b>1</b> 1 - NORTH 2 - SOUTH 3 - EAST 4 - WEST 5 - NORTHEAST 6 - NORTHWEST 7 - SOUTHEAST 8 - SOUTHWEST 9 - UNKNOWN
---	---------------------------	--	--



# UNIT

LOCAL REPORT NUMBER

UNIT NUMBER <b>02</b>	OWNER NAME: LAST, FIRST, MIDDLE <input checked="" type="checkbox"/> SAME AS DRIVER	OWNER PHONE NUMBER - INC. AREA CODE <input checked="" type="checkbox"/> SAME AS DRIVER	DAMAGE SCALE <b>3</b>	DAMAGED AREA FRONT  REAR
OWNER ADDRESS: CITY, STATE, ZIP <input checked="" type="checkbox"/> SAME AS DRIVER			1 - NONE 2 - MINOR 3 - FUNCTIONAL 4 - DISABLING 9 - UNKNOWN	
LP STATE <b>OH</b>	LICENSE PLATE NUMBER <b>BRAD535</b>	VEHICLE IDENTIFICATION NUMBER <b>Jm1BK323871622118</b>	# OCCUPANTS <b>01</b>	
VEHICLE YEAR <b>2007</b>	VEHICLE MAKE <b>MAZDA</b>	VEHICLE MODEL <b>3</b>	VEHICLE COLOR <b>BLACK</b>	
PROOF OF INSURANCE SHOWN <input checked="" type="checkbox"/>	INSURANCE COMPANY <b>CINCINNATI INS</b>	POLICY NUMBER <b>A010669704</b>	TOWED BY	
CARRIER NAME, ADDRESS, CITY, STATE, ZIP			CARRIER PHONE- INCLUDE AREA CODE	

US DOT	VEHICLE WEIGHT GVWR/GCWR <b>1</b> 1 - LESS THAN OR EQUAL TO 10K LBS. 2 - 10,001 TO 26,000 LBS. 3 - MORE THAN 26,000 LBS.	CARGO BODY TYPE <b>01</b> 01 - NO CARGO BODY TYPE/NOT APPLICABLE 02 - BUS/VAN (9-15 SEATS, INC DRIVER) 03 - BUS (16+ SEATS, INC DRIVER) 04 - VEHICLE TOWING ANOTHER VEHICLE 05 - LOGGING 06 - INTERMODAL CONTAINER CHASSIS 07 - CARGO VAN/ENCLOSED BOX 08 - GRAIN, CHIPS, GRAVEL 09 - POLE 10 - CARGO TANK 11 - FLAT BED 12 - DUMP 13 - CONCRETE MIXER 14 - AUTO TRANSPORTER 15 - GARBAGE/REFUSE 99 - OTHER/UNKNOWN	TRAFFICWAY DESCRIPTION <b>1</b> 1 - TWO-WAY, NOT DIVIDED 2 - TWO-WAY, NOT DIVIDED, CONTINUOUS LEFT TURN LANE 3 - TWO-WAY, DIVIDED, UNPROTECTED (PAINTED OR GRASS >4 FT.) MEDIAN 4 - TWO-WAY, DIVIDED, POSITIVE MEDIAN BARRIER 5 - ONE-WAY TRAFFICWAY
HM PLACARD ID No.	<input type="checkbox"/> HAZARDOUS MATERIAL RELEASED		<input type="checkbox"/> HIT / SKIP UNIT
HM CLASS NUMBER			

NON-MOTORIST LOCATION PRIOR TO IMPACT <b>01</b> 01 - INTERSECTION - MARKED CROSSWALK 02 - INTERSECTION - NO CROSSWALK 03 - INTERSECTION - OTHER 04 - MIDBLOCK - MARKED CROSSWALK 05 - TRAVEL LANE - OTHER LOCATION 06 - BICYCLE LANE 07 - SHOULDER/ROADSIDE 08 - SIDEWALK 09 - MEDIAN/CROSSING ISLAND 10 - DRIVEWAY ACCESS 11 - SHARED-USE PATH OR TRAIL 12 - NON-TRAFFICWAY AREA 99 - OTHER/UNKNOWN	TYPE OF USE <b>1</b> 1 - PERSONAL 2 - COMMERCIAL 3 - GOVERNMENT <input type="checkbox"/> IN EMERGENCY RESPONSE	UNIT TYPE <b>02</b> 99 - UNKNOWN OR HIT / SKIP	PASSENGER VEHICLES (LESS THAN 9 PASSENGERS) 01 - SUB-COMPACT 02 - COMPACT 03 - MID SIZE 04 - FULL SIZE 05 - MINIVAN 06 - SPORT UTILITY VEHICLE 07 - PICKUP 08 - VAN 09 - MOTORCYCLE 10 - MOTORIZED BICYCLE 11 - SNOWMOBILE/ATV 12 - OTHER PASSENGER VEHICLE	MED/HEAVY TRUCKS OR COMBO UNITS > 10K LBS 13 - SINGLE UNIT TRUCK OR VAN 2AXLE, 6 TIRES 14 - SINGLE UNIT TRUCK; 3+ AXLES 15 - SINGLE UNIT TRUCK / TRAILER 16 - TRUCK/TRACTOR (BOBTAIL) 17 - TRACTOR/SEMI-TRAILER 18 - TRACTOR/DOUBLE 19 - TRACTOR/TRIPLES 20 - OTHER MED/HEAVY VEHICLE	BUS/VAN/LIMO (9 OR MORE INCLUDING DRIVER) 21 - BUS/VAN (9-15 SEATS, INC DRIVER) 22 - BUS (16+ SEATS, INC DRIVER) NON-MOTORIST 23 - ANIMAL WITH RIDER 24 - ANIMAL WITH BUGGY, WAGON, SURREY 25 - BICYCLE/PEDALCYCLIST 26 - PEDESTRIAN/SKATER 27 - OTHER NON-MOTORIST
			<input type="checkbox"/> HAS HM PLACARD		

SPECIAL FUNCTION <b>01</b> 01 - NONE 02 - TAXI 03 - RENTAL TRUCK (OVER 10K LBS) 04 - BUS - SCHOOL (PUBLIC OR PRIVATE) 05 - BUS - TRANSIT 06 - BUS - CHARTER 07 - BUS - SHUTTLE 08 - BUS - OTHER	09 - AMBULANCE 10 - FIRE 11 - HIGHWAY/MAINTENANCE 12 - MILITARY 13 - POLICE 14 - PUBLIC UTILITY 15 - OTHER GOVERNMENT 16 - CONSTRUCTION EQUIP.	17 - FARM VEHICLE 18 - FARM EQUIPMENT 19 - MOTORHOME 20 - GOLF CART 21 - TRAIN 22 - OTHER (EXPLAIN IN NARRATIVE)	MOST DAMAGED AREA <b>09</b> 01 - NONE 02 - CENTER FRONT 03 - RIGHT FRONT 04 - RIGHT SIDE 05 - RIGHT REAR 06 - REAR CENTER 07 - LEFT REAR	08 - LEFT SIDE 09 - LEFT FRONT 10 - TOP AND WINDOWS 11 - UNDERCARRIAGE 12 - LOAD/TRAILER 13 - TOTAL(ALL AREAS) 14 - OTHER	99 - UNKNOWN	ACTION <b>4</b> 1 - NON-CONTACT 2 - NON-COLLISION 3 - STRIKING 4 - STRUCK 5 - STRIKING/STRUCK 9 - UNKNOWN
--	---	---	--	---	--------------	--

PRE-CRASH ACTIONS <b>06</b> 99 - UNKNOWN	MOTORIST 01 - STRAIGHT AHEAD 02 - BACKING 03 - CHANGING LANES 04 - OVERTAKING/PASSING 05 - MAKING RIGHT TURN 06 - MAKING LEFT TURN	07 - MAKING U-TURN 08 - ENTERING TRAFFIC LANE 09 - LEAVING TRAFFIC LANE 10 - PARKED 11 - SLOWING OR STOPPED IN TRAFFIC 12 - DRIVERLESS	13 - NEGOTIATING A CURVE 14 - OTHER MOTORIST ACTION	NON-MOTORIST 15 - ENTERING OR CROSSING SPECIFIED LOCATION 16 - WALKING, RUNNING, JOGGING, PLAYING, CYCLING 17 - WORKING 18 - PUSHING VEHICLE 19 - APPROACHING OR LEAVING VEHICLE 20 - STANDING	21 - OTHER NON-MOTORIST ACTION
--	--	---	--	--	--------------------------------

CONTRIBUTING CIRCUMSTANCES <b>02</b> 99 - UNKNOWN	MOTORIST 01 - NONE 02 - FAILURE TO YIELD 03 - RAN RED LIGHT 04 - RAN STOP SIGN 05 - EXCEEDED SPEED LIMIT 06 - UNSAFE SPEED 07 - IMPROPER TURN 08 - LEFT OF CENTER 09 - FOLLOWED TOO CLOSELY/ACDA 10 - IMPROPER LANE CHANGE /PASSING/OFF ROAD	11 - IMPROPER BACKING 12 - IMPROPER START FROM PARKED POSITION 13 - STOPPED OR PARKED ILLEGALLY 14 - OPERATING VEHICLE IN NEGLIGENT MANNER 15 - SWERVING TO AVOID (DUE TO EXTERNAL CONDITIONS) 16 - WRONG SIDE/WRONG WAY 17 - FAILURE TO CONTROL 18 - VISION OBSTRUCTION 19 - OPERATING DEFECTIVE EQUIPMENT 20 - LOAD SHIFTING/FALLING/SPILLING 21 - OTHER IMPROPER ACTION	NON-MOTORIST 22 - NONE 23 - IMPROPER CROSSING 24 - DARTING 25 - LYING AND/OR ILLEGALLY IN ROADWAY 26 - FAILURE TO YIELD RIGHT OF WAY 27 - NOT VISIBLE (DARK CLOTHING) 28 - INATTENTIVE 29 - FAILURE TO OBEY TRAFFIC SIGNS /SIGNALS/OFFICER 30 - WRONG SIDE OF THE ROAD 31 - OTHER NON-MOTORIST ACTION	VEHICLE DEFECTS <b>01</b> 01 - TURN SIGNALS 02 - HEAD LAMPS 03 - TAIL LAMPS 04 - BRAKES 05 - STEERING 06 - TIRE BLOWOUT 07 - WORN OR SLICK TIRES 08 - TRAILER EQUIPMENT DEFECTIVE 09 - MOTOR TROUBLE 10 - DISABLED FROM PRIOR ACCIDENT 11 - OTHER DEFECTS
---	--	--	---	---

SEQUENCE OF EVENTS 1 <b>20</b> 2 <b>01</b> 3 <b>01</b> 4 <b>01</b> 5 <b>01</b> 6 <b>01</b> FIRST HARMFUL EVENT <b>1</b> MOST HARMFUL EVENT <b>1</b> 99 - UNKNOWN	NON-COLLISION EVENTS 01 - OVERTURN/ROLLOVER 02 - FIRE/EXPLOSION 03 - IMMERSION 04 - JACKKNIFE 05 - CARGO/EQUIPMENT LOSS OR SHIFT 06 - EQUIPMENT FAILURE (BLOWN TIRE, BRAKE FAILURE, ETC) 07 - SEPARATION OF UNITS 08 - RAN OFF ROAD RIGHT 09 - RAN OFF ROAD LEFT 10 - CROSS MEDIAN OR SUPPORT 11 - CROSS CENTER LINE OPPOSITE DIRECTION OF TRAVEL 12 - DOWNHILL RUNAWAY 13 - OTHER NON-COLLISION	COLLISION WITH FIXED OBJECT 25 - IMPACT ATTENUATOR/CRASH CUSHION 26 - BRIDGE OVERHEAD STRUCTURE 27 - BRIDGE PIER OR ABUTMENT 28 - BRIDGE PARAPET 29 - BRIDGE RAIL 30 - GUARDRAIL FACE 31 - GUARDRAIL END 32 - PORTABLE BARRIER 33 - MEDIAN CABLE BARRIER 34 - MEDIAN GUARDRAIL BARRIER 35 - MEDIAN CONCRETE BARRIER 36 - MEDIAN OTHER BARRIER 37 - TRAFFIC SIGN POST 38 - OVERHEAD SIGN POST 39 - LIGHT/LUMINARIES SUPPORT 40 - UTILITY POLE 41 - OTHER POST, POLE OR SUPPORT 42 - CURB 43 - CURB 44 - DITCH 45 - EMBANKMENT 46 - FENCE 47 - MAILBOX 48 - TREE 49 - FIRE HYDRANT 50 - WORK ZONE MAINTENANCE EQUIPMENT 51 - WALL, BUILDING, TUNNEL 52 - OTHER FIXED OBJECT
---	---	---

UNIT SPEED <b>55</b> <input checked="" type="checkbox"/> STATED <input type="checkbox"/> ESTIMATED	POSTED SPEED <b>40</b>	TRAFFIC CONTROL <b>02</b> 01 - NO CONTROLS 02 - STOP SIGN 03 - YIELD SIGN 04 - TRAFFIC SIGNAL 05 - TRAFFIC FLASHERS 06 - SCHOOL ZONE 07 - RAILROAD CROSSBUCKS 08 - RAILROAD FLASHERS 09 - RAILROAD GATES 10 - CONSTRUCTION BARRICADE 11 - PERSON (FLAGGER, OFFICER) 12 - PAVEMENT MARKINGS 13 - CROSSWALK LINES 14 - WALK/DON'T WALK 15 - OTHER 16 - NOT REPORTED	UNIT DIRECTION FROM <b>3</b> TO <b>2</b> 1 - NORTH 2 - SOUTH 3 - EAST 4 - WEST 5 - NORTHEAST 6 - NORTHWEST 7 - SOUTHEAST 8 - SOUTHWEST 9 - UNKNOWN
---	---------------------------	--	--



LOCAL REPORT NUMBER	REPORTING AGENCY MASON POLICE	DATE OF CRASH M 11   D 19   Y 15
IN COUNTY OF WARREN	CRASH LOCATION SR 741   COX SMITH RD	

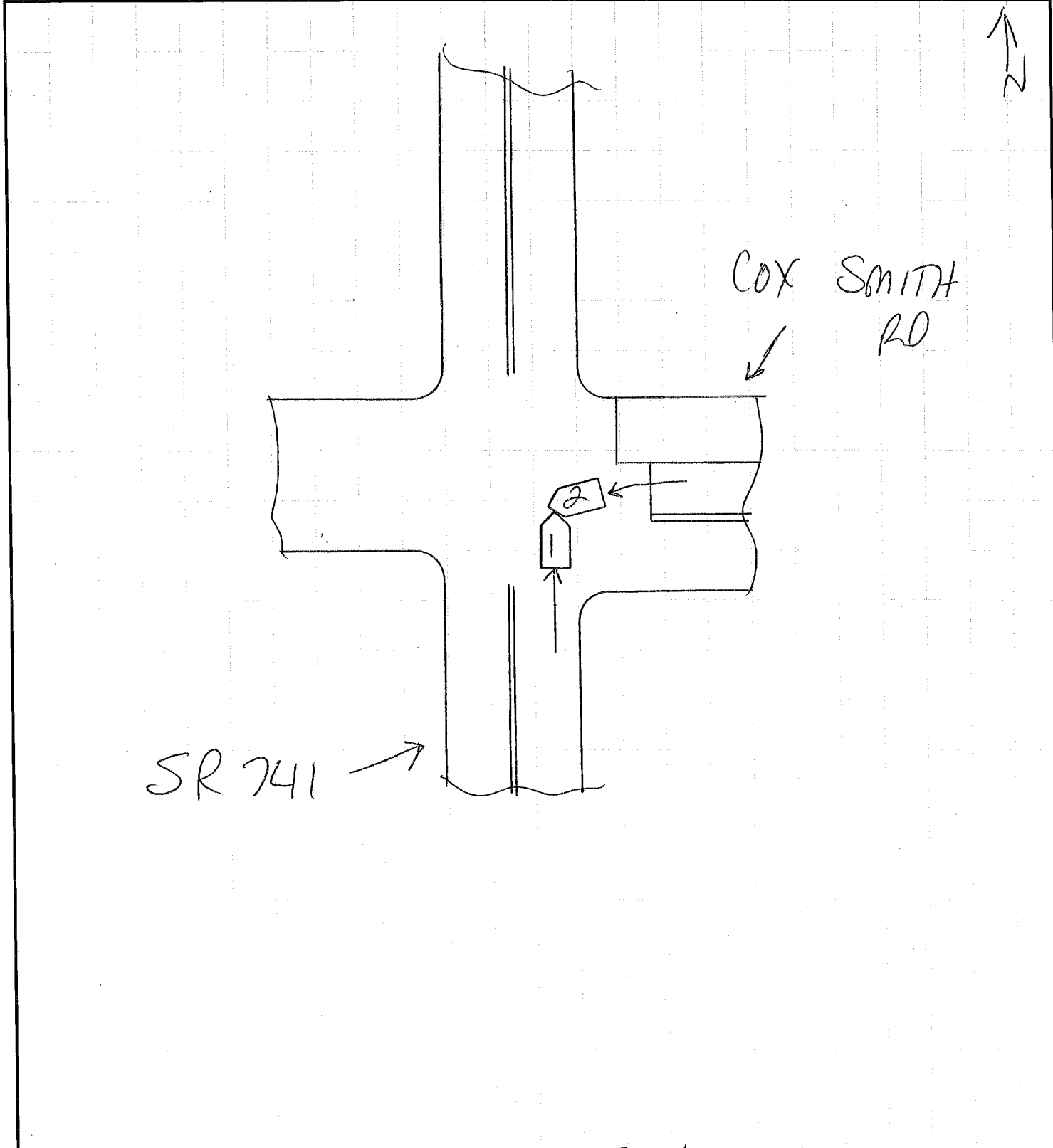

NOT TO SCALE

OFFICER'S SIGNATURE X PO KSB	BADGE NUMBER 35
---------------------------------	--------------------



LOCAL REPORT NUMBER	REPORTING AGENCY <b>MASON POLICE</b>	DATE OF CRASH M   D   Y
---------------------	---	----------------------------

FOR LOCAL USE ONLY – DO NOT SUBMIT TO THE STATE EXCEPT FOR FATAL CRASHES

I, RAY HAMILTON. HEREBY MAKE THIS VOLUNTARY STATEMENT TO  
PRINTED  
P.O. K. S. BRYANT AT \_\_\_\_\_  
OFFICER'S NAME LOCATION

*I was driving north bound on Rt 741 at Cox-Smith Rd. Car in front of me was turning Rt., once that car completed turn, other car pulled out in my path. I locked brakes but couldnt stop before striking car on left front with my right front.*

Q. WERE YOU, OR ANYONE IN YOUR VEHICLE INJURED? NO

Q. WERE YOU WEARING YOUR SEAT BELT? YES

Q. WHAT DIRECTION WERE YOU GOING? NORTH

Q. WHAT WAS YOUR SPEED? 10-15

Q. WERE YOU USING A CELL PHONE AT THE TIME OF THE CRASH? NO

ADDRESS OF WITNESS \_\_\_\_\_ PHONE 513 313 0838

SIGNATURE OF WITNESS X OFFICER'S SIGNATURE X P.K.S.B. jr



LOCAL REPORT NUMBER	REPORTING AGENCY <b>MASON POLICE</b>	DATE OF CRASH M   D   Y
---------------------	---	----------------------------

FOR LOCAL USE ONLY – DO NOT SUBMIT TO THE STATE EXCEPT FOR FATAL CRASHES

I, Brad Girard HEREBY MAKE THIS VOLUNTARY STATEMENT TO  
PRINTED  
P.O. K. S. BRYANT AT \_\_\_\_\_  
OFFICER'S NAME LOCATION

I was waiting to turn left (south) on St. Rt. 741. I saw two cars with turn signals, and an opening to pull out onto the rd from Cox Smith. The second car didn't turn and we collided.

Q. WERE YOU, OR ANYONE IN YOUR VEHICLE INJURED? No

Q. WERE YOU WEARING YOUR SEAT BELT? Yes

Q. WHAT DIRECTION WERE YOU GOING?

Q. WHAT WAS YOUR SPEED? approx 5 m.ph.

Q. WERE YOU USING A CELL PHONE AT THE TIME OF THE CRASH? No

ADDRESS OF WITNESS \_\_\_\_\_ PHONE 931-572-0313

SIGNATURE OF WITNESS X Brad Girard OFFICER'S SIGNATURE X