



TRAFFIC CRASH REPORT

LOCAL REPORT NUMBER *

20160027323

CRASH SEVERITY

3
1 - FATAL
2 - INJURY
3 - PDO

HIT/SKIP

1 - SOLVED
2 - UNSOLVED

LOCAL INFORMATION

<input checked="" type="checkbox"/> PHOTOS TAKEN	<input type="checkbox"/> PDO UNDER STATE REPORTABLE DOLLAR AMOUNT	<input type="checkbox"/> PRIVATE PROPERTY	REPORTING AGENCY NCIC *	REPORTING AGENCY NAME *	NUMBER OF UNITS	UNIT IN ERROR
<input checked="" type="checkbox"/> OH-2 <input type="checkbox"/> OH-1P <input checked="" type="checkbox"/> OH-3 <input type="checkbox"/> OTHER			1081304	MASON PD	1024	99 98 - ANIMAL 99 - UNKNOWN

COUNTY *	CITY *	CITY, VILLAGE, TOWNSHIP *	CRASH DATE *	TIME OF CRASH	DAY OF WEEK
183	<input checked="" type="checkbox"/> CITY <input type="checkbox"/> VILLAGE <input type="checkbox"/> TOWNSHIP	MASON	1071013210116	11154	1SU10W

DEGREES / MINUTES / SECONDS	LONGITUDE	DECIMAL DEGREES	LONGITUDE
0 / 0 / 0	0 0 0	39.3779107	-84.278927

ROADWAY DIVISION	DIVIDED LANE DIRECTION OF TRAVEL	NUMBER OF THRU LANES	ROAD TYPES OR MILEPOST ²
<input type="checkbox"/> DIVIDED <input checked="" type="checkbox"/> UNDIVIDED	<input type="checkbox"/> N - NORTHBOUND E - EASTBOUND <input type="checkbox"/> S - SOUTHBOUND W - WESTBOUND	01	AL - ALLEY CR - CIRCLE HE - HEIGHTS MP - MILEPOST PL - PLACE ST - STREET WA - WAY AV - AVENUE CT - COURT HW - HIGHWAY PK - PARKWAY RD - ROAD TE - TERRACE BL - BOULEVARD DR - DRIVE LA - LANE PI - PIKE SQ - SQUARE TL - TRAIL

LOCATION ROUTE TYPE ¹	LOCATION ROUTE NUMBER	LOC PREFIX N,S,E,W	LOCATION ROAD NAME	LOCATION ROAD TYPE ²	ROUTE TYPES ¹
US	42				IR - INTERSTATE ROUTE (INC. TURNPIKE) CR - NUMBERED COUNTY ROUTE US - US ROUTE TR - NUMBERED TOWNSHIP ROUTE SR - STATE ROUTE

DISTANCE FROM REFERENCE	DIR FROM REF N,S,E,W	REFERENCE ROUTE TYPE ¹	REFERENCE ROUTE NUMBER	REF PREFIX N,S,E,W	REFERENCE NAME (ROAD, MILEPOST, HOUSE #)	REFERENCE ROAD TYPE ²
0					MASON-MORROW-MILLGROVE	RD

REFERENCE POINT USED	CRASH LOCATION	LOCATION OF FIRST HARMFUL EVENT
1 - INTERSECTION 2 - MILE POST 3 - HOUSE NUMBER	03 01 - NOT AN INTERSECTION 02 - FOUR-WAY INTERSECTION 03 - T-INTERSECTION 04 - Y-INTERSECTION 05 - TRAFFIC CIRCLE/ROUNDBOAT 06 - FIVE-POINT, OR MORE 07 - ON RAMP 08 - OFF RAMP 09 - CROSSOVER 10 - DRIVEWAY/ALLEY ACCESS	1 - ON ROADWAY 2 - ON SHOULDER 3 - IN MEDIAN 4 - ON ROADSIDE 5 - ON GORE 6 - OUTSIDE TRAFFICWAY 9 - UNKNOWN

ROAD CONTOUR	ROAD CONDITIONS	WEATHER
1 - STRAIGHT LEVEL 2 - STRAIGHT GRADE 3 - CURVE LEVEL 4 - CURVE GRADE 9 - UNKNOWN	02 PRIMARY SECONDARY	4 1 - CLEAR 2 - CLOUDY 3 - FOG, SMOG, SMOKE 4 - RAIN 5 - SLEET, HAIL 6 - SNOW 7 - SEVERE CROSSWINDS 8 - BLOWING SAND, SOIL, DIRT, SNOW 9 - OTHER/UNKNOWN

MANNER OF CRASH COLLISION/IMPACT	WEATHER
6 1 - NOT COLLISION BETWEEN TWO MOTOR VEHICLES IN TRANSPORT 2 - REAR-END 3 - HEAD-ON 4 - REAR-TO-REAR 5 - BACKING 6 - ANGLE 7 - SIDESWIPE, SAME DIRECTION 8 - SIDESWIPE, OPPOSITE DIRECTION 9 - UNKNOWN	4 1 - CLEAR 2 - CLOUDY 3 - FOG, SMOG, SMOKE 4 - RAIN 5 - SLEET, HAIL 6 - SNOW 7 - SEVERE CROSSWINDS 8 - BLOWING SAND, SOIL, DIRT, SNOW 9 - OTHER/UNKNOWN

ROAD SURFACE	LIGHT CONDITIONS	SCHOOL BUS RELATED
7 1 - CONCRETE 2 - BLACKTOP, BITUMINOUS, ASPHALT 3 - BRICK/BLOCK 4 - SLAG, GRAVEL, STONE 5 - DIRT 6 - OTHER	1 PRIMARY SECONDARY 1 - DAYLIGHT 2 - DAWN 3 - DUSK 4 - DARK - LIGHTED ROADWAY 5 - DARK - ROADWAY NOT LIGHTED 6 - DARK - UNKNOWN ROADWAY LIGHTING 7 - GLARE* 8 - OTHER	<input type="checkbox"/> SCHOOL ZONE RELATED <input type="checkbox"/> YES, SCHOOL BUS DIRECTLY INVOLVED <input type="checkbox"/> YES, SCHOOL BUS INDIRECTLY INVOLVED

WORK ZONE RELATED	WORKERS PRESENT	TYPE OF WORK ZONE	LOCATION OF CRASH IN WORK ZONE
<input type="checkbox"/>	<input type="checkbox"/> LAW ENFORCEMENT PRESENT (OFFICER/VEHICLE) <input type="checkbox"/> LAW ENFORCEMENT PRESENT (VEHICLE ONLY)	1 - LANE CLOSURE 2 - LANE SHIFT/CROSSOVER 3 - WORK ON SHOULDER OR MEDIAN 4 - INTERMITTENT OR MOVING WORK 5 - OTHER	1 - BEFORE THE FIRST WORK ZONE WARNING SIGN 2 - ADVANCE WARNING AREA 3 - TRANSITION AREA 4 - ACTIVITY AREA 5 - TERMINATION AREA

NARRATIVE

UNIT 1 WAS STOPPED AT THE STOP SIGN ON MASON-MORROW-MILLGROVE AT US 42. UNIT 1 STARTED TO MAKE A LEFT TURN WHEN UNIT 2, 3 HEADING NORTH ON US 42, ATTEMPTED TO MAKE A RIGHT TURN ON TO MASON-MORROW-MILLGROVE, AND STRUCK UNIT 1

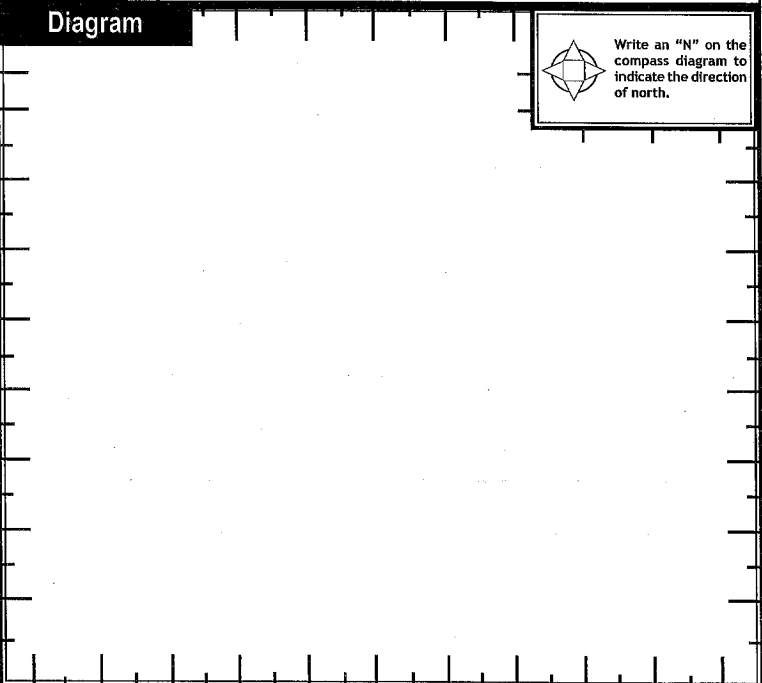

REPORT TAKEN BY	SUPPLEMENT (CORRECTION OR ADDITION TO AN EXISTING REPORT SENT TO ODPS)	DATE CRASH REPORTED	TIME CRASH REPORTED	DISPATCH TIME	ARRIVAL TIME	TIME CLEARED	OTHER INVESTIGATION TIME	TOTAL MINUTES
<input checked="" type="checkbox"/> POLICE AGENCY <input type="checkbox"/> MOTORIST	<input type="checkbox"/>	1071013210116	11154	11155	11240	11241	01020	01061
OFFICER'S NAME *	OFFICER'S BADGE NUMBER	CHECKED BY						
STAFFORD	30	SO						

Unit Number 012	Owner Name: Last, First, Middle (<input type="checkbox"/> Same As Driver) CHAPMAN, GREGORY	Owner Phone Number: Inc. area code (<input type="checkbox"/> Same As Driver) 513-535-6067	Damage Scale 2	
LP State OH	License Plate Number FUL 8388	Vehicle Identification Number 11J346L3181K1815W15715161211011	# Occupants 1011	
Owner Address: City, State, Zip (<input type="checkbox"/> Same As Driver) 443 GRANDIN RIDGE DR MAINEVILLE, OH 45039	Vehicle Year 2010S	Vehicle Make JEEP	Vehicle Model LIBERTY	Vehicle Color BLACK
<input checked="" type="checkbox"/> Proof of Insurance Shown	Insurance Company SAFECO	Policy Number K2929048	Towed By	

Carrier Name, Address, City, State, Zip _____ Carrier Phone- include area code _____

US DOT	Vehicle Weight GVWR/GCWR 1 1 - Less Than or Equal to 10k Lbs. 2 - 10,001 to 26,000 Lbs. 3 - More Than 26,000 Lbs.	Cargo Body Type 01 01 - No Cargo Body Type/Not Applicable 02 - Bus/Van (9-15 Seats, Inc Driver) 03 - Bus (16+ Seats, Inc Driver) 04 - Vehicle Towing Another Vehicle 05 - Logging 06 - Intermodal Container Chassis 07 - Cargo Van/Enclosed Box 08 - Grain, Chips, Gravel	Trafficway Description 1 1 - Two-Way, Not Divided 2 - Two-Way, Not Divided, Continuous Left Turn Lane 3 - Two-Way, Divided, Unprotected (Painted or Grass > 4 FT) Median 4 - Two-Way, Divided, Positive Median Barrier 5 - One-Way Trafficway
HM Placard ID No.	<input type="checkbox"/> Hazardous Material Released	99 - Pole 10 - Cargo Tank 11 - Flat Bed 12 - Dump 13 - Concrete Mixer 14 - Auto Transporter 15 - Garbage/Refuse 99 - Other/Unknown	<input type="checkbox"/> Hit / Skip Unit

Non-Motorist Location Prior to Impact 01 01 - Intersection - Marked Crosswalk 02 - Intersection - No Crosswalk 03 - Intersection - Other 04 - Midblock - Marked Crosswalk 05 - Travel Lane - Other Location 06 - Bicycle Lane 07 - Shoulder/Roadside 08 - Sidewalk 09 - Medial/Crossing Island 10 - Driveway Access 11 - Shared-Use Path or Trail 12 - Non-Trafficway Area 99 - Other/Unknown	Type of Use 1 1 - Personal 2 - Commercial 3 - Government <input type="checkbox"/> In Emergency Response	Unit Type 06 99 - Unknown or Hit / Skip Passenger Vehicles (less than 9 passengers) 01 - Sub-Compact 02 - Compact 03 - Mid Size 04 - Full Size 05 - Minivan 06 - Sport Utility Vehicle 07 - Pickup 08 - Van 09 - Motorcycle 10 - Motorized Bicycle 11 - Snowmobile/ATV 12 - Other Passenger Vehicle	Med/Heavy Trucks or Combo Units > 10k lbs 13 - Single Unit Truck or Van 2axle, 6 tires 14 - Single Unit Truck; 3+ axles 15 - Single Unit Truck / Trailer 16 - Truck/Tractor (Bobtail) 17 - Tractor/Semi-Trailer 18 - Tractor/Double 19 - Tractor/Triples 20 - Other Med/Heavy Vehicle	Bus/Van/Limo (9 or More Including Driver) 21 - Bus/Van (9-15 Seats, Inc Driver) 22 - Bus (16+ Seats, Inc Driver) Non-Motorist 23 - Animal with Rider 24 - Animal with Buggy, Wagon, Surrey 25 - Bicycle/Pedacyclist 26 - Pedestrian/Skater 27 - Other Non-Motorist
--	---	---	---	--

Has HM Placard

Special Function 01 01 - None 02 - Taxi 03 - Rental Truck (Over 10k Lbs) 04 - Bus - School (Public or Private) 05 - Bus - Transit 06 - Bus - Charter 07 - Bus - Shuttle 08 - Bus - Other	09 - Ambulance 10 - Fire 11 - Highway/Maintenance 12 - Military 13 - Police 14 - Public Utility 15 - Other Government 16 - Construction Equip.	17 - Farm Vehicle 18 - Farm Equipment 19 - Motorhome 20 - Golf Cart 21 - Train 22 - Other (Explain in Narrative)	Most Damaged Area 09 01 - None 02 - Center Front 03 - Right Front 04 - Right Side 05 - Right Rear 06 - Rear Center 07 - Left Rear	08 - Left Side 09 - Left Front 10 - Top and Windows 11 - Undercarriage 12 - Load/Trailer 13 - Total(All Areas) 14 - Other	Action 3 1 - Non-Contact 2 - Non-Collision 3 - Striking 4 - Struck 5 - Striking/Struck 9 - Unknown
--	---	---	--	---	--

Pre-Crash Actions 05 99 - Unknown	Motorist 01 - Straight Ahead 02 - Backing 03 - Changing Lanes 04 - Overtaking/Passing 05 - Making Right Turn 06 - Making Left Turn 07 - Making U-Turn 08 - Entering Traffic Lane 09 - Leaving Traffic Lane 10 - Parked 11 - Slowing or Stopped in Traffic 12 - Driverless	13 - Negotiating a Curve 14 - Other Motorist Action	Non-Motorist 15 - Entering or Crossing Specified Location 16 - Walking, Running, Jogging, Playing, Cycling 17 - Working 18 - Pushing Vehicle 19 - Approaching or Leaving Vehicle 20 - Standing 21 - Other Non-Motorist Action
--	---	--	--

Contributing Circumstances 07 99 - Unknown	Motorist 01 - None 02 - Failure to Yield 03 - Ran Red Light 04 - Ran Stop Sign 05 - Exceeded Speed Limit 06 - Unsafe Speed 07 - Improper Turn 08 - Left of Center 09 - Followed Too Closely/ACDA 10 - Improper Lane Change /Passing/Off Road	Non-Motorist 11 - Improper Backing 12 - Improper Start From Parked Position 13 - Stopped or Parked Illegally 14 - Operating Vehicle in Negligent Manner 15 - Swerving to Avoid (Due to External Conditions) 16 - Wrong Side/Wrong Way 17 - Failure to Control 18 - Vision Obstruction 19 - Operating Defective Equipment 20 - Load Shifting/Falling/Spilling 21 - Other Improper Action	Vehicle Defects 01 01 - Turn Signals 02 - Head Lamps 03 - Tail Lamps 04 - Brakes 05 - Steering 06 - Tire Blowout 07 - Worn or Slick tires 08 - Trailer Equipment Defective 09 - Motor Trouble 10 - Disabled From Prior Accident 11 - Other Defects
---	--	--	---

Sequence of Events 1 20 2 00 3 00 4 00 5 00 6 00 First Harmful Event 1 Most Harmful Event 1 99 - Unknown	Non-Collision Events 01 - Overturn/Rollover 02 - Fire/Explosion 03 - Immersion 04 - Jackknife 05 - Cargo/Equipment Loss or Shift 06 - Equipment Failure (Blown Tire, Brake Failure, etc) 07 - Separation of Units 08 - Ran Off Road Right 09 - Ran Off Road Left 10 - Cross Median 11 - Cross Center Line Opposite Direction of Travel 12 - Downhill Runaway 13 - Other Non-Collision
Collision with Person, Vehicle or Object Not Fixed 14 - Pedestrian 15 - Pedalcycle 16 - Railway Vehicle (Train, Engine) 17 - Animal - Farm 18 - Animal - Deer 19 - Animal - Other 20 - Motor Vehicle in Transport 21 - Parked Motor Vehicle 22 - Work Zone Maintenance Equipment 23 - Struck by Falling, Shifting Cargo or Anything Set in Motion by a Motor Vehicle 24 - Other Movable Object 25 - Impact Attenuator/Crash Cushion 26 - Bridge Overhead Structure 27 - Bridge Pier or Abutment 28 - Bridge Parapet 29 - Bridge Rail 30 - Guardrail Face 31 - Guardrail End 32 - Portable Barrier 33 - Median Cable Barrier 34 - Median Guardrail Barrier 35 - Median Concrete Barrier 36 - Median Other Barrier 37 - Traffic Sign Post 38 - Overhead Sign Post 39 - Light/Luminaries Support 40 - Utility Pole 41 - Other Post, Pole or Support 42 - Culvert 43 - Curb 44 - Ditch 45 - Embankment 46 - Fence 47 - Mailbox 48 - Tree 49 - Fire Hydrant 50 - Work Zone Maintenance Equipment 51 - Wall, Building, Tunnel 52 - Other Fixed Object	

Unit Speed 0125	Posted Speed 50	Traffic Control 01 01 - No Controls 02 - Stop Sign 03 - Yield Sign 04 - Traffic Signal 05 - Traffic Flashers 06 - School Zone 07 - Railroad Crossbucks 08 - Railroad Flashers 09 - Railroad Gates 10 - Construction Barricade 11 - Person (Flagger, Officer) 12 - Pavement Markings 13 - Crosswalk Lines 14 - Walk/Don't Walk 15 - Other 16 - Not Reported	Unit Direction From 08 To 07 1 - North 2 - South 3 - East 4 - West 5 - Northeast 6 - Northwest 7 - Southeast 8 - Southwest 9 - Unknown
---------------------------	---------------------------	--	--

OHIO TRAFFIC ACCIDENT - DIAGRAM/NARRATIVE CONTINUATION

OH-2

LOCAL REPORT NUMBER 16-22323	REPORTING AGENCY MASON POLICE	DATE OF ACCIDENT M 7 10 3 12 16
IN COUNTY OF WARREN	ACCIDENT LOCATION US 42 @ MASOM MORROW MILGROVE RD	

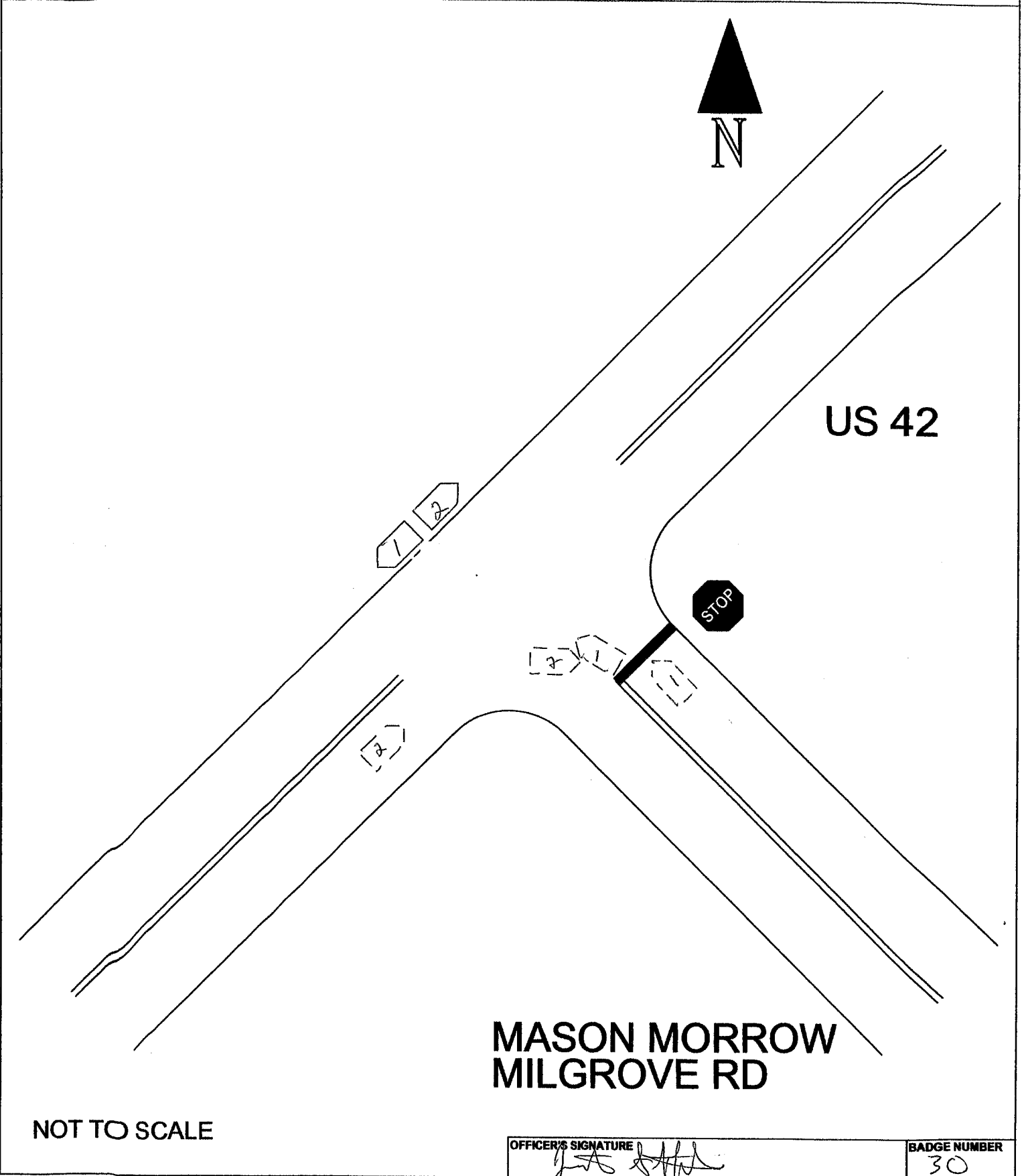

NOT TO SCALE

OFFICER'S SIGNATURE <i>[Signature]</i>	BADGE NUMBER 30
---	--------------------



LOCAL REPORT NUMBER 16-22323	REPORTING AGENCY MASON POLICE	DATE OF CRASH M 7 D 3 Y 16
---------------------------------	----------------------------------	-----------------------------------

FOR LOCAL USE ONLY - DO NOT SUBMIT TO THE STATE EXCEPT FOR FATAL CRASHES

I, Tim Chastan HEREBY MAKE THIS VOLUNTARY STATEMENT TO
PRINTED

P.O. STAFFORD AT 42 + MASON-MORROW-MILGROVE
OFFICER'S NAME LOCATION

I WAS STOPPED AT A STOP SIGN. I TURNED LEFT ONTO US 42. A CAR TRAVELING NORTH ON US 42 ATTEMPTED TO TURN RIGHT (WITH TURN SIGNAL FLASHING) ONTO MASON MORROW MILGROVE ROAD. HER CAR SKID & HIT THE FRONT LEFT CORNER OF THE VEHICLE, PUSHING MY VEHICLE ONTO THE BERM OF THE ROAD.

Angela S. Paff
 12/20/74
 (513) 391-6907

Q. WERE YOU, OR ANYONE IN YOUR VEHICLE INJURED? YES - MIDDLE SHOULDER PAIN

Q. WERE YOU WEARING YOUR SEAT BELT? YES

Q. WHAT DIRECTION WERE YOU GOING? SOUTH

Q. WHAT WAS YOUR SPEED? 5 MPH

Q. WERE YOU USING A CELL PHONE AT THE TIME OF THE CRASH? NO

ADDRESS OF WITNESS
3370 GREEN CREST CT. CINTI OH 45248 PHONE 513 615-7845

SIGNATURE OF WITNESS
 X Tim Chastan

OFFICER'S SIGNATURE
 X [Signature]



LOCAL REPORT NUMBER 16-22323	REPORTING AGENCY MASON POLICE	DATE OF CRASH M 7 D 3 Y 16
---------------------------------	----------------------------------	-----------------------------------

FOR LOCAL USE ONLY -- DO NOT SUBMIT TO THE STATE EXCEPT FOR FATAL CRASHES

I, <u>Colleen Chapman</u> PRINTED	HEREBY MAKE THIS VOLUNTARY STATEMENT TO
P.O. <u>STAFFORD</u> OFFICER'S NAME	AT <u>42 + MASON-MORROW-MILGROVE</u> LOCATION

I was driving down 42 to turn right on Mason Morrow Milgrove and the red SUV pulled out in front of me.

Q. WERE YOU, OR ANYONE IN YOUR VEHICLE INJURED? Knees hit dash board

Q. WERE YOU WEARING YOUR SEAT BELT? YES

Q. WHAT DIRECTION WERE YOU GOING? NORTH

Q. WHAT WAS YOUR SPEED? 25

Q. WERE YOU USING A CELL PHONE AT THE TIME OF THE CRASH? NO

ADDRESS OF WITNESS <u>443 Grandin Ridge Drive</u>	PHONE <u>513-535-6067</u>
--	------------------------------

SIGNATURE OF WITNESS X <u>Colleen Chapman</u>	OFFICER'S SIGNATURE X <u>[Signature]</u>
--	---