



TRAFFIC CRASH REPORT

| | | |
|-----------------------|---|---------------------------------|
| LOCAL REPORT NUMBER * | CRASH SEVERITY | HIT/SKIP |
| 201619900044687 | 3 1 - FATAL 2 - INJURY 3 - PDO | 2 1 - SOLVED 2 - UNSOLVED |

LOCAL INFORMATION

| | | | | | | |
|--|---|--|----------------------------------|---|-----------------------|--|
| <input type="checkbox"/> PHOTOS TAKEN <input checked="" type="checkbox"/> OH-2 <input type="checkbox"/> OH-1P <input type="checkbox"/> OH-3 <input type="checkbox"/> OTHER | <input type="checkbox"/> PDO UNDER STATE REPORTABLE DOLLAR AMOUNT | <input checked="" type="checkbox"/> PRIVATE PROPERTY | REPORTING AGENCY NCIC * 08304 | REPORTING AGENCY NAME * MASON POLICE | NUMBER OF UNITS 02 | UNIT IN ERROR 01 98 - ANIMAL 99 - UNKNOWN |
|--|---|--|----------------------------------|---|-----------------------|--|

| | | | | | |
|----------------|---|------------------------------------|--------------------------|-----------------------|--------------------|
| COUNTY * 83 | <input checked="" type="checkbox"/> CITY * <input type="checkbox"/> VILLAGE * <input type="checkbox"/> TOWNSHIP * | CITY, VILLAGE, TOWNSHIP * MASON | CRASH DATE * 12182016 | TIME OF CRASH 1730 | DAY OF WEEK SUN |
|----------------|---|------------------------------------|--------------------------|-----------------------|--------------------|

| | | | | |
|--|----------------------|----|--|-------------------------|
| DEGREES / MINUTES / SECONDS LATITUDE 0 / / " | LONGITUDE 0 / / " | OR | DECIMAL DEGREES LATITUDE 39.351720 | LONGITUDE -84.323585 |
|--|----------------------|----|--|-------------------------|

| | | | |
|---|--|----------------------------|--|
| ROADWAY DIVISION <input checked="" type="checkbox"/> DIVIDED <input type="checkbox"/> UNDIVIDED | DIVIDED LANE DIRECTION OF TRAVEL <input type="checkbox"/> N - NORTHBOUND <input type="checkbox"/> E - EASTBOUND <input type="checkbox"/> S - SOUTHBOUND <input type="checkbox"/> W - WESTBOUND | NUMBER OF THRU LANES 02 | ROAD TYPES OR MILEPOST ² AL - ALLEY CR - CIRCLE AV - AVENUE CT - COURT BL - BOULEVARD DR - DRIVE HE - HEIGHTS MP - MILEPOST HW - HIGHWAY PK - PARKWAY LA - LANE PI - PIKE PL - PLACE ST - STREET RD - ROAD TE - TERRACE SQ - SQUARE TL - TRAIL |
|---|--|----------------------------|--|

| | | | | | | |
|--|-----------------------------|---------------------------|-------------------------------|---------------------------------------|--|--|
| LOCATION ROUTE TYPE ¹ 45 | LOCATION ROUTE NUMBER 47 | LOC PREFIX N,S, E,W | LOCATION ROAD NAME READING | LOCATION ROAD TYPE ² RD | ROUTE TYPES ¹ IR - INTERSTATE ROUTE (INC. TURNPIKE) US - US ROUTE SR - STATE ROUTE | CR - NUMBERED COUNTY ROUTE TR - NUMBERED TOWNSHIP ROUTE |
|--|-----------------------------|---------------------------|-------------------------------|---------------------------------------|--|--|

| | | | | | | |
|--|---|-----------------------------------|------------------------|---------------------------|---|----------------------------------|
| DISTANCE FROM REFERENCE <input type="checkbox"/> MILES <input type="checkbox"/> FEET <input type="checkbox"/> YARDS | DIR FROM REF <input type="checkbox"/> N,S, <input type="checkbox"/> E,W | REFERENCE ROUTE TYPE ¹ | REFERENCE ROUTE NUMBER | REF PREFIX N,S, E,W | REFERENCE NAME (ROAD, MILEPOST, HOUSE #) 729 | REFERENCE ROAD TYPE ² |
|--|---|-----------------------------------|------------------------|---------------------------|---|----------------------------------|

| | | | | | |
|--|---|---|--|---|---|
| REFERENCE POINT USED 3 1 - INTERSECTION 2 - MILE POST 3 - HOUSE NUMBER | CRASH LOCATION 01 01 - NOT AN INTERSECTION 02 - FOUR-WAY INTERSECTION 03 - T-INTERSECTION 04 - Y-INTERSECTION 05 - TRAFFIC CIRCLE/ROUNDAABOUT | 06 - FIVE-POINT, OR MORE 07 - ON RAMP 08 - OFF RAMP 09 - CROSSOVER 10 - DRIVEWAY/ALLEY ACCESS | 11 - RAILWAY GRADE CROSSING 12 - SHARED-USE PATHS OR TRAILS 99 - UNKNOWN | <input type="checkbox"/> INTERSECTION RELATED | LOCATION OF FIRST HARMFUL EVENT 6 1 - ON ROADWAY 2 - ON SHOULDER 3 - IN MEDIAN 4 - ON ROADSIDE 5 - ON GORE 6 - OUTSIDE TRAFFICWAY 9 - UNKNOWN |
|--|---|---|--|---|---|

| | | | | |
|---|----------------------------------|-----------|---|----------------------------|
| ROAD CONTOUR 1 - STRAIGHT LEVEL 2 - STRAIGHT GRADE 3 - CURVE LEVEL 4 - CURVE GRADE 9 - UNKNOWN | ROAD CONDITIONS PRIMARY 01 | SECONDARY | 01 - DRY 02 - WET 03 - SNOW 04 - ICE 05 - SAND, MUD, DIRT, OIL, GRAVEL 06 - WATER (STANDING, MOVING) 07 - SLUSH 08 - DEBRIS* 09 - RUT, HOLES, BUMPS, UNEVEN PAVEMENT* 10 - OTHER 99 - UNKNOWN | * SECONDARY CONDITION ONLY |
|---|----------------------------------|-----------|---|----------------------------|

| | |
|--|--|
| MANNER OF CRASH COLLISION/IMPACT 2 1 - NOT COLLISION BETWEEN TWO MOTOR VEHICLES IN TRANSPORT 2 - REAR-END 3 - HEAD-ON 4 - REAR-TO-REAR 5 - BACKING 6 - ANGLE 7 - SIDESWIPE, SAME DIRECTION 8 - SIDESWIPE, OPPOSITE DIRECTION 9 - UNKNOWN | WEATHER 2 1 - CLEAR 2 - CLOUDY 3 - FOG, SMOG, SMOKE 4 - RAIN 5 - SLEET, HAIL 6 - SNOW 7 - SEVERE CROSSWINDS 8 - BLOWING SAND, SOIL, DIRT, SNOW 9 - OTHER/UNKNOWN |
|--|--|

| | | | | | |
|---|--|-----------|---|---|----------------------------|
| ROAD SURFACE 2 1 - CONCRETE 2 - BLACKTOP, BITUMINOUS, ASPHALT 3 - BRICK/BLOCK 4 - SLAG, GRAVEL, STONE 5 - DIRT 6 - OTHER | LIGHT CONDITIONS 4 PRIMARY 1 - DAYLIGHT 2 - DAWN 3 - DUSK 4 - DARK - LIGHTED ROADWAY | SECONDARY | 5 - DARK - ROADWAY NOT LIGHTED 6 - DARK - UNKNOWN ROADWAY LIGHTING 7 - GLARE* 8 - OTHER 9 - UNKNOWN | <input type="checkbox"/> SCHOOL BUS RELATED <input type="checkbox"/> SCHOOL ZONE RELATED <input type="checkbox"/> YES, SCHOOL BUS DIRECTLY INVOLVED <input type="checkbox"/> YES, SCHOOL BUS INDIRECTLY INVOLVED | * SECONDARY CONDITION ONLY |
|---|--|-----------|---|---|----------------------------|

| | | | |
|--|---|---|---|
| <input type="checkbox"/> WORK ZONE RELATED | <input type="checkbox"/> WORKERS PRESENT <input type="checkbox"/> LAW ENFORCEMENT PRESENT (OFFICER/VEHICLE) <input type="checkbox"/> LAW ENFORCEMENT PRESENT (VEHICLE ONLY) | TYPE OF WORK ZONE 1 - LANE CLOSURE 2 - LANE SHIFT/CROSSOVER 3 - WORK ON SHOULDER OR MEDIAN 4 - INTERMITTENT OR MOVING WORK 5 - OTHER | LOCATION OF CRASH IN WORK ZONE 1 - BEFORE THE FIRST WORK ZONE WARNING SIGN 2 - ADVANCE WARNING AREA 3 - TRANSITION AREA 4 - ACTIVITY AREA 5 - TERMINATION AREA |
|--|---|---|---|

NARRATIVE
UNIT #2 WAS PARKED UNOCCUPIED, FACING NORTH ON RIPPER PARKING LOT OF THE LUCKY DOG GRILLE. UNIT #2 WAS STRUCK BY ANOTHER VEHICLE, WHICH DEPARTED THE AREA. NO INFORMATION WAS GIVEN FOR UNIT #2 / THE HIT SKIP UNIT.

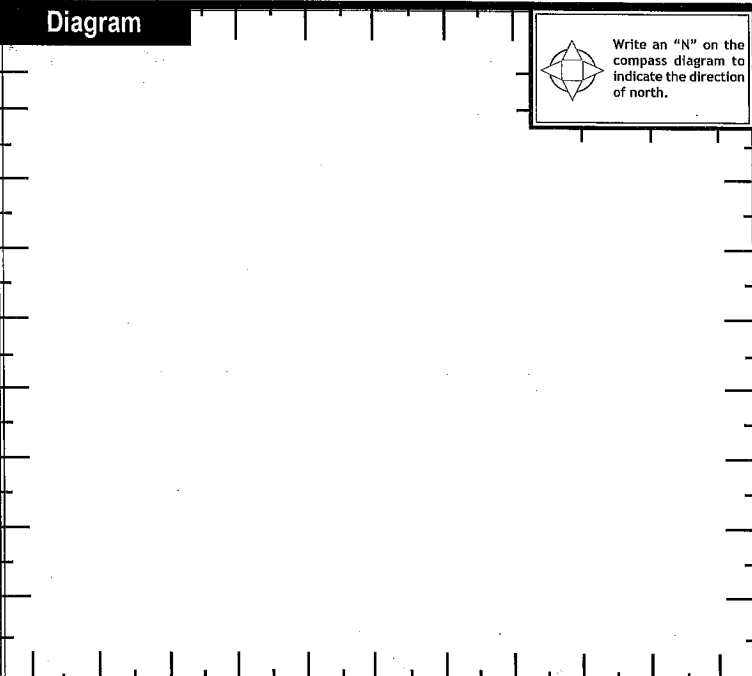

| | | | | | | | | |
|---|---|---------------------------------|-----------------------------|-----------------------|----------------------|----------------------|---------------------------------|----------------------|
| REPORT TAKEN BY <input checked="" type="checkbox"/> POLICE AGENCY <input type="checkbox"/> MOTORIST | <input type="checkbox"/> SUPPLEMENT (CORRECTION OR ADDITION TO AN EXISTING REPORT SENT TO ODPS) | DATE CRASH REPORTED 12182016 | TIME CRASH REPORTED 1457 | DISPATCH TIME 1457 | ARRIVAL TIME 1511 | TIME CLEARED 1520 | OTHER INVESTIGATION TIME 160 | TOTAL MINUTES 169 |
| OFFICER'S NAME * CALEB CONN | OFFICER'S BADGE NUMBER 31 | CHECKED BY 37 | PAGE | OF | | | | |



MOTORIST / Non-MOTORIST / OCCUPANT

LOCAL REPORT NUMBER

20160000044687

| | | | | |
|---------------------------|---------------------------|---------------|----------------------------------|----------------------------------|
| UNIT NUMBER 011 | NAME: LAST, FIRST, MIDDLE | DATE OF BIRTH | AGE | GENDER F - FEMALE M - MALE |
| ADDRESS, CITY, STATE, ZIP | | | CONTACT PHONE- INCLUDE AREA CODE | |

| | | | | | | | | | | | |
|--|-------------------------|------------|--------------------------------------|------------------------------------|------------------------------------|--|---------------------------|----------------------|---------------------|------------------|----------------|
| INJURIES | INJURED TAKEN BY | EMS AGENCY | MEDICAL FACILITY INJURED TAKEN TO | SAFETY EQUIPMENT USED 99 | DOT COMPLIANT MOTORCYCLE HELMET | SEATING POSITION 01 | AIR BAG USAGE 1 | EJECTION 1 | TRAPPED 1 | | |
| OL STATE | OPERATOR LICENSE NUMBER | OL CLASS | No <input type="checkbox"/> VALID OL | M/C END. <input type="checkbox"/> | CONDITION | ALCOHOL/DRUG SUSPECTED | ALCOHOL TEST STATUS | ALCOHOL TEST TYPE | ALCOHOL TEST VALUE | DRUG TEST STATUS | DRUG TEST TYPE |
| OFFENSE CHARGED (<input type="checkbox"/> LOCAL CODE) | OFFENSE DESCRIPTION | | | CITATION NUMBER | | HANDS-FREE <input type="checkbox"/> DEVICE USED | DRIVER DISTRACTED BY | | | | |

| | | | | |
|---------------------------|---------------------------|---------------|----------------------------------|----------------------------------|
| UNIT NUMBER | NAME: LAST, FIRST, MIDDLE | DATE OF BIRTH | AGE | GENDER F - FEMALE M - MALE |
| ADDRESS, CITY, STATE, ZIP | | | CONTACT PHONE- INCLUDE AREA CODE | |

| | | | | | | | | | | | |
|--|-------------------------|------------|--------------------------------------|-----------------------------------|------------------------------------|--|----------------------|-------------------|--------------------|------------------|----------------|
| INJURIES | INJURED TAKEN BY | EMS AGENCY | MEDICAL FACILITY INJURED TAKEN TO | SAFETY EQUIPMENT USED | DOT COMPLIANT MOTORCYCLE HELMET | SEATING POSITION | AIR BAG USAGE | EJECTION | TRAPPED | | |
| OL STATE | OPERATOR LICENSE NUMBER | OL CLASS | No <input type="checkbox"/> VALID OL | M/C END. <input type="checkbox"/> | CONDITION | ALCOHOL/DRUG SUSPECTED | ALCOHOL TEST STATUS | ALCOHOL TEST TYPE | ALCOHOL TEST VALUE | DRUG TEST STATUS | DRUG TEST TYPE |
| OFFENSE CHARGED (<input type="checkbox"/> LOCAL CODE) | OFFENSE DESCRIPTION | | | CITATION NUMBER | | HANDS-FREE <input type="checkbox"/> DEVICE USED | DRIVER DISTRACTED BY | | | | |

| | | | | |
|--|---|---|---|---|
| INJURIES | INJURED TAKEN BY | SAFETY EQUIPMENT USED | 99 - UNKNOWN SAFETY EQUIPMENT | Non-MOTORIST |
| 1 - NO INJURY / NONE REPORTED 2 - POSSIBLE 3 - NON-INCAPACITATING 4 - INCAPACITATING 5 - FATAL | 1 - NOT TRANSPORTED / TREATED AT SCENE 2 - EMS 3 - POLICE 4 - OTHER 9 - UNKNOWN | MOTORIST 01 - NONE USED - VEHICLE OCCUPANT 02 - SHOULDER BELT ONLY USED 03 - LAP BELT ONLY USED 04 - SHOULDER AND LAP BELT USED | 05 - CHILD RESTRAINT SYSTEM-FORWARD FACING 06 - CHILD RESTRAINT SYSTEM- REAR FACING 07 - BOOSTER SEAT 08 - HELMET USED | 09 - NONE USED 10 - HELMET USED 11 - PROTECTIVE PADS USED (ELBOWS, KNEES, ETC) 12 - REFLECTIVE CLOTHING 13 - LIGHTING 14 - OTHER |

| | | | |
|--|--|--|---|
| SEATING POSITION | 07 - THIRD - LEFT SIDE (MOTORCYCLE SIDE CAR) | 12 - PASSENGER IN UNENCLOSED CARGO AREA | AIR BAG USAGE |
| 01 - FRONT - LEFT SIDE (MOTORCYCLE DRIVER) 02 - FRONT - MIDDLE 03 - FRONT - RIGHT SIDE 04 - SECOND - LEFT SIDE (MOTORCYCLE PASSENGER) 05 - SECOND - MIDDLE 06 - SECOND - RIGHT SIDE | 08 - THIRD - MIDDLE 09 - THIRD - RIGHT SIDE 10 - SLEEPER SECTION OF CAB (TRUCK) 11 - PASSENGER IN OTHER ENCLOSED CARGO AREA (NON-TRAILING UNIT SUCH AS A BUS, PICK-UP WITH CAP) | 13 - TRAILING UNIT 14 - RIDING ON VEHICLE EXTERIOR (NON-TRAILING UNIT) 15 - NON-MOTORIST 16 - OTHER 99 - UNKNOWN | 1 - NOT DEPLOYED 2 - DEPLOYED FRONT 3 - DEPLOYED SIDE 4 - DEPLOYED BOTH FRONT/SIDE 5 - NOT APPLICABLE 9 - DEPLOYMENT UNKNOWN |

| | | | | |
|---|---|---|---|---|
| EJECTION | TRAPPED | OPERATOR LICENSE CLASS | CONDITION | ALCOHOL/DRUG SUSPECTED |
| 1 - NOT EJECTED 2 - TOTALLY EJECTED 3 - PARTIALLY EJECTED 4 - NOT APPLICABLE | 1 - NOT TRAPPED 2 - EXTRICATED BY MECHANICAL MEANS 3 - EXTRICATED BY NON-MECHANICAL MEANS | 1 - CLASS A 2 - CLASS B 3 - CLASS C 4 - REGULAR CLASS (OHIO IS "D") 5 - MC/MOPED ONLY | 1 - APPARENTLY NORMAL 2 - PHYSICAL IMPAIRMENT 3 - EMOTIONAL (DEPRESSED, ANGRY, DISTURBED) 4 - ILLNESS 5 - FELL ASLEEP, FAINTED, FATIGUED 6 - UNDER THE INFLUENCE OF MEDICATIONS, DRUGS, ALCOHOL 7 - OTHER | 1 - NONE 2 - YES - ALCOHOL SUSPECTED 3 - YES - HBD NOT IMPAIRED 4 - YES - DRUGS SUSPECTED 5 - YES - ALCOHOL AND DRUGS SUSPECTED |

| | | | | |
|--|---|--|---|---|
| ALCOHOL TEST STATUS | ALCOHOL TEST TYPE | DRUG TEST STATUS | DRUG TEST TYPE | DRIVER DISTRACTED BY |
| 1 - NONE GIVEN 2 - TEST REFUSED 3 - TEST GIVEN, CONTAMINATED SAMPLE/UNUSABLE 4 - TEST GIVEN, RESULTS KNOWN 5 - TEST GIVEN, RESULTS UNKNOWN | 1 - NONE 2 - BLOOD 3 - URINE 4 - BREATH 5 - OTHER | 1 - NONE GIVEN 2 - TEST REFUSED 3 - TEST GIVEN, CONTAMINATED SAMPLE/UNUSABLE 4 - TEST GIVEN, RESULTS KNOWN 5 - TEST GIVEN, RESULTS UNKNOWN | 1 - NONE 2 - BLOOD 3 - URINE 4 - OTHER | 1 - NO DISTRACTION REPORTED 2 - PHONE 3 - TEXTING/E-MAILING 4 - ELECTRONIC COMMUNICATION DEVICE 5 - OTHER ELECTRONIC DEVICE (NAVIGATION DEVICE, RADIO, DVD) 6 - OTHER INSIDE THE VEHICLE 7 - EXTERNAL DISTRACTION |

| | | | | |
|---------------------------|---------------------------|---------------|----------------------------------|----------------------------------|
| UNIT NUMBER | NAME: LAST, FIRST, MIDDLE | DATE OF BIRTH | AGE | GENDER F - FEMALE M - MALE |
| ADDRESS, CITY, STATE, ZIP | | | CONTACT PHONE- INCLUDE AREA CODE | |

| | | | | | | | | | |
|---------------------------|---------------------------|---------------|-----------------------------------|----------------------------------|------------------------------------|------------------|---------------|----------|---------|
| INJURIES | INJURED TAKEN BY | EMS AGENCY | MEDICAL FACILITY INJURED TAKEN TO | SAFETY EQUIPMENT USED | DOT COMPLIANT MOTORCYCLE HELMET | SEATING POSITION | AIR BAG USAGE | EJECTION | TRAPPED |
| UNIT NUMBER | NAME: LAST, FIRST, MIDDLE | DATE OF BIRTH | AGE | GENDER F - FEMALE M - MALE | | | | | |
| ADDRESS, CITY, STATE, ZIP | | | CONTACT PHONE- INCLUDE AREA CODE | | | | | | |

| | | | | | | | | | |
|----------|------------------|------------|-----------------------------------|-----------------------|------------------------------------|------------------|---------------|----------|---------|
| INJURIES | INJURED TAKEN BY | EMS AGENCY | MEDICAL FACILITY INJURED TAKEN TO | SAFETY EQUIPMENT USED | DOT COMPLIANT MOTORCYCLE HELMET | SEATING POSITION | AIR BAG USAGE | EJECTION | TRAPPED |
|----------|------------------|------------|-----------------------------------|-----------------------|------------------------------------|------------------|---------------|----------|---------|



UNIT

LOCAL REPORT NUMBER
20160000044687

| | | | | |
|---------------------------|---|---|--------------------------|------------------|
| UNIT NUMBER 011 | OWNER NAME: LAST, FIRST, MIDDLE (<input type="checkbox"/> SAME AS DRIVER) | OWNER PHONE NUMBER - INC. AREA CODE (<input type="checkbox"/> SAME AS DRIVER) | DAMAGE SCALE 0 | DAMAGED AREA |
|---------------------------|---|---|--------------------------|------------------|

OWNER ADDRESS: CITY, STATE, ZIP (SAME AS DRIVER)

| | | | |
|----------|----------------------|-------------------------------|-------------|
| LP STATE | LICENSE PLATE NUMBER | VEHICLE IDENTIFICATION NUMBER | # OCCUPANTS |
|----------|----------------------|-------------------------------|-------------|

| | | | |
|--------------|--------------|---------------|---------------|
| VEHICLE YEAR | VEHICLE MAKE | VEHICLE MODEL | VEHICLE COLOR |
|--------------|--------------|---------------|---------------|

| | | | |
|---|-------------------|---------------|----------|
| <input type="checkbox"/> PROOF OF INSURANCE SHOWN | INSURANCE COMPANY | POLICY NUMBER | TOWED BY |
|---|-------------------|---------------|----------|

CARRIER NAME, ADDRESS, CITY, STATE, ZIP

CARRIER PHONE- INCLUDE AREA CODE

| | | | |
|--------|--|---|---|
| US DOT | VEHICLE WEIGHT GVWR/GCWR 1 1 - LESS THAN OR EQUAL TO 10K LBS. 2 - 10,001 TO 26,000 LBS. 3 - MORE THAN 26,000 LBS. | CARGO BODY TYPE 01 01 - No Cargo Body Type/Not Applicable 02 - Bus/Van (9-15 SEATS, INC DRIVER) 03 - Bus (16+ SEATS, INC DRIVER) 04 - VEHICLE TOWING ANOTHER VEHICLE 05 - LOGGING 06 - INTERMODAL CONTAINER CHASSIS 07 - CARGO VAN/ENCLOSED BOX 08 - GRAIN, CHIPS, GRAVEL | TRAFFICWAY DESCRIPTION 1 1 - Two-Way, Not Divided 2 - Two-Way, Not Divided, Continuous Left Turn Lane 3 - Two-Way, Divided, Unprotected (Painted or Grass > 4 Ft.) Median 4 - Two-Way, Divided, Positive Median Barrier 5 - One-Way Trafficway |
|--------|--|---|---|

| | | | | | | | | |
|-------------------|-----------------|--|--|---|--|---|---|---|
| HM PLACARD ID No. | HM CLASS NUMBER | <input type="checkbox"/> HAZARDOUS MATERIAL RELEASED | NON-MOTORIST LOCATION PRIOR TO IMPACT 01 01 - INTERSECTION - MARKED CROSSWALK 02 - INTERSECTION - NO CROSSWALK 03 - INTERSECTION - OTHER 04 - MIDBLOCK - MARKED CROSSWALK 05 - TRAVEL LANE - OTHER LOCATION 06 - BICYCLE LANE 07 - SHOULDER/ROADSIDE 08 - SIDEWALK 09 - MEDIUM/CROSSING ISLAND 10 - DRIVEWAY ACCESS 11 - SHARED-USE PATH OR TRAIL 12 - NON-TRAFFICWAY AREA 99 - OTHER/UNKNOWN | TYPE OF USE 1 1 - PERSONAL 2 - COMMERCIAL 3 - GOVERNMENT <input type="checkbox"/> IN EMERGENCY RESPONSE | UNIT TYPE 99 99 - UNKNOWN OR HIT / SKIP | PASSENGER VEHICLES (LESS THAN 9 PASSENGERS) 01 - SUB-COMPACT 02 - COMPACT 03 - MID SIZE 04 - FULL SIZE 05 - MINIVAN 06 - SPORT UTILITY VEHICLE 07 - PICKUP 08 - VAN 09 - MOTORCYCLE 10 - MOTORIZED BICYCLE 11 - SNOWMOBILE/ATV 12 - OTHER PASSENGER VEHICLE | MED/HEAVY TRUCKS OR COMBO UNITS > 10K LBS 13 - SINGLE UNIT TRUCK OR VAN 2AXLE, 6 TIRES 14 - SINGLE UNIT TRUCK; 3+ AXLES 15 - SINGLE UNIT TRUCK / TRAILER 16 - TRUCK/TRACTOR (BOBTAIL) 17 - TRACTOR/SEMI-TRAILER 18 - TRACTOR/DOUBLE 19 - TRACTOR/TRIPLES 20 - OTHER MED/HEAVY VEHICLE | BUS/VAN/LIMO (9 OR MORE INCLUDING DRIVER) 21 - BUS/VAN (9-15 SEATS, INC DRIVER) 22 - BUS (16+ SEATS, INC DRIVER) NON-MOTORIST 23 - ANIMAL WITH RIDER 24 - ANIMAL WITH BUGGY, WAGON, SURREY 25 - BICYCLE/PEDACYCLIST 26 - PEDESTRIAN/SKATER 27 - OTHER NON-MOTORIST |
|-------------------|-----------------|--|--|---|--|---|---|---|

| | | | | | | |
|--|---|---|--|---|--------------|--|
| SPECIAL FUNCTION 01 01 - NONE 02 - TAXI 03 - RENTAL TRUCK (Over 10k Lbs) 04 - BUS - SCHOOL (PUBLIC OR PRIVATE) 05 - BUS - TRANSIT 06 - BUS - CHARTER 07 - BUS - SHUTTLE 08 - BUS - OTHER | 09 - AMBULANCE 10 - FIRE 11 - HIGHWAY/MAINTENANCE 12 - MILITARY 13 - POLICE 14 - PUBLIC UTILITY 15 - OTHER GOVERNMENT 16 - CONSTRUCTION EQUIP. | 17 - FARM VEHICLE 18 - FARM EQUIPMENT 19 - MOTORHOME 20 - GOLF CART 21 - TRAIN 22 - OTHER (EXPLAIN IN NARRATIVE) | MOST DAMAGED AREA 02 01 - NONE 02 - CENTER FRONT 03 - RIGHT FRONT 04 - RIGHT SIDE 05 - RIGHT REAR 06 - REAR CENTER 07 - LEFT REAR | 08 - LEFT SIDE 09 - LEFT FRONT 10 - TOP AND WINDOWS 11 - UNDERCARRIAGE 12 - LOAD/TRAILER 13 - TOTAL(ALL AREAS) 14 - OTHER | 99 - UNKNOWN | ACTION 3 1 - NON-CONTACT 2 - NON-COLLISION 3 - STRIKING 4 - STRUCK 5 - STRIKING/STRUCK 9 - UNKNOWN |
|--|---|---|--|---|--------------|--|

| | | | | | |
|--|--|---|--|--|--------------------------------|
| PRE-CRASH ACTIONS 01 99 - UNKNOWN | MOTORIST 01 - STRAIGHT AHEAD 02 - BACKING 03 - CHANGING LANES 04 - OVERTAKING/PASSING 05 - MAKING RIGHT TURN 06 - MAKING LEFT TURN | 07 - MAKING U-TURN 08 - ENTERING TRAFFIC LANE 09 - LEAVING TRAFFIC LANE 10 - PARKED 11 - SLOWING OR STOPPED IN TRAFFIC 12 - DRIVERLESS | 13 - NEGOTIATING A CURVE 14 - OTHER MOTORIST ACTION | NON-MOTORIST 15 - ENTERING OR CROSSING SPECIFIED LOCATION 16 - WALKING, RUNNING, JOGGING, PLAYING, CYCLING 17 - WORKING 18 - PUSHING VEHICLE 19 - APPROACHING OR LEAVING VEHICLE 20 - STANDING | 21 - OTHER NON-MOTORIST ACTION |
|--|--|---|--|--|--------------------------------|

| | | | | |
|----------------------------|--|--|---|---|
| CONTRIBUTING CIRCUMSTANCES | MOTORIST 01 - NONE 02 - FAILURE TO YIELD 03 - RAN RED LIGHT 04 - RAN STOP SIGN 05 - EXCEEDED SPEED LIMIT 06 - UNSAFE SPEED 07 - IMPROPER TURN 08 - LEFT OF CENTER 09 - FOLLOWED TOO CLOSELY/ACDA 10 - IMPROPER LANE CHANGE /PASSING/OFF ROAD | 11 - IMPROPER BACKING 12 - IMPROPER START FROM PARKED POSITION 13 - STOPPED OR PARKED ILLEGALLY 14 - OPERATING VEHICLE IN NEGLIGENT MANNER 15 - SWERVING TO AVOID (DUE TO EXTERNAL CONDITIONS) 16 - WRONG SIDE/WRONG WAY 17 - FAILURE TO CONTROL 18 - VISION OBSTRUCTION 19 - OPERATING DEFECTIVE EQUIPMENT 20 - LOAD SHIFTING/FALLING/SPILLING 21 - OTHER IMPROPER ACTION | NON-MOTORIST 22 - NONE 23 - IMPROPER CROSSING 24 - DARTING 25 - LYING AND/OR ILLEGALLY IN ROADWAY 26 - FAILURE TO YIELD RIGHT OF WAY 27 - NOT VISIBLE (DARK CLOTHING) 28 - INATTENTIVE 29 - FAILURE TO OBEY TRAFFIC SIGNS /SIGNALS/OFFICER 30 - WRONG SIDE OF THE ROAD 31 - OTHER NON-MOTORIST ACTION | VEHICLE DEFECTS 01 01 - TURN SIGNALS 02 - HEAD LAMPS 03 - TAIL LAMPS 04 - BRAKES 05 - STEERING 06 - TIRE BLOWOUT 07 - WORN OR SLICK TIRES 08 - TRAILER EQUIPMENT DEFECTIVE 09 - MOTOR TROUBLE 10 - DISABLED FROM PRIOR ACCIDENT 11 - OTHER DEFECTS |
|----------------------------|--|--|---|---|

| | | | |
|--|---|--|---|
| SEQUENCE OF EVENTS 1 211 2 00 3 00 4 00 5 00 6 00 | NON-COLLISION EVENTS 01 - OVERTURN/ROLLOVER 02 - FIRE/EXPLOSION 03 - IMMERSION 04 - JACKKNIFE 05 - CARGO/EQUIPMENT LOSS OR SHIFT | 06 - EQUIPMENT FAILURE (Blown Tire, Brake Failure, etc) 07 - SEPARATION OF UNITS 08 - RAN OFF ROAD RIGHT 09 - RAN OFF ROAD LEFT | 10 - CROSS MEDIAN 11 - CROSS CENTER LINE OPPOSITE DIRECTION OF TRAVEL 12 - DOWNHILL RUNAWAY 13 - OTHER NON-COLLISION |
|--|---|--|---|

| | | | | | |
|---|---|--|--|--|--|
| COLLISION WITH PERSON, VEHICLE OR OBJECT NOT FIXED 14 - PEDESTRIAN 15 - PEDALCYCLE 16 - RAILWAY VEHICLE (TRAIN,ENGINE) 17 - ANIMAL - FARM 18 - ANIMAL - DEER 19 - ANIMAL - OTHER 20 - MOTOR VEHICLE IN TRANSPORT | 21 - PARKED MOTOR VEHICLE 22 - WORK ZONE MAINTENANCE EQUIPMENT 23 - STRUCK BY FALLING, SHIFTING CARGO OR ANYTHING SET IN MOTION BY A MOTOR VEHICLE 24 - OTHER MOVABLE OBJECT | COLLISION WITH FIXED OBJECT 25 - IMPACT ATTENUATOR/CRASH CUSHION 26 - BRIDGE OVERHEAD STRUCTURE 27 - BRIDGE PIER OR ABUTMENT 28 - BRIDGE PARAPET 29 - BRIDGE RAIL 30 - GUARDRAIL FACE 31 - GUARDRAIL END 32 - PORTABLE BARRIER | 33 - MEDIAN CABLE BARRIER 34 - MEDIAN GUARDRAIL BARRIER 35 - MEDIAN CONCRETE BARRIER 36 - MEDIAN OTHER BARRIER 37 - TRAFFIC SIGN POST 38 - OVERHEAD SIGN POST 39 - LIGHT/LUMINARIES SUPPORT 40 - UTILITY POLE | 41 - OTHER POST, POLE OR SUPPORT 42 - CULVERT 43 - CURB 44 - DITCH 45 - EMBANKMENT 46 - FENCE 47 - MAILBOX | 48 - TREE 49 - FIRE HYDRANT 50 - WORK ZONE MAINTENANCE EQUIPMENT 51 - WALL, BUILDING, TUNNEL 52 - OTHER FIXED OBJECT |
|---|---|--|--|--|--|

| | | | | | | |
|------------------------|---------------------------|--|--|---|---|---|
| UNIT SPEED 5 | POSTED SPEED 12 | TRAFFIC CONTROL 01 - NO CONTROLS 02 - STOP SIGN 03 - YIELD SIGN 04 - TRAFFIC SIGNAL 05 - TRAFFIC FLASHERS 06 - SCHOOL ZONE | 07 - RAILROAD CROSSBUCKS 08 - RAILROAD FLASHERS 09 - RAILROAD GATES 10 - CONSTRUCTION BARRICADE 11 - PERSON (FLAGGER, OFFICER) 12 - PAVEMENT MARKINGS | 13 - CROSSWALK LINES 14 - WALK/DON'T WALK 15 - OTHER 16 - NOT REPORTED | UNIT DIRECTION FROM 1 TO 2 1 - NORTH 2 - SOUTH 3 - EAST 4 - WEST | 5 - NORTHEAST 6 - NORTHWEST 7 - SOUTHEAST 8 - SOUTHWEST 9 - UNKNOWN |
|------------------------|---------------------------|--|--|---|---|---|



UNIT

LOCAL REPORT NUMBER

20116100010044687

| | | | | |
|---|---|--|--------------------------|------------------|
| UNIT NUMBER 1012 | OWNER NAME: LAST, FIRST, MIDDLE (<input type="checkbox"/> SAME AS DRIVER) COPLIN, TYLER | OWNER PHONE NUMBER - INC. AREA CODE (<input type="checkbox"/> SAME AS DRIVER) 513-885-3902 | DAMAGE SCALE 2 | DAMAGED AREA |
| OWNER ADDRESS: CITY, STATE, ZIP (<input type="checkbox"/> SAME AS DRIVER) 6139 RIDGE AVE. ; CINCINNATI OH 45213 | | | 1 - NONE | |
| LP STATE OH | LICENSE PLATE NUMBER EJS1257 | VEHICLE IDENTIFICATION NUMBER 1BNWRJ211K48M118202 | 2 - MINOR | |
| VEHICLE YEAR 2010 | VEHICLE MAKE VOLKSWAGEN | VEHICLE MODEL JETTA | 3 - FUNCTIONAL | |
| PROOF OF INSURANCE SHOWN <input checked="" type="checkbox"/> | INSURANCE COMPANY SAFECO INS | POLICY NUMBER K0703065 | 4 - DISABLING | |
| CARRIER NAME, ADDRESS, CITY, STATE, ZIP | | | 9 - UNKNOWN | |

| | | | |
|-------------------|--|---|---|
| US DOT | VEHICLE WEIGHT GVWR/GCWR 1 1 - LESS THAN OR EQUAL TO 10K LBS. 2 - 10,001 TO 26,000 LBS. 3 - MORE THAN 26,000 LBS. | CARGO BODY TYPE 01 01 - NO CARGO BODY TYPE/NOT APPLICABLE 02 - BUS/VAN (9-15 SEATS, INC DRIVER) 03 - BUS (16+ SEATS, INC DRIVER) 04 - VEHICLE TOWING ANOTHER VEHICLE 05 - LOGGING 06 - INTERMODAL CONTAINER CHASSIS 07 - CARGO VAN/ENCLOSED BOX 08 - GRAIN, CHIPS, GRAVEL | TRAFFICWAY DESCRIPTION 1 1 - TWO-WAY, NOT DIVIDED 2 - TWO-WAY, NOT DIVIDED, CONTINUOUS LEFT TURN LANE 3 - TWO-WAY, DIVIDED, UNPROTECTED (PAINTED OR GRASS > 4 FT.) MEDIAN 4 - TWO-WAY, DIVIDED, POSITIVE MEDIAN BARRIER 5 - ONE-WAY TRAFFICWAY |
| HM PLACARD ID No. | <input type="checkbox"/> HAZARDOUS MATERIAL RELEASED | 09 - POLE 10 - CARGO TANK 11 - FLAT BED 12 - DUMP 13 - CONCRETE MIXER 14 - AUTO TRANSPORTER 15 - GARBAGE/REFUSE 99 - OTHER/UNKNOWN | <input type="checkbox"/> HIT / SKIP UNIT |
| HM CLASS NUMBER | | | |

| | | | | | |
|--|---|--|---|---|---|
| NON-MOTORIST LOCATION PRIOR TO IMPACT 01 01 - INTERSECTION - MARKED CROSSWALK 02 - INTERSECTION - NO CROSSWALK 03 - INTERSECTION - OTHER 04 - MIDBLOCK - MARKED CROSSWALK 05 - TRAVEL LANE - OTHER LOCATION 06 - BICYCLE LANE 07 - SHOULDER/ROADSIDE 08 - SIDEWALK 09 - MEDIAN/CROSSING ISLAND 10 - DRIVEWAY ACCESS 11 - SHARED-USE PATH OR TRAIL 12 - NON-TRAFFICWAY AREA 99 - OTHER/UNKNOWN | TYPE OF USE 1 1 - PERSONAL 2 - COMMERCIAL 3 - GOVERNMENT <input type="checkbox"/> IN EMERGENCY RESPONSE | UNIT TYPE 02 99 - UNKNOWN OR HIT / SKIP | PASSENGER VEHICLES (LESS THAN 9 PASSENGERS) 01 - SUB-COMPACT 02 - COMPACT 03 - MID SIZE 04 - FULL SIZE 05 - MINIVAN 06 - SPORT UTILITY VEHICLE 07 - PICKUP 08 - VAN 09 - MOTORCYCLE 10 - MOTORIZED BICYCLE 11 - SNOWMOBILE/ATV 12 - OTHER PASSENGER VEHICLE | MED/HEAVY TRUCKS OR COMBO UNITS > 10K LBS 13 - SINGLE UNIT TRUCK OR VAN 2AXLE, 6 TIRES 14 - SINGLE UNIT TRUCK; 3+ AXLES 15 - SINGLE UNIT TRUCK / TRAILER 16 - TRUCK/TRACTOR (BOBTAIL) 17 - TRACTOR/SEMI-TRAILER 18 - TRACTOR/DOUBLE 19 - TRACTOR/TRIPLES 20 - OTHER MED/HEAVY VEHICLE | BUS/VAN/LIMO (9 OR MORE INCLUDING DRIVER) 21 - BUS/VAN (9-15 SEATS, INC DRIVER) 22 - BUS (16+ SEATS, INC DRIVER) NON-MOTORIST 23 - ANIMAL WITH RIDER 24 - ANIMAL WITH BUGGY, WAGON, SURREY 25 - BICYCLE/PEDALCYCLIST 26 - PEDESTRIAN/SKATER 27 - OTHER NON-MOTORIST |
| | | | <input type="checkbox"/> HAS HM PLACARD | | |

| | | | | | |
|--|---|---|--|---|--|
| SPECIAL FUNCTION 01 01 - NONE 02 - TAXI 03 - RENTAL TRUCK (OVER 10K LBS) 04 - BUS - SCHOOL (PUBLIC OR PRIVATE) 05 - BUS - TRANSIT 06 - BUS - CHARTER 07 - BUS - SHUTTLE 08 - BUS - OTHER | 09 - AMBULANCE 10 - FIRE 11 - HIGHWAY/MAINTENANCE 12 - MILITARY 13 - POLICE 14 - PUBLIC UTILITY 15 - OTHER GOVERNMENT 16 - CONSTRUCTION EQUIP. | 17 - FARM VEHICLE 18 - FARM EQUIPMENT 19 - MOTORHOME 20 - GOLF CART 21 - TRAIN 22 - OTHER (EXPLAIN IN NARRATIVE) | MOST DAMAGED AREA 07 01 - NONE 02 - CENTER FRONT 03 - RIGHT FRONT 04 - RIGHT SIDE 05 - RIGHT REAR 06 - REAR CENTER 07 - LEFT REAR | 08 - LEFT SIDE 09 - LEFT FRONT 10 - TOP AND WINDOWS 11 - UNDERCARRIAGE 12 - LOAD/TRAILER 13 - TOTAL(ALL AREAS) 14 - OTHER | ACTION 4 1 - NON-CONTACT 2 - NON-COLLISION 3 - STRIKING 4 - STRUCK 5 - STRIKING/STRUCK 9 - UNKNOWN |
|--|---|---|--|---|--|

| | | | | |
|--|--|---|--|--|
| PRE-CRASH ACTIONS 10 99 - UNKNOWN | MOTORIST 01 - STRAIGHT AHEAD 02 - BACKING 03 - CHANGING LANES 04 - OVERTAKING/PASSING 05 - MAKING RIGHT TURN 06 - MAKING LEFT TURN | 07 - MAKING U-TURN 08 - ENTERING TRAFFIC LANE 09 - LEAVING TRAFFIC LANE 10 - PARKED 11 - SLOWING OR STOPPED IN TRAFFIC 12 - DRIVERLESS | 13 - NEGOTIATING A CURVE 14 - OTHER MOTORIST ACTION | NON-MOTORIST 15 - ENTERING OR CROSSING SPECIFIED LOCATION 16 - WALKING, RUNNING, JOGGING, PLAYING, CYCLING 17 - WORKING 18 - PUSHING VEHICLE 19 - APPROACHING OR LEAVING VEHICLE 20 - STANDING 21 - OTHER NON-MOTORIST ACTION |
|--|--|---|--|--|

| | |
|--|--|
| CONTRIBUTING CIRCUMSTANCES | VEHICLE DEFECTS |
| PRIMARY 01 01 - NONE 02 - FAILURE TO YIELD 03 - RAN RED LIGHT 04 - RAN STOP SIGN | 01 01 - TURN SIGNALS 02 - HEAD LAMPS 03 - TAIL LAMPS 04 - BRAKES 05 - STEERING 06 - TIRE BLOWOUT 07 - WORN OR SLICK TIRES 08 - TRAILER EQUIPMENT DEFECTIVE 09 - MOTOR TROUBLE 10 - DISABLED FROM PRIOR ACCIDENT 11 - OTHER DEFECTS |
| SECONDARY 01 99 - UNKNOWN | NON-MOTORIST 22 - NONE 23 - IMPROPER CROSSING 24 - DARTING 25 - LYING AND/OR ILLEGALLY IN ROADWAY 26 - FAILURE TO YIELD RIGHT OF WAY 27 - NOT VISIBLE (DARK CLOTHING) 28 - INATTENTIVE 29 - FAILURE TO OBEY TRAFFIC SIGNS /SIGNALS/OFFICER 30 - WRONG SIDE OF THE ROAD 31 - OTHER NON-MOTORIST ACTION |
| 05 - EXCEEDED SPEED LIMIT 06 - UNSAFE SPEED 07 - IMPROPER TURN 08 - LEFT OF CENTER 09 - FOLLOWED TOO CLOSELY/ACDA 10 - IMPROPER LANE CHANGE /PASSING/OFF ROAD | 11 - IMPROPER BACKING 12 - IMPROPER START FROM PARKED POSITION 13 - STOPPED OR PARKED ILLEGALLY 14 - OPERATING VEHICLE IN NEGLIGENT MANNER 15 - SWERVING TO AVOID (DUE TO EXTERNAL CONDITIONS) 16 - WRONG SIDE/WRONG WAY 17 - FAILURE TO CONTROL 18 - VISION OBSTRUCTION 19 - OPERATING DEFECTIVE EQUIPMENT 20 - LOAD SHIFTING/FALLING/SPILLING 21 - OTHER IMPROPER ACTION |

| | | | |
|---|---|--|---|
| SEQUENCE OF EVENTS 1 10 2 01 3 01 4 01 5 01 6 01 FIRST HARMFUL EVENT MOST HARMFUL EVENT 99 - UNKNOWN | NON-COLLISION EVENTS 01 - OVERTURN/ROLLOVER 02 - FIRE/EXPLOSION 03 - IMMERSION 04 - JACKKNIFE 05 - CARGO/EQUIPMENT LOSS OR SHIFT | 06 - EQUIPMENT FAILURE (BLOWN TIRE, BRAKE FAILURE, ETC) 07 - SEPARATION OF UNITS 08 - RAN OFF ROAD RIGHT 09 - RAN OFF ROAD LEFT | 10 - CROSS MEDIAN 11 - CROSS CENTER LINE OPPOSITE DIRECTION OF TRAVEL 12 - DOWNHILL RUNAWAY 13 - OTHER NON-COLLISION |
|---|---|--|---|

| | | | | | |
|--|---|--|--|--|--|
| COLLISION WITH PERSON, VEHICLE OR OBJECT NOT FIXED 14 - PEDESTRIAN 15 - PEDALCYCLE 16 - RAILWAY VEHICLE (TRAIN, ENGINE) 17 - ANIMAL - FARM 18 - ANIMAL - DEER 19 - ANIMAL - OTHER 20 - MOTOR VEHICLE IN TRANSPORT | 21 - PARKED MOTOR VEHICLE 22 - WORK ZONE MAINTENANCE EQUIPMENT 23 - STRUCK BY FALLING, SHIFTING CARGO OR ANYTHING SET IN MOTION BY A MOTOR VEHICLE 24 - OTHER MOVABLE OBJECT | COLLISION WITH FIXED OBJECT 25 - IMPACT ATTENUATOR/CRASH CUSHION 26 - BRIDGE OVERHEAD STRUCTURE 27 - BRIDGE PIER OR ABUTMENT 28 - BRIDGE PARAPET 29 - BRIDGE RAIL 30 - GUARDRAIL FACE 31 - GUARDRAIL END 32 - PORTABLE BARRIER | 33 - MEDIAN CABLE BARRIER 34 - MEDIAN GUARDRAIL BARRIER 35 - MEDIAN CONCRETE BARRIER 36 - MEDIAN OTHER BARRIER 37 - TRAFFIC SIGN POST 38 - OVERHEAD SIGN POST 39 - LIGHT/LUMINARIES SUPPORT 40 - UTILITY POLE | 41 - OTHER POST, POLE OR SUPPORT 42 - CULVERT 43 - CURB 44 - DITCH 45 - EMBANKMENT 46 - FENCE 47 - MAILBOX | 48 - TREE 49 - FIRE HYDRANT 50 - WORK ZONE MAINTENANCE EQUIPMENT 51 - WALL, BUILDING, TUNNEL 52 - OTHER FIXED OBJECT |
|--|---|--|--|--|--|

| | | | | | | | |
|--|---------------------------|---|--|---|---|--|-------------|
| UNIT SPEED 10 <input type="checkbox"/> STATED <input type="checkbox"/> ESTIMATED | POSTED SPEED 10 | TRAFFIC CONTROL 12 01 - NO CONTROLS 02 - STOP SIGN 03 - YIELD SIGN 04 - TRAFFIC SIGNAL 05 - TRAFFIC FLASHERS 06 - SCHOOL ZONE | 07 - RAILROAD CROSSBUCKS 08 - RAILROAD FLASHERS 09 - RAILROAD GATES 10 - CONSTRUCTION BARRICADE 11 - PERSON (FLAGGER, OFFICER) 12 - PAVEMENT MARKINGS | 13 - CROSSWALK LINES 14 - WALK/DON'T WALK 15 - OTHER 16 - NOT REPORTED | UNIT DIRECTION FROM 1 TO 2 1 - NORTH 2 - SOUTH 3 - EAST 4 - WEST | 5 - NORTHEAST 6 - NORTHWEST 7 - SOUTHEAST 8 - SOUTHWEST | 9 - UNKNOWN |
|--|---------------------------|---|--|---|---|--|-------------|

| | | |
|--|---|--|
| LOCAL REPORT NUMBER <i>16-44687</i> | REPORTING AGENCY <i>MASON POLICE</i> | DATE OF CRASH <i>M 12 10 18 116</i> |
| IN COUNTY OF <i>WARREN</i> | CRASH LOCATION <i>729 READING RD</i> | |

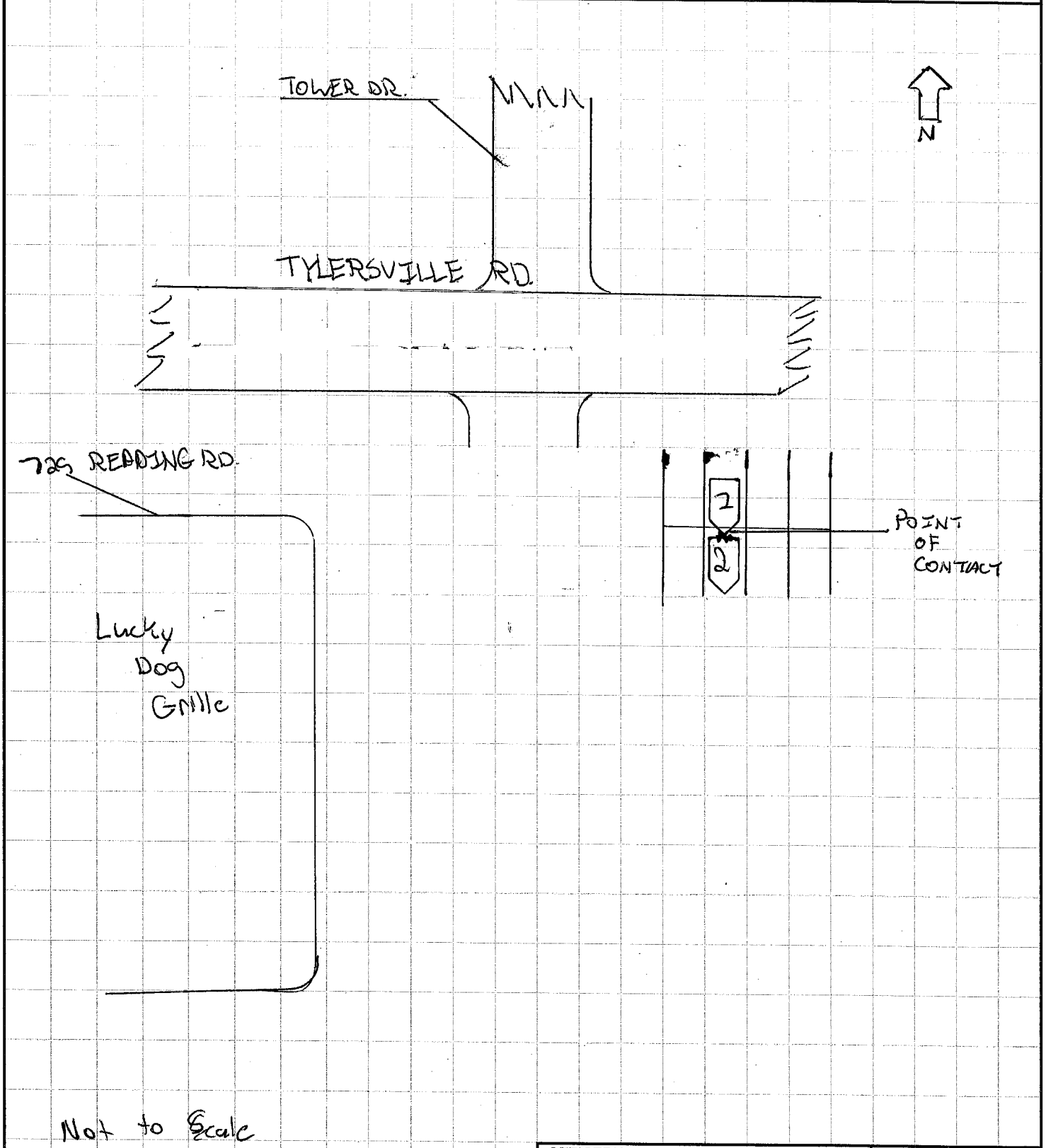

| | |
|---|---------------------------|
| OFFICER'S SIGNATURE <i>X [Signature]</i> | BADGE NUMBER <i>31</i> |
|---|---------------------------|